

# SERVICE BULLETIN

**TITLE:** Service and miscellaneous - New compensator rod for battery door and/or electrical compartment door

**SB Type:** Product improvement

## APPLICABILITY

Model:	AS365
Version:	F, Fi, K, K2, N1, N2, N3
Helicopters PRE MOD:	0752C81

## COMPLIANCE: OPTIONAL

At customer's option.

## SUMMARY

The purpose of this Service Bulletin is to replace the compensator rod.

## GENERAL EVALUATION

Evaluation table			
Perform once	YES	Accomplish recurring	NO

Export Control:

US Export Control - No US content. This Item does not contain any U.S. origin ITAR or EAR content.

FR Export Control - Not Listed. This Item is not listed against the EC regulations in the EU/FR.

### GENERAL ILLUSTRATION

LH SHOWN  
RH SYMMETRICAL

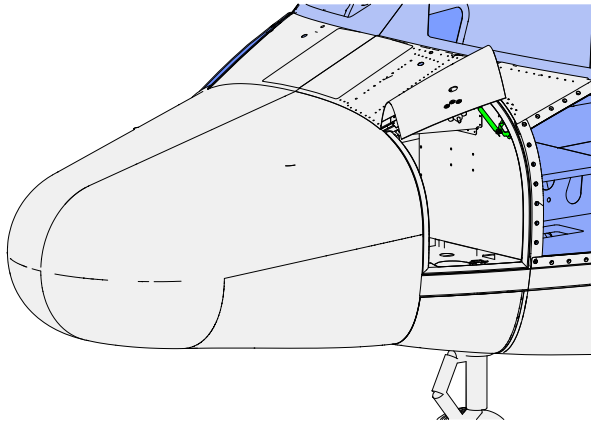

BEFORE MODIFICATION

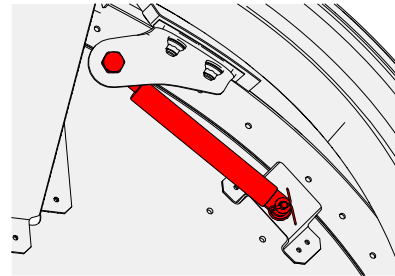

AFTER MODIFICATION

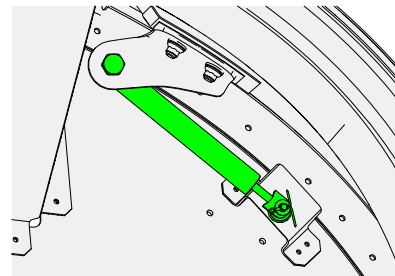

## PLANNING INFORMATION

### 1. REASON

The purpose of this Service Bulletin is to replace the compensator rod which is no longer supplied, with a new compensator rod.

The mounting orientation of the new compensator rod is changed to allow for better lubrication and performance.

Therefore, the connecting rod is installed with the connecting rod body up and the connecting rod down.

The technical data and instructions contained in this Service Bulletin refer to the modification 0752C81.

### 2. DESCRIPTION

The Service Bulletin provides instructions to:

- Remove the old compensator rod from the battery door and/or electrical compartment door
- Counter-drill the corner
- Install the new compensator rod.

### 3. CONFIGURATION DEFINITION

Not applicable.

### 4. CONCURRENT REQUIREMENTS

Not applicable.

### 5. APPROVAL

The technical content of this document is approved under the authority of the Design Organization Approval ref. EASA. 21J.700. For helicopters operated outside the terrain regulated by the EASA, the application of this document is subject to validation provided by the responsible aviation authority of the state of registry.

The technical content of this document is approved by Airbus Helicopters Airworthiness Department for export military versions.

The technical content of this document is approved under the prerogatives of the recognition of design capability ref. EMAR21J.015-DGA for French Government helicopters.

## 6. MANPOWER

### NOTE

The Purpose of Man Hours is to give Airbus Helicopters customers a guideline for maintenance scheduling. It is not a contractual information.

### 6.1. Manpower for procedure

Number of Persons	Qualification	Estimated Man Hours
1	Mechanical technician	2h

## 7. WEIGHT AND BALANCE

There is no change in weight and moment.

## 8. ELECTRICAL LOAD DATA

Not applicable.

## 9. DOCUMENTATION AFFECTED

- Illustrated Parts Catalog (IPC)
- Maintenance Manual (MET)
- The changes to Instructions for Continued Airworthiness (ICA) which are required as a result of this Service Bulletin will be incorporated in the next Normal Revision. Refer to DN.105.0034 until the information is available in the published technical documentation.

## 10. MATERIAL INFORMATION

### 10.1. Price

For information about the price of the modification kits and/or components, or for aid, contact the Airbus Helicopters Network Sales and Customer Relations Department.

#### 10.2. Availability

Contact the Sales and Customer Relations Department to know the delivery lead times.

#### 10.3. Procurement

Send an order for the necessary quantities to the Airbus Helicopters Network Sales. You can send an order for the consumables from the AirbusWorld Marketplace through e-ordering. If you cannot get access to e-ordering, please contact your Logistic Focal Point.

#### 10.4. Mixability

This Service Bulletin has no effect on the mixability.

#### 10.5. LIST OF NEW MATERIALS

Individual Spares List				
Item	Designation	Reference	MFC	QTY
1	COMPENSATOR ROD	IG6004-40052	F0210	1
2	SELF-LOCKING HEX NUT	ASN52320BH060N	F5442	2
3	SHOULDER PIN	365A61671120	F0210	2
4	FLAT WASHER	23111AG040LE	F0111	3
5	SPLIT PIN	23310CA015012	F0111	2

#### NOTE

This parts list is for one door only (left or right).

Consumables, Materials and Expendables			
Designation	Reference	MFC	QTY
None			

Special Tools				
Item	Designation	Reference	MFC	QTY
None				

#### 10.6. LIST OF EXISTING PARTS

REMOVED SPARE PARTS	
Old Reference	Designation
23111AG040LE	Flat washer
23310CA015012	Split pin
23310CA015015	Split pin
ASN52320BH060N	Self-locking hex nut
IG6004-40050	Compensator rod
0721330304060N	Compensator rod
365A61671120	Shoulder pin
22719BC040011L	Shoulder pin

#### 11. ACCOMPLISHMENT INSTRUCTION

Comply with the ACCOMPLISHMENT PROCEDURE [52-41-0001, 933](#)

#### 12. ADDITIONAL INFORMATION

Not applicable.

End of section

## ACCOMPLISHMENT PROCEDURE 52-41-0001, 933

### 1. APPLICABILITY

Model:	AS365
Version:	F, Fi, K, K2, N1, N2, N3
Helicopters PRE MOD:	0752C81

### 2. GENERAL INFORMATION

Acronym/Abbreviation List

FOD - Foreign Object Debris

### 3. PRELIMINARY REQUIREMENTS

#### 3.1. Applicable Documents

- Assembly by screws and nuts - Joining [MTC 20-02-05-404](#)
- Cleaning of mechanical parts - Cleaning [MTC 20-04-01-401](#)
- Handling of helicopters in a hangar and in a prepared area – Handling [MTC 20-07-01-201](#)
- Helicopter parked in a repair shop - Safety instructions [MTC 20-07-02-201](#)

#### 3.2. Set up

- Handling of helicopters in a hangar and in a prepared area – Handling [MTC 20-07-01-201](#)
- Helicopter parked in a repair shop - Safety instructions [MTC 20-07-02-201](#)
- Remove and/or open all applicable cowlings, panels, doors and other items of equipment to get access to the different work areas.

#### 3.3. Special Tools

None

#### 3.4. Consumables, Materials and Expendables

None

### 3.5. Spares

Designation	Reference	MFC	QTY
COMPENSATOR ROD	IG6004-40052	F0210	1
SELF-LOCKING HEX NUT	ASN52320BH060N	F5442	2
SHOULDER PIN	365A61671120	F0210	2
FLAT WASHER	23111AG040LE	F0111	3
SPLIT PIN	23310CA015012	F0111	2



### 3.6. Safety conditions



### NOTE

Only the procedure on the left side is described, for the helicopters affected by the right side the procedure is symmetrical.

## 4. PROCEDURE

### 4.1. Removal of the compensator rod

4.1.1. Remove and discard pins, self-locking nuts and flat washers from the compensator rod on both sides according to (Figure 1).

4.1.2. Remove the compensator rod according to (Figure 1).

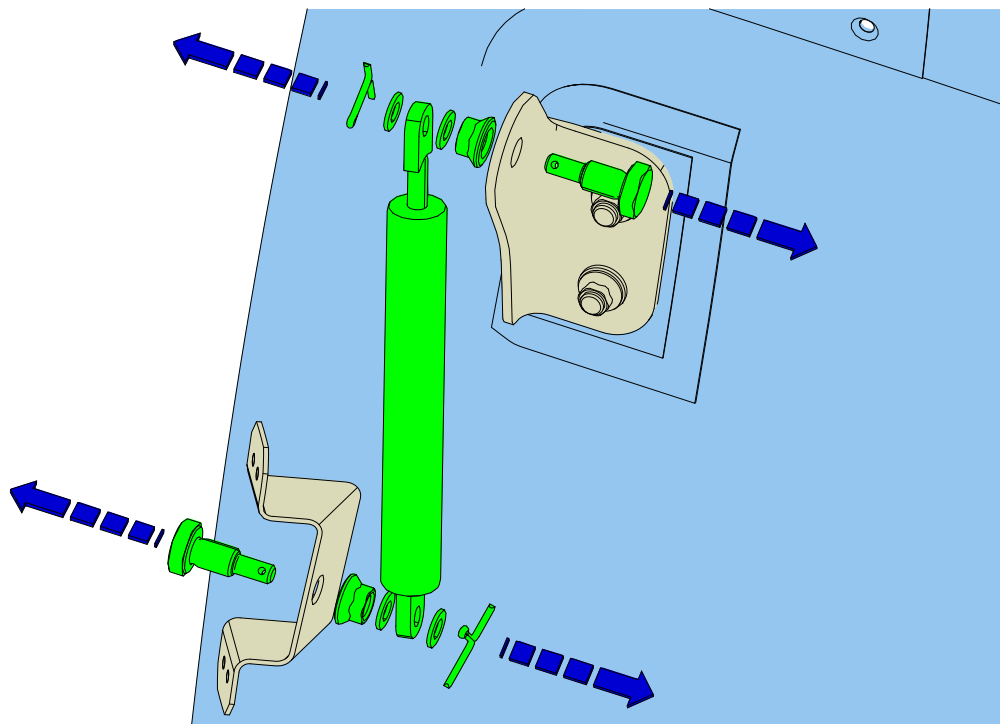
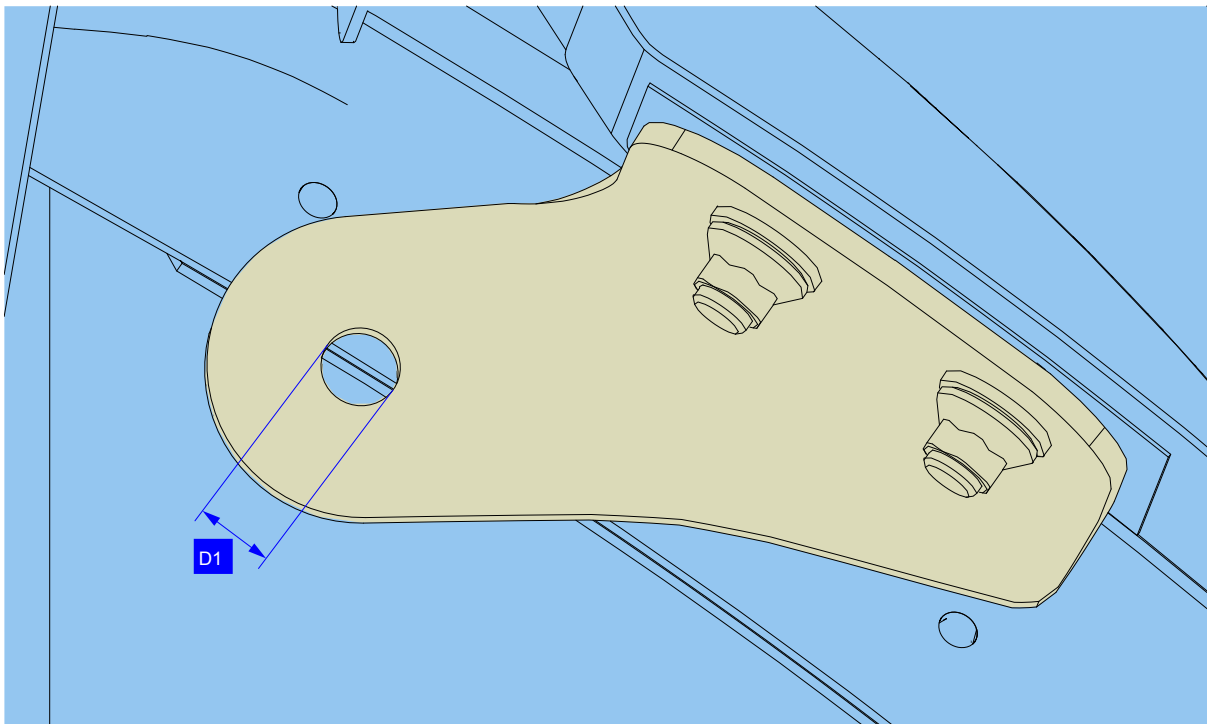

**Figure 1**

#### 4.2. Modification of the door corner if necessary

##### NOTE

Counter-drill the corner at diameter D1 = 6,2 mm according to [\(Figure 2\)](#).  
For touch-up after drilling, refer to [MTC 20-04-01-401](#).



**Figure 2**

#### 4.3. Installation of the compensator rod

##### NOTE

The connecting rod should be installed with the connecting rod body up (door side) and the connecting rod down (structure side).

- 4.3.1. Install on the door side (top in [Figure 3](#)):
- The SHOULDER PIN 365A61671120 (3)
  - The SELF-LOCKING HEX NUT ASN52320BH060N (2), dry tightening torque refer to [MTC 20-02-05-404](#)
  - The COMPENSATOR ROD IG6004-40052 (1)
  - The FLAT WASHER 23111AG040LE (4)
  - The SPLIT PIN 23310CA015012 (5).
- 4.3.2. Install on the structure side (bottom in [Figure 3](#)):
- The SHOULDER PIN 365A61671120 (3)
  - The SELF-LOCKING HEX NUT ASN52320BH060N (2), dry tightening torque refer to [MTC 20-02-05-404](#)
  - The COMPENSATOR ROD IG6004-40052 (1)
  - The two FLAT WASHER 23111AG040LE (4)
  - The SPLIT PIN 23310CA015012 (5).

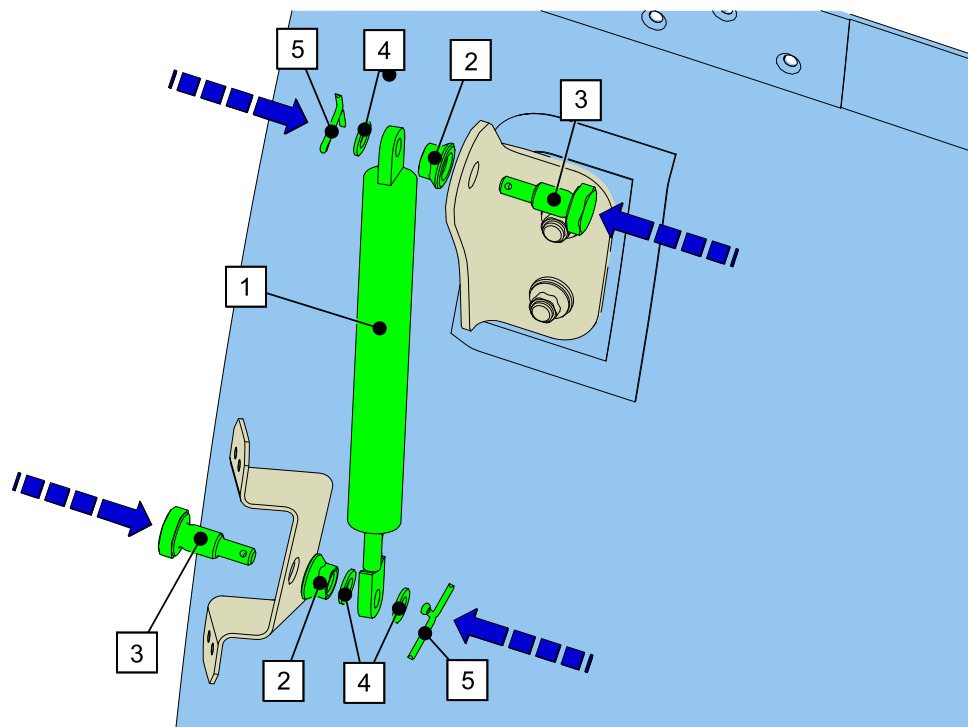

Figure 3

## 5. CLOSE UP

- 5.1. Remove all the tools, the materials and the equipment from your work area.
- 5.2. Record the full compliance with this Service Bulletin, with its issue number, in the helicopter documents and, if applicable, in the log card of the equipment or its next higher assembly.
- 5.3. Record the modification 0752C81 in the helicopter documents and if applicable, in the log card of the equipment or its next higher assembly.
- 5.4. Record compliance with this Service Bulletin (see IN 3785-I-00 for instructions):



[SB SA365-52-41-0001](#)

End of Service Bulletin