

 CT7-2E1 SERVICE BULLETIN - 74-0006 R00

Revised: 02/21  
/2024

**SB 74-0006 R00 ELECTRICAL SYSTEM (74-00-00) - SERVICE EVALUATION FOR IGNITER  
PLUG P/N 5044T67P14**

Issued: 02/21  
/2024

**GE Designated: -CONFIDENTIAL-**

The information contained in this document is GE proprietary information and is disclosed in confidence. It is the property of GE and shall not be used, disclosed to others or reproduced without the express written consent of GE, including, but without limitation, it is not to be used in the creation, manufacture, development, or derivation of any repairs, modifications, spare parts, designs, or configuration changes or to obtain FAA or any other government or regulatory approval to do so. If consent is given for reproduction in whole or in part, this notice and the notice set forth on each page of this document shall appear in any such reproduction in whole or part.

This technical data is considered subject to the Export Administration Regulations (EAR) pursuant to 15 CFR Parts 730-774. Transfer of this data by any means to a Non-U.S. Person, whether in the United States or abroad, without the proper U.S. Government authorization (e.g., License, exemption, NLR, etc.), is strictly prohibited.

Copyright (2024) General Electric Company, U.S.A.

1. PLANNING INFORMATION

A. Effectivity

CT7-2E1

This Service Bulletin is applicable to all CT7-2E1 engines.

Igniter plugs P/N [5044T67P14](#) are affected by this Service Bulletin.

B. Description

This Service Bulletin proposes a Service Evaluation to install and operate igniter plugs P/N [5044T67P14](#) in fielded CT7-2E1 engines for design assurance testing prior to adding the igniter plug to the production parts list.

C. Compliance

Category 7

GE recommends that you do this Service Bulletin at customer option.

Impact F

Implement as deemed necessary per the Service Bulletin Category.

NOTE: This Service Bulletin can be accomplished on-wing or in shop.

D. Concurrent Requirements

None.

E. Reason

(1) Objective:

To introduce new parts and to improve reliability.

(2) Condition:

The igniter plugs can wear resulting in no starts.

(3) Cause:

Not applicable.

(4) Improvement:

The proposed igniter plug P/N [5044T67P14](#) incorporates improved materials for increased durability.

(5) Substantiation:

Substantiation is by test.

F. Approval

The data contained in this Service Bulletin has been reviewed by the FAA or authorized entity representing the FAA and the repair(s) and modification(s) herein comply with the applicable Aviation Regulations and are APPROVED for installation in the model(s) listed in this Service Bulletin.

G. Manpower

No additional man-hours are required to comply with this Service Bulletin.

H. Weight and Balance

Weight and balance are not changed.

I. References (Use the latest version of these documents)

CT7-2 Turboshaft Engine Service Record

GEK 115715, CT7-2E Illustrated Parts Catalogue

GEK 112043-02, CT7-2E Maintenance Manual

CT7-2E1 Service Bulletin (S/B) [71-0000](#) - Power Plant - General (71-00-00) - Consolidated On-Wing Inspection Recommendations and Servicing Tasks List

J. Publications Affected

CT7-2 Turboshaft Engine Service Record

K. Interchangeability

Qualified interchangeability. See interchangeability statement in paragraph [2.C. Configuration Chart](#).

L. Software Accomplishment Summary

Not applicable.

2. MATERIAL INFORMATION

A. Material - Price and Availability

(1) Parts necessary to do this Service Bulletin:

Part Number	Qty/ Eng	Part Name	Unit (\$) Price	Pkg Qty	Lead Time Days
<a href="#">5044T67P07</a>	(1)	Plug, Igniter	Quote	(1)	Quote
<a href="#">5044T67P14</a>	(1)	Plug, Igniter	Quote	(1)	Quote

(2) Other Spare Parts:

None.

(3) Consumables:

None.

B. Industry Support Information

None.

C. Configuration Chart

New Part Number	Qty/ Eng	Part Name	Old Part Number/ IPC Location	Qty/ Eng	Op Code	Chg/Sprt Code
FOR CT7-2E1						
<a href="#">5130T68G01</a>	(X)	Cold Section Module SIN 00900	<a href="#">5130T68G01</a> <a href="#">01-160,72-00-00</a>	(X)	RM	-/-
<a href="#">. 5044T67P07</a>	(1)	Plug, Igniter SIN 0E000	<a href="#">. 5044T67P07</a> <a href="#">01-010,74-00-00</a>	(2)	QTC	4/D
<a href="#">. 5044T67P14</a>	(1)	Plug, Igniter SIN 0E000	--	(-)	AD	4/D

Operation Codes

AD = Add

RM = Remains

QTC = Quantity Change

Change Code

4 = Interchangeable as a set.

Support Code

D = Old parts will be supplied for engines that have not been changed by this Service Bulletin.

- (1) For the purposes of this Service Evaluation Bulletin, a 0 time P/N [5044T67P07](#) and a P/N [5044T67P14](#) igniter plug must be installed as a set and operated until each individual igniter plug fails inspection. Either the P/N [5044T67P07](#) or the P/N [5044T67P14](#) igniter plug may be replaced with a P/N [5044T67P07](#) igniter plug should an igniter plug fail inspection. Any igniter plug that has not failed inspection should continue to operate until it becomes unserviceable. Should an engine be removed from service, the igniter plugs listed in this Service Bulletin may be removed as a set and installed on another engine to remain in operation to conclude this Service Evaluation as expeditiously as possible.

D. Parts Disposition

Return removed P/N [5044T67P07](#) and P/N [5044T67P14](#) igniter plugs used in this Service Bulletin along with the latest copy of the Igniter Plug Service Evaluation Tracking Log to:

GE Aerospace  
1000 Western Avenue  
Lynn, MA 01910  
Attention: Product Support Engineering  
Mail Zone 3-74-02

E. Tooling - Price and Availability

No special tooling required.

3. ACCOMPLISHMENT INSTRUCTIONS

A. General

- (1) Remove both igniter plugs ([figure 1](#)). Refer to CT7-2E Maintenance Manual, GEK 112043-02, 74-00-00, REMOVAL AND INSTALLATION, TASK 74-00-00-400-801, paragraph entitled Igniter Plugs.
- (2) Install one P/N [5044T67P07](#) and one P/N [5044T67P14](#) igniter plug on only one engine per aircraft. Refer to CT7-2E Maintenance Manual, GEK 112043-02, 74-00-00, REMOVAL AND INSTALLATION, TASK 74-00-00-400-801, paragraph entitled Igniter Plugs.

NOTE: Igniter plugs are installed at approximately 4:00 and 8:00 aft looking forward on the engine. It does not matter which igniter is installed in which port, but GE would like to track the port location of the installation in the Igniter Plug Service Evaluation Tracking Log.

- (3) Record the installation of the igniter plugs on the attached Igniter Plug Service Evaluation Tracking Log ([figure 2](#)) and place in the engine maintenance record.

NOTE: An example of a properly filled out Igniter Plug Service Evaluation Tracking Log is provided in [figure 3](#). For questions, contact your local GE Field Service Representative.

NOTE: To avoid dual igniter maintenance, at the operator's discretion, the installation and inspection intervals can be staggered but must be completed within 10 hours of the 0-time installation or scheduled inspection.

- (4) At the next scheduled 200-hour level igniter plug inspection in CT7-2E1 S/B [71-0000](#), Table 2, and every 100 hours thereafter until both igniter plugs have failed inspection, do the following:
- (a) Remove both igniter plugs ([figure 1](#)). Refer to CT7-2E Maintenance Manual, GEK 112043-02, 74-00-00, REMOVAL AND INSTALLATION, TASK 74-00-00-400-801, paragraph entitled Igniter Plugs.
- (b) Clean the igniter plugs. Refer to CT7-2E Maintenance Manual, GEK 112043-02, 74-00-00, CLEANING, TASK 74-00-00-100-801, paragraph entitled Igniter Plugs.
- (c) Inspect the igniter plugs. Refer to CT7-2E Maintenance Manual, GEK 112043-02, 74-00-00, INSPECTION, TASK 74-00-00-200-801, paragraph entitled Igniter Plugs.
- (d) If the igniter plug fails inspection, replace the igniter plug with a serviceable P/N [5044T67P07](#) igniter plug. Refer to CT7-2E Maintenance Manual, GEK 112043-02, 74-00-00, REMOVAL AND INSTALLATION, TASK 74-00-00-400-801, paragraph entitled Igniter Plugs.
- (e) If the igniter plug passes inspection, reinstall the igniter plug. Refer to CT7-2E Maintenance Manual, GEK 112043-02, 74-00-00, REMOVAL AND INSTALLATION, TASK 74-00-00-400-801, paragraph entitled Igniter Plugs.

NOTE: An example of a properly filled out Igniter Plug Service Evaluation Tracking Log is provided in [figure 3](#). For questions, contact your local GE Field Service Representative.

- (f) Log the results of the inspection in the Igniter Plug Service Evaluation Tracking Log ([figure 2](#)).
- (g) Return any removed igniter plugs along with the latest copy of the Igniter Plug Service Evaluation Tracking Log to the address in paragraph [2.D., Parts Disposition](#).
- (5) Should an engine be removed from service, the igniter plugs listed in this Service Bulletin may be removed as a set and installed on another engine to remain in operation to conclude this Service Evaluation as expeditiously as possible following the steps in paragraph 3.A.4.
- (6) This Service Evaluation Bulletin is concluded when both 0 time igniter plugs have been removed from the

engine and replaced with P/N [5044T67P07](#) igniter plugs. When new P/N [5044T67P07](#) igniter plugs are installed, the inspection interval contained within CT7-2E1 S/B [71-0000](#), Table 2, resumes.

B. Service Record Entry

Record compliance with this Service Bulletin in the appropriate CT7-2 Turboshift Engine Service Record.

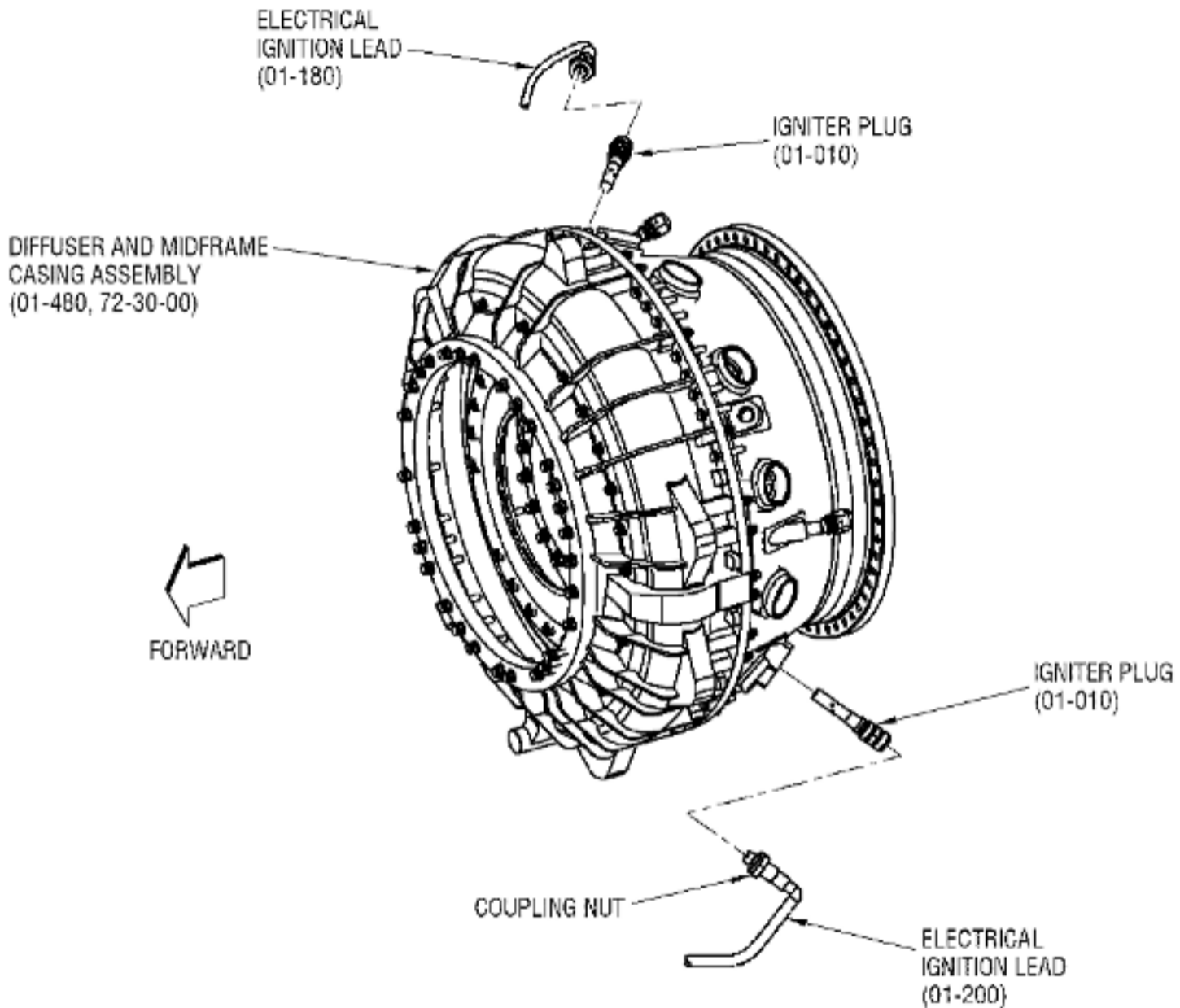

**NOTE:**  
ALL IPC REFERENCES ARE FROM 74-00-00  
UNLESS SPECIFIED DIFFERENTLY.

6044852-00

Igniter Plug - Removal and Installation  
Figure 1 (Sheet 1)

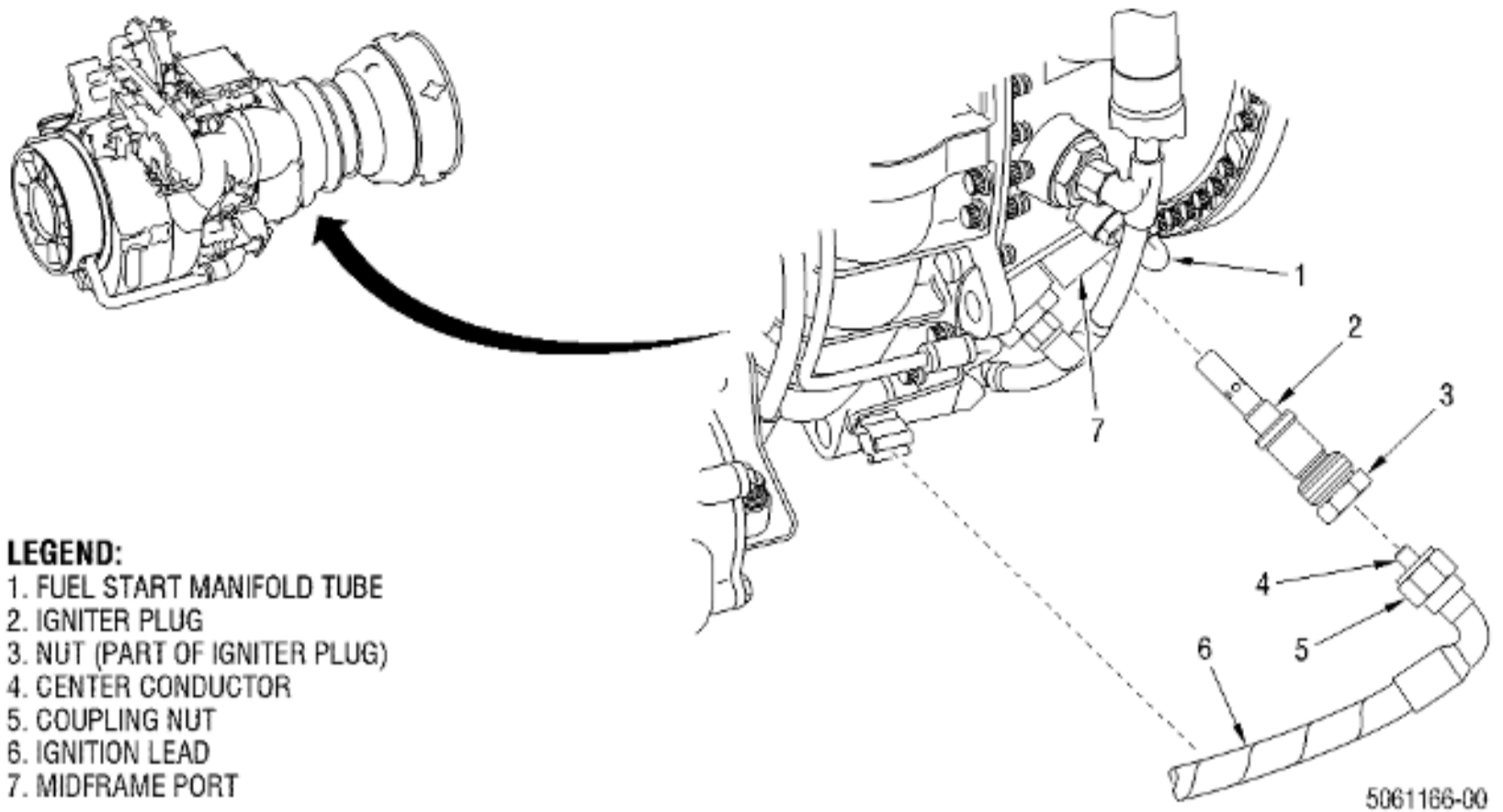

Igniter Plug - Removal and Installation  
Figure 1 (Sheet 2)

IGNITER PLUG SERVICE EVALUATION TRACKING LOG														
Install or Removal	Date	Engine Serial Number	Igniter Plug Part Number	Igniter Plug Serial Number	Position Alt. Locking Forward (4:30 or 8:00)	Igniter Plug Installation Engine Time Since User (Hrs)	200 hr Inspection (Pass or Fail)	300 hr Inspection (Pass or Fail)	400 hr Inspection (Pass or Fail)	500 hr Inspection (Pass or Fail)	600 hr Inspection (Pass or Fail)	700 hr Inspection (Pass or Fail)	800 hr Inspection (Pass or Fail)	1000 hr Inspection (Pass or Fail)
Install		700120	5044T67P07											
Removal														
Install			5044T67P07											
Removal														
Install														
Removal														
Install														
Removal														
Install		700120	5044T67P14											
Removal														
Install			5044T67P14											
Removal														
Install														
Removal														

NOTE: If igniter plug fails prior to any 200 or 1000 hour inspection interval, document the engine TSM in the appropriate "Removal" block.

6044856-00

Igniter Plug Service Evaluation Tracking Log  
Figure 2

IGNITER PLUG SERVICE EVALUATION TRACKING LOG														
Install or Removal	Date	Engine Serial Number	Igniter Plug Part Number	Igniter Plug Serial Number	Position Air Locking Forward (4.00 or 8.00)	Number Plug Installation Engine Time Since New (Hrs)	210 hr Inspection (Pass or Fail)	300 hr Inspection (Pass or Fail)	400 hr Inspection (Pass or Fail)	500 hr Inspection (Pass or Fail)	600 hr Inspection (Pass or Fail)	700 hr Inspection (Pass or Fail)	800 hr Inspection (Pass or Fail)	1000 hr Inspection (Pass or Fail)
Install	30-Jun-20	780 23	5044T67P07	ABCD1234	4:00	4502	Pass	Pass	Unscheduled	Engine	Removal			
Removal	16-Dec-23					4870								
Install	17-Dec-23	780 24	5044T67P07	ABCD1234	8:00	2305	N/A	Pass	Pass	Fail				
Removal	8-Mar-24					2405								
Install	4-Mar-20	780 25	5044T67P07	ABCD06780	8:00	2405	N/A	N/A	N/A	Pass				
Removal														
Install														
Removal														
Install	30-Jun-25	780 23	5044T67P14	JUL01234	8:00	4502	Pass	Pass	Unscheduled	Engine	Removal			
Removal	16-Dec-23					4870								
Install	17-Dec-23	780 24	5044T67P14	JUL01234	4:00	2305	N/A	Pass	Pass	Pass				
Removal	6-Jul-24					2705								
Install	7-Jul-24	780 25	5044T67P14	ABCD04242	4:00	2705	N/A	N/A	N/A	N/A				
Removal														
Install														
Removal														

NOTE: Igniter plug fails prior to 700 or 1000 hr inspection interval, reinsert the engine TSO in the appropriate "annual" block.

6044859-00

Example of Properly Filled Out Igniter Plug Service Evaluation Tracking Log with an Engine Change and Igniters Removed at Different Intervals

Figure 3

GE Designated: - CONFIDENTIAL Subject to the restrictions on the media