



CT7-2E TEMPORARY REVISION - 05-0016

Dated: 08/11/2021

MM 05-11-05, SERVICE LIFE LIMITS 004

PARTICLE SEPARATOR BLOWER PARTS - SERVICE LIFE LIMITS

**SUBJECT:** PARTICLE SEPARATOR BLOWER PARTS - SERVICE LIFE LIMITS  
**REASON:** This Temporary Revision (TR) adds the data from TR 05-0016 which changes the life-tracked nomenclature and part number from Mixed Flow Impeller P/N 730740 to Inlet Particle Separator Blower P/N 6034T62P18.  
**FILING INSTRUCTIONS:** Put this TR in the CT7-2E Manual, GEK 112043-02, replacing 05-11-05, SERVICE LIFE LIMITS 004, dated May 31/2017. Record this TR in the Record of Temporary Revisions. Update your media via the GE Aviation Web portal.

**GE Designated: -CONFIDENTIAL-**

The information contained in this document is GE proprietary information and is disclosed in confidence. It is the property of GE and shall not be used, disclosed to others or reproduced without the express written consent of GE, including, but without limitation, it is not to be used in the creation, manufacture, development, or derivation of any repairs, modifications, spare parts, designs, or configuration changes or to obtain FAA or any other government or regulatory approval to do so. If consent is given for reproduction in whole or in part, this notice and the notice set forth on each page of this document shall appear in any such reproduction in whole or part.

This technical data is considered subject to the Export Administration Regulations (EAR) pursuant to 15 CFR Parts 730-774. Transfer of this data by any means to a Non-U.S. Person, whether in the United States or abroad, without the proper U.S. Government authorization (e.g., License, exemption, NLR, etc.), is strictly prohibited.

Copyright (2021) General Electric Company, U.S.A.

**\* \* \* FOR CT7-2E1**

TASK 05-11-05-200-807

1. General Information.

This section contains the FAA approved service life limits for the particle separator blower parts. The service life limit is determined by the total number of flight cycles. Refer to 5-11-00, SERVICE LIFE LIMITS 004, paragraph 2, for the definition and calculation of cycle count. The operator is responsible to be sure that the cycle-limited parts are not used beyond their cycle limit.

2. Service Life Limits for Particle Separator Blower Parts.

Refer to Figure 1.

These life limits have been established assuming CT7-2E1 mission profiles representative of an AW189 Helicopter Application and an aircraft transmission limit of 355.5 lb-ft for All Engine Operation.

Figure Item Number	Nomenclature	Part Number	Life Limits (Cycles Since New)
1	Inlet Particle Separator Blower	6034T62P18	3,300

**\* \* \* FOR CT7-2E1**

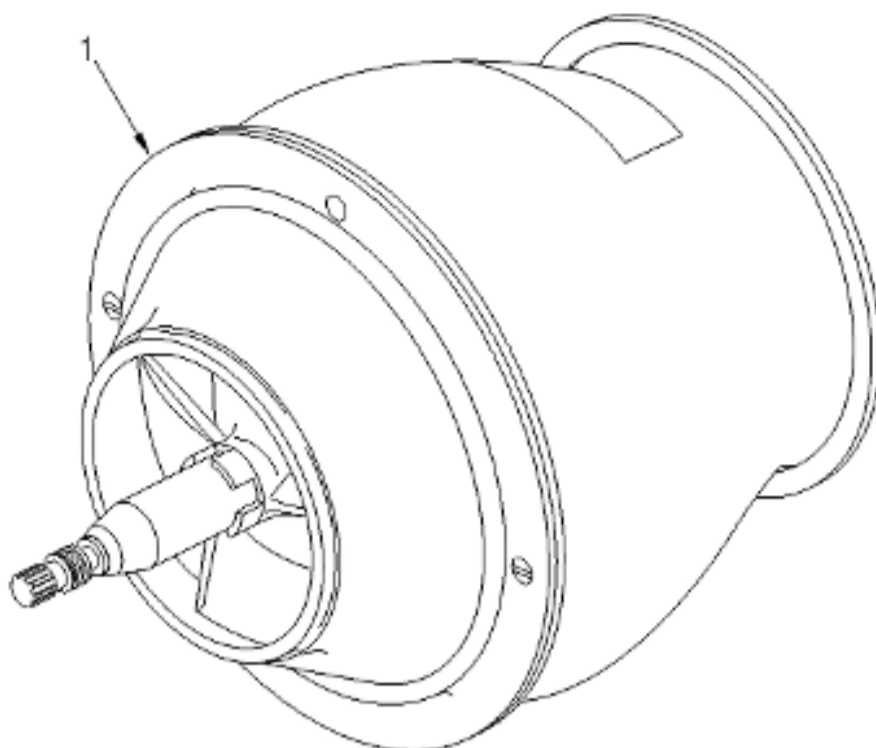

PARTICLE SEPARATOR BLOWER

6020843-00

Figure 1 Particle Separator Blower Parts - Service Life Limits

GE Designated: - CONFIDENTIAL Subject to the restrictions on the media