



TECHNICAL INFORMATION LETTER

TIL N° T-139-22-007

DATE: August 05, 2022

REV.: /

To: Leonardo Helicopters products
AW139 Owners / Operators / Service Centres

SUBJECT: Tail Rotor Sliding Control Assy install and remove procedures

Helicopters Affected: AB/AW139

References:

- [1] AMP DM 39-A-64-31-04-00A-720A-A Sliding control assembly - Install procedure
- [2] AMP DM 39-A-64-31-04-00A-520A-A Sliding control assembly - Remove procedure

Dear Customer,

With the present letter, Leonardo Helicopters (LH) would like to provide information about the Temporary Maintenance Instruction (TMI) TMI139-560 that is going to be issued, following request for clarification received by some operators, in order to clarify the Tail Rotor Sliding Control Assembly installation and removal procedures included in the IETP Aircraft Maintenance Publication (AMP), Reference [1] and [2].

In particular, Reference [1] and [2] provide the necessary instructions to perform respectively the installation and the removal of the Tail Rotor Sliding Control Assembly (item (1) of Figure 1, Annex A) by acting on the Special Nut (item (3)) and the Control Rod of the Tail Rotor Actuator (item (2)).

TMI139-560 will be issued in order to:

- Highlight the importance to follow the instructions requiring to lock the Control Rod (2) to prevent it to turn during the installation/removal of Special Nut (3), introducing a dedicated Caution.
 - Recommend that the installation/removal of the Special Nut (3) on/from the Control Rod (2) is performed by two persons (one locking the Control Rod (2) and one installing/removing the Special Nut (3) to prevent the Control Rod (2) to turn).
 - Verify that no turning of the Control Rod (2) occurred during the installation of the Special Nut (3).
-
-

Tail Rotor Sliding Control Assy install and remove procedures

Should you need any additional information, please do not hesitate to refer to LH Engineering Support team (engineering.support.lhd@leonardo.com).

Yours Sincerely,



Gabriele Bordino
Head of Product Support Engineering

Annex A

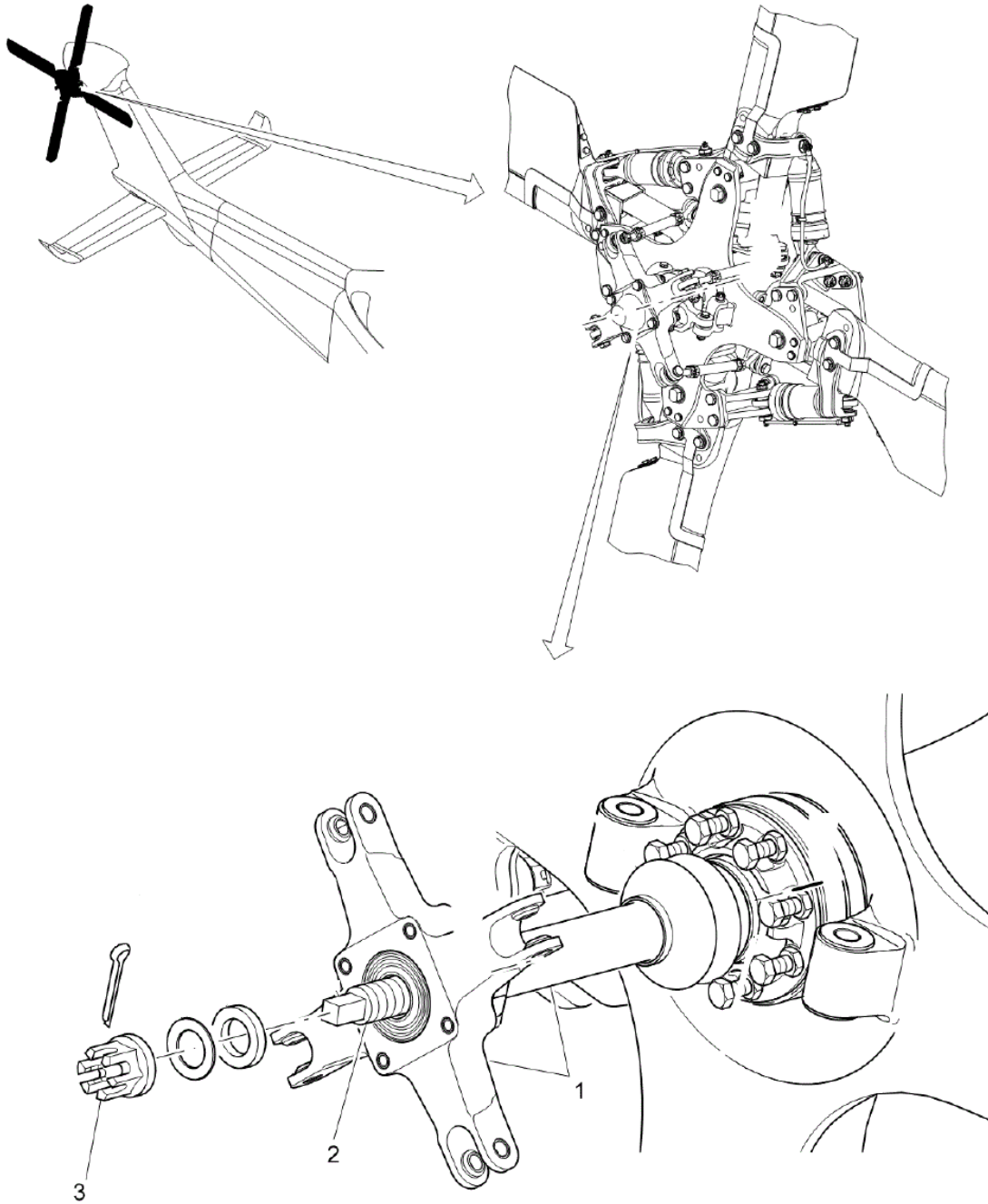

Figure 1 – Sliding Control Assy installation