 CT7-2E1 SERVICE BULLETIN - 72-0030 R01

Revised:
04/28/2023

SB 72-0030 R01 ENGINE - COLD SECTION MODULE (72-30-00) - RELEASE OF
REDESIGNED COMPRESSOR CASE P/N 5168T76G05

Issued:
10/18/2022

GE Designated: -CONFIDENTIAL-

The information contained in this document is GE proprietary information and is disclosed in confidence. It is the property of GE and shall not be used, disclosed to others or reproduced without the express written consent of GE, including, but without limitation, it is not to be used in the creation, manufacture, development, or derivation of any repairs, modifications, spare parts, designs, or configuration changes or to obtain FAA or any other government or regulatory approval to do so. If consent is given for reproduction in whole or in part, this notice and the notice set forth on each page of this document shall appear in any such reproduction in whole or part.

This technical data is considered subject to the Export Administration Regulations (EAR) pursuant to 15 CFR Parts 730-774. Transfer of this data by any means to a Non-U.S. Person, whether in the United States or abroad, without the proper U.S. Government authorization (e.g., License, exemption, NLR, etc.), is strictly prohibited.

Copyright (2023) General Electric Company, U.S.A.

TRANSMITTAL INFORMATION

REVISION 1 TO SERVICE BULLETIN 72-0030

Revision 1 is issued to update the Configuration Chart in paragraph 2.C. to allow for procurement of compressor stator assembly P/N 6039T60G28.

The original was issued October 18, 2022. Revision bars in the left margin identify changes.

1. PLANNING INFORMATION

A. Effectivity

* * * * * CT7-2E1

This Service Bulletin is applicable to these CT7-2E1 engines:

*CT7-2E1 engines, serial numbers 780245 and below.

This Service Bulletin has been introduced in production to these CT7-2E1 engines:

*CT7-2E1 engines, serial numbers 780246 and up.

These serial numbers are the best available data.

The cold section module P/N 5130T68G01 is affected by this Service Bulletin.

B. Description

This Service Bulletin introduces compressor stator assembly P/N 6039T60G28 with a redesigned compressor case.

C. Compliance

Category 7

GE recommends that you do this Service Bulletin at customer convenience/option. Impact E

This recommendation is to improve the cost of ownership, reduce maintenance requirements or is a product improvement.

NOTE: This Service Bulletin can be done in shop.

D. Concurrent Requirements

None.

E. Reason

(1) Objective:

To replace the current compressor stator assembly P/N 6039T60G27 with a new compressor stator assembly P/N 6039T60G28 which uses redesigned compressor case P/N 5168T76G05 with improved life.

- (2) Condition:
Due to the geometry of the current compressor case split-line flange counterbores, component life is low.
- (3) Cause:
Compressor case P/N 5168T76G04 was certified with a life below the program requirement.
- (4) Improvement:
Updated cold section module with a new compressor stator assembly P/N 6039T60G28 assures that compressor case life will be improved.
- (5) Substantiation:
Substantiation is by analysis.

F. Approval

The data contained in this Service Bulletin has been reviewed by the FAA or authorized entity representing the FAA and the repair(s) and modification(s) herein comply with the applicable Aviation Regulations and are APPROVED for installation in the model(s) listed in this Service Bulletin.

G. Manpower

No additional man-hours are required to comply with this Service Bulletin.

H. Weight and Balance

Weight and balance are not changed.

I. References (Use the latest version of these documents)

- CT7 Turboshaft Engine Service Record
- GEK 112044-02, CT7-2E Shop Manual (SM)
- GEK 115715, CT7-2E Illustrated Parts Catalog (IPC)

**NOTE: The reference documents listed below are for the engine manufacturer's internal use only:
CID: 526082, 526082-1**

J. Publications Affected

- GEK 115715, CT7-2E Illustrated Parts Catalog (IPC)

K. Interchangeability

One-way interchangeable.
The old part number can be used as a replacement only where the old part number was installed. The new part number is an acceptable replacement for either the old or new part number.

L. Software Accomplishment Summary

Not applicable.

2. MATERIAL INFORMATION

A. Material - Price and Availability

- (1) Parts necessary to do this Service Bulletin:

| Part Number | Qty/ Eng | Part Name | Unit (\$) | Price | Pkg Qty | Lead Time Days |
|-------------|----------|------------------|-----------|-------|---------|----------------|
| 5168T76G05 | (1) | Case, Compressor | Quote | | (-) | Quote |

- (2) Other Spare Parts:
None.

- (3) Consumables:
None.

B. Industry Support Information

None.

C. Configuration Chart

| New Part Number | Qty/ Eng | Part Name | Old Part Number/ IPC Location | Qty/ Eng | Op Code | Chg/ Sprt Code |
|-----------------|----------|--------------------------------------|--|----------|---------|----------------|
| 5130T67G01 | (X) | Engine Assembly, CT7-2E1 (SIN 00100) | 5130T67G01 01-001,72-00-00 | (X) | RM | -/- |
| .5130T68G01 | (X) | Cold Section Module (SIN 00900) | .5130T68G01 01-160,72-00-00 01-001,72-30-00 | (X) | RM | -/- |
| ..6039T60G28 | (1) | Stator Assy, Compressor (SIN 07000) | ..6039T60G27 01-380,72-30-00 01-001,72-36-00 | (1) | RE/RW | 1/B |
| ...5168T76G05 | (1) | Case, Compressor | ...5168T76G04 01-010,72-36-00 | (1) | RE | 1/B |
|5168T76P09 | (NP) | Case Half, RH |5168T76P07 01-080,72-36-00 | (NP) | RE | 1/A |
|5168T76P10 | (NP) | Case Half, LH |5168T76P08 01-090,72-36-00 | (NP) | RE | 1/A |

Operation Codes

RE = Replace

RM = Remains

RW = Rework

Change Code

1 = One-way interchangeable.

Support Code

A = Old parts will no longer be supplied.

B = Old parts will be supplied until all old parts are sold.

D. Parts Disposition

None.

E. Tooling - Price and Availability

None.

3. ACCOMPLISHMENT INSTRUCTIONS

A. Removal and Installation

Removal and installation procedures for the compressor case have not changed. Refer to CT7-2E SM, GEK 112044-02, 72-36-00, DISASSEMBLY, TASK 72-36-00-030-801 and 72-36-00, ASSEMBLY, TASK 72-36-00-430-801.

B. Service Record Entry

Record compliance with this Service Bulletin in the appropriate CT7 Turboshaft Engine Service Record.

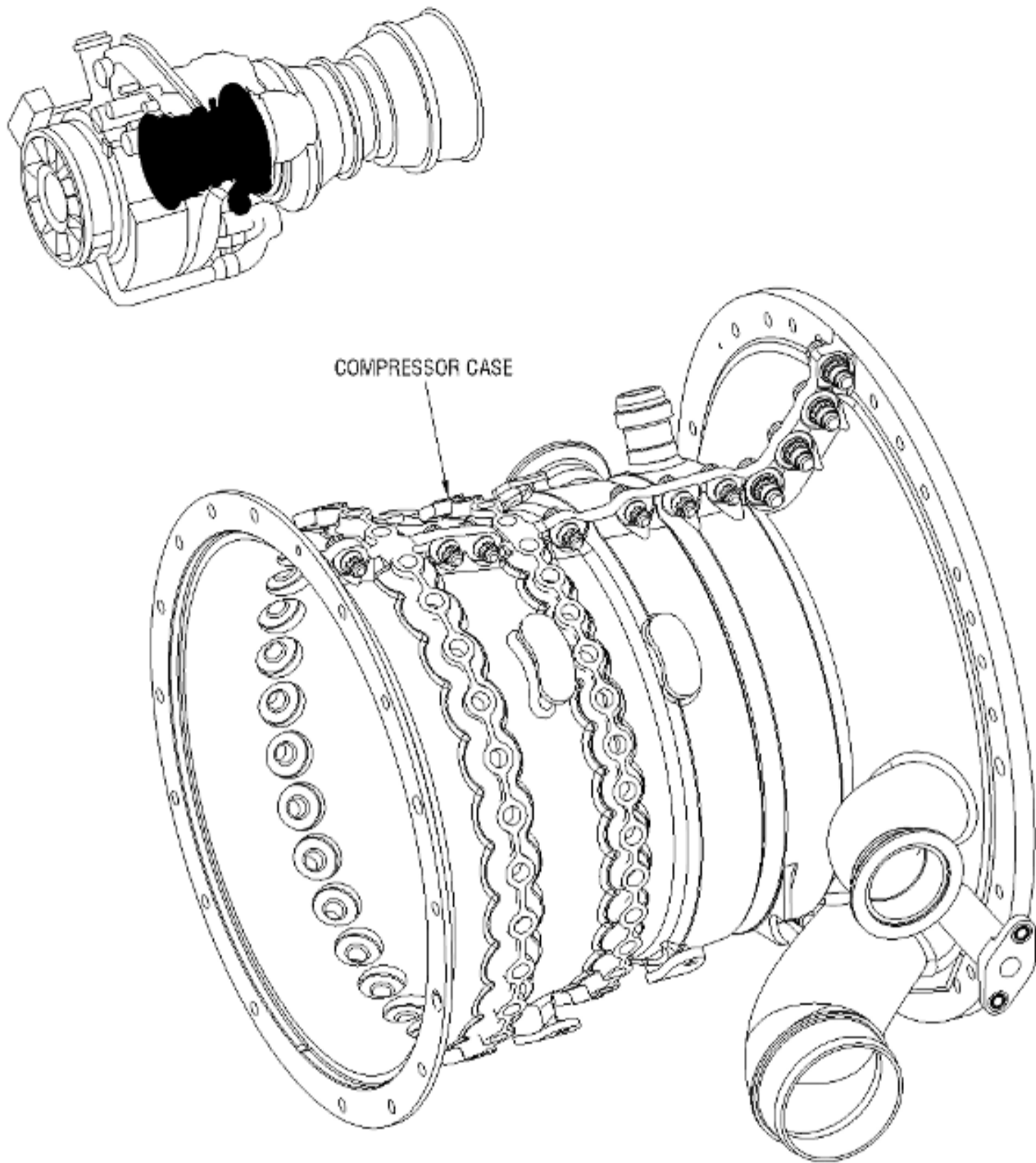

6037001-00

Compressor Case
Figure 1

GE Designated: - CONFIDENTIAL Subject to the restrictions on the media