

PRATT & WHITNEY CANADA  
**SERVICE BULLETIN**

P&WC S.B. No. 41095R1

**BULLETIN INDEX LOCATOR**  
**72-50-04**

TURBOSHAFT ENGINE  
POWER TURBINE SHAFT - INSPECTION OF

MODEL APPLICATION

PT6C-67C

Compliance: CATEGORY 4

Summary: A cleaning process used during engine overhaul may have affected the mechanical properties of the polyimide sleeve that is used to center the torque meter reference tube inside the Power Turbine shaft. Disassemble the Power Turbine shaft, do an inspection of the shaft and replace the sleeve with a new one.

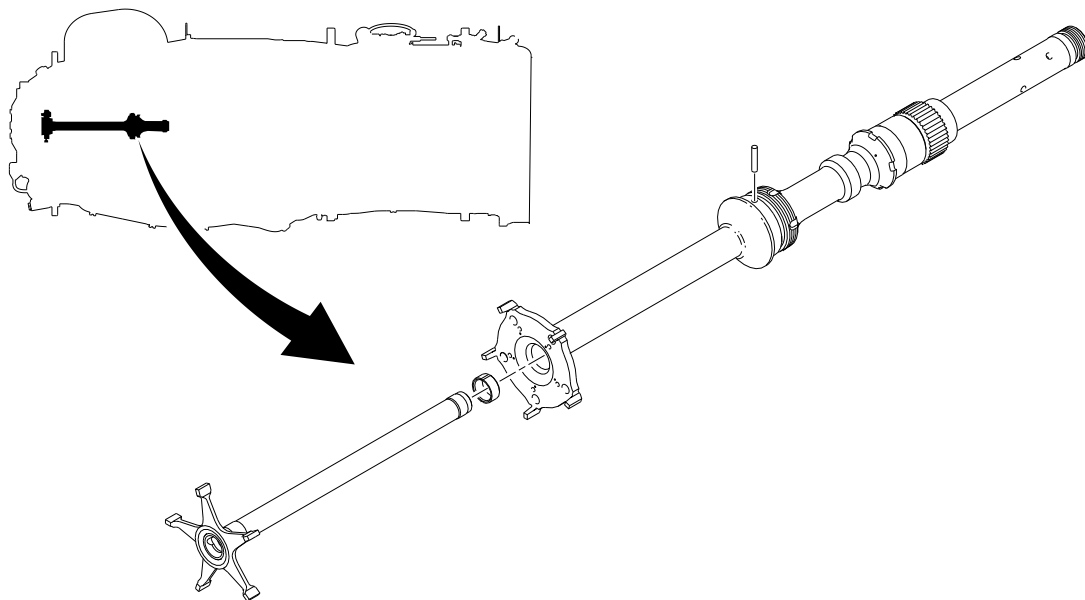

Sep 08/2015  
Revision No. 1: Oct 20/2016

**PT6C-72-41095**  
Cover Sheet

24-Hour Global Service

**CFIRST CENTRE**

Toll free where available (SIL GEN-027)

USA & CANADA..... 1-800-268-8000

International ..... (IAC\*)+8000-268-8000

\* International Access Code

Other..... 1-450-647-8000

Fax..... 1-450-647-2888

Web Site ..... [www.pwc.ca](http://www.pwc.ca)

Export Control Classification			
			(X) if Applicable
Contains no Technical Data			()
Not Subject to the EAR pursuant to 15 CFR 734.7(a)(1) or Not Subject to the ITAR pursuant to 22 CFR 120.11 (NSR)			()
Jurisdiction and Classification based on Physical Location of the Item.  * Additionally, refer to the classification under the local export regime where the item is located, as provided in the grid.	Location	Regulations	
		EAR	ITAR
	Outside US*	NSR	NSR
	U.S.	9E991	NSR
		EIPA (ECL)	DPA (CG)
	Canada	NSR	No

WARNING - PROPRIETARY RIGHTS & EXPORT CONTROLS NOTICE

This bulletin contains proprietary information of Pratt & Whitney Canada Corp. ("P&WC"), which P&WC provides in confidence and solely for the purposes of supporting engine certification and providing applicable information regarding the proper use, maintenance, inspection, repair, servicing and parts application of P&WC products and services, as directed therein. Neither this bulletin nor any information in it may be disclosed to others, or used for any other purpose, including, without limitation, to design, create, develop, reproduce, manufacture or derive any design, part, product, material, process, modification, configuration change or repair, or obtain FAA or other government approval to do so. Possession and use of this bulletin is also subject to the restrictions set out in P&WC's Technical Data Agreement (a copy of which may be obtained by contacting P&WC Technical Publications). The contents of this bulletin may be subject to export control laws. Unauthorized export or re-export of the bulletin, or parts thereof, is prohibited. By accepting and possessing this bulletin, you agree to be bound by the foregoing terms.

If a Government agency or department intends to disclose any information, written notice should be given to:

VP - Legal Services, Pratt & Whitney Canada Corp., 1000 Marie-Victorin (01BE5), Longueuil, Quebec J4G 1A1.



20 October 2016

P&WC S.B. No. 41095R1

REVISION TRANSMITTAL SHEET  
TURBOSHAFT ENGINE MODEL PT6C

SUBJECT: Pratt & Whitney Canada Service Bulletin No. PT6C-72-41095, Rev. No. 1, dated Oct 20/2016 (P&WC S.B. No. 41095R1) POWER TURBINE SHAFT - INSPECTION OF

Replace your existing copy of this service bulletin with the attached revised bulletin. Destroy the superseded copy.

Please retain this Revision Transmittal Sheet with the revised bulletin.

SUMMARY: This service bulletin is revised to clarify the Accomplishment Instructions in Para 3.

EFFECT OF REVISION ON PRIOR ACCOMPLISHMENT:

None.

NOTE: A black bar in the left margin indicates a change in that line of text or figure.

REVISION HISTORY:

Original Issue: Sep 08/2015  
Revision No. 1: Oct 20/2016



PRATT & WHITNEY CANADA  
**SERVICE BULLETIN**

P&WC S.B. No. 41095R1

TURBOSHAFT ENGINE  
POWER TURBINE SHAFT - INSPECTION OF

1. Planning Information

A. Effectivity

PT6C-67C Engines overhauled prior to October 22/2013, excluding engine Serial No. PCE-KB0075, PCE-KB0076, PCE-KB0078, PCE-KB0087, PCE-KB0095 and PCE-KB0525.

NOTE: This Service Bulletin is not applicable if a new power turbine shaft/torque shaft was installed at or after the overhaul.

B. Concurrent Requirements

None.

C. Reason

(1) Problem

A cleaning process used during engine overhaul prior to October 22/2013 may have affected the mechanical properties of a polyimide sleeve that is used to center the torque meter reference tube inside the Power Turbine shaft.

(2) Cause

Cleaning solution not compatible with the polyimide material of the sleeve.

(3) Solution

Disassemble the Power Turbine (PT) shaft housing assembly, do an overhaul inspection of the PT shaft and torque meter reference tube, and replace the polyimide sleeve with a new one.

D. Description

Do an overhaul inspection of the PT shaft and torque meter reference tube and replace the polyimide sleeve.

E. Compliance

CATEGORY 4 - P&WC recommends to do this service bulletin the first time the engine or module is at a maintenance base that can do the procedures, regardless of the scheduled maintenance action or reason for engine removal.

F. Approval

D.A.A. approved

P&WC No. DCR32261

Sep 08/2015

Revision No. 1: Oct 20/2016

P&WC Proprietary Information. Subject to the restrictions on the back of the locator

The export control classification with respect to this document is contained on the back of the locator.

© 2015 Pratt & Whitney Canada Corp.  
PRINTED IN CANADA

**PT6C-72-41095**

Page 1 of 4

PRATT & WHITNEY CANADA  
**SERVICE BULLETIN**

P&WC S.B. No. 41095R1

TURBOSHAFT ENGINE  
POWER TURBINE SHAFT - INSPECTION OF

1. Planning Information (Cont'd)

G. Manpower

No more man-hours are necessary to include this service bulletin at overhaul.

H. Weight and Balance

None.

I. Electrical Load Data

Not changed.

J. Software Accomplishment Summary

Not applicable.

K. References

Overhaul Manual P/N 3045333 (PT6C-67C)  
Illustrated Parts Catalog P/N 3045334 (PT6C-67C)  
CIR manual P/N 3075447 (PT6C)  
RDTI 725017-TI-0103

L. Publications Affected

Illustrated Parts Catalog P/N 3045334 (PT6C-67C)

M. Interchangeability and Intermixability of Parts

Interchangeability - Refer to Para. 2.C.

Intermixability - Not changed.

2. Material Information

A. Industry Support Information

Contact P&WC Warranty department.

B. Material - Cost and Availability

You can get the procurable parts listed in Para. 2.C. from any Pratt & Whitney Canada Parts Distribution Center.

The estimated total cost of new parts needed to replace old parts is \$Quote (US, 2015).

# PRATT & WHITNEY CANADA SERVICE BULLETIN

P&WC S.B. No. 41095R1

## TURBOSHAFT ENGINE POWER TURBINE SHAFT - INSPECTION OF

### 2. Material Information (Cont'd)

The new parts are available.

#### C. Material Necessary for Each Engine

The quantity of materials listed in this section is on a per Engine basis.

<u>New P/N</u>	<u>Keyword</u>	<u>Old P/N</u>	<u>Qty</u>	<u>Est. Unit List Price (\$US, 2015)</u>	<u>Instructions Disposition</u>
<b>Consumable Materials and Parts Required:</b>					
3049837-01	Sleeve, Power Turbine Shaft	3049837-01	1	493.80	(B)
3054847CL	Pin, Straight, Headless	3054847CL	1	437.60	(A)(B)
3054847CL21	. Pin, Straight, Headless	3054847CL21	AR		
3054847CL23	. Pin, Straight, Headless	3054847CL23	AR		
3054847CL25	. Pin, Straight, Headless	3054847CL25	AR		
3054847CL27	. Pin, Straight, Headless	3054847CL27	AR		
3054847CL29	. Pin, Straight, Headless	3054847CL29	AR		
3054847CL31	. Pin, Straight, Headless	3054847CL31	AR		
3054847CL33	. Pin, Straight, Headless	3054847CL33	AR		
3054847CL35	. Pin, Straight, Headless	3054847CL35	AR		

(A) P/N 3054847CL is not procurable, select appropriate class.

(B) Standard replacement part. Latest at the time of SB issue.

#### D. Reidentified Parts

None.

#### E. Tooling - Price and Availability

Not applicable.

### 3. Accomplishment Instructions

A. Disassemble the Power Turbine (PT) shaft housing assembly (Ref. OHM 72-50-06).

PRATT & WHITNEY CANADA  
**SERVICE BULLETIN**

P&WC S.B. No. 41095R1

TURBOSHAFT ENGINE  
POWER TURBINE SHAFT - INSPECTION OF

3. Accomplishment Instructions (Cont'd)

B. Disassemble PT shaft and output shaft (Ref. OHM 72-50-06).

NOTE: Refer to latest revision of RDTI 725017-TI-0103 for instructions on how to disassemble and re-assemble the torque meter reference tube.

C. Disassemble torque meter reference tube and PT shaft; discard sleeve.

D. Do an overhaul inspection of the PT shaft and torque meter reference tube in accordance with the instructions in the overhaul manual (Ref. OHM 72-50-06).

E. Assemble serviceable torque meter reference tube and PT shaft with new sleeve.

F. Assemble the Sleeve in Power Turbine (PT) shaft assembly (Ref. CIR 72-53-15).

G. Write accomplishment of P&WC S.B. No. 41095 in the engine module log book.

4. Appendix

Not applicable.