

# SERVICE BULLETIN

**TITLE:** Fuel - Check of the fuel supply hose(s)

**SB Type:** Protective measure

## APPLICABILITY

Model:	AS350
Version:	B , B1 , B2 , B3 , BA , BB , D , L1
Component affected:	350A55100120 and 350A5510012001 and 350A55101500 and 350A55101501 and 350A55101502 and 350A5510150251 and 350A5510150252 and 704A44500000 and 704A44500004 and 704A44500027 and 704A44500028 and 704A44500127

## Components affected information table

Designation	Reference
Tank	MP/N 350A55-1001-20
Fuel tank assy	MP/N 350A55-1001-2001
Tank half assy	MP/N 350A55-1015-00
Tank assy	MP/N 350A55-1015-01
Fuel tank	MP/N 350A55-1015-02
Fuel tank	MP/N 350A55-1015-0251
Fuel tank	MP/N 350A55-1015-0252
Fuel tank	MP/N 704A44-5000-00 (P/N 704A44500000)
Self sealing fuel tank	MP/N 19262 (P/N 704A44500004)
Self sealing fuel tank	MP/N 20318 (P/N 704A44500027)

Export Control:

US Export Control - No US content. This Item does not contain any U.S. origin ITAR or EAR content.

FR Export Control - Not Listed. This Item is not listed against the EC regulations in the EU/FR

Designation	Reference
Self sealing fuel tank	MP/N 20545 (P/N 704A44500028)
Fuel tank	MP/N 00000008368 (P/N 704A44500127)

Only helicopters that are not equipped with energy absorbing fuel tank (Crash Resistant Fuel System - CRFS) are affected by this Service Bulletin.

### COMPLIANCE: RECOMMENDED

Airbus Helicopters recommends that you comply with the accomplishment procedure of this Service Bulletin within 150 FH (+15 FH of margin) or 12 months (+36 days of margin) (the first limit you get to is applicable) after you received this Service Bulletin. Refer to the issue date on this Service Bulletin.

### SUMMARY

The purpose of this Service Bulletin is to make sure that:

- The fuel supply hose is not damaged
- The fuel supply hose has no manufacturing defect.

### GENERAL EVALUATION

Evaluation table			
Perform once	YES	Recurring accomplishment	NO

### GENERAL ILLUSTRATION

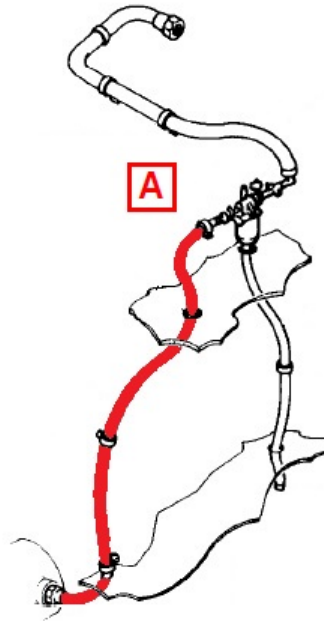
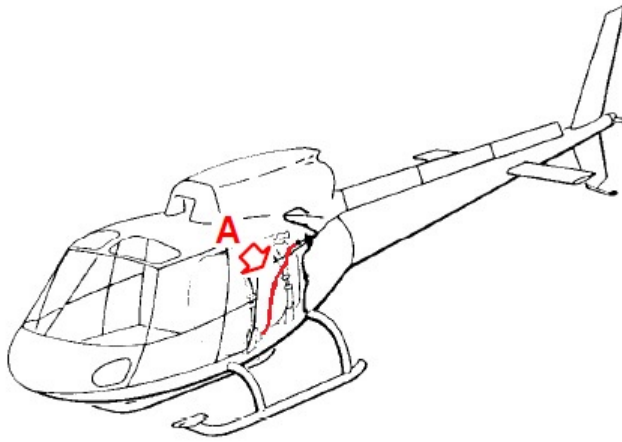

## PLANNING INFORMATION

### 1. REASON

The pilot reported a strong smell of kerosene and a fuel leak was found after the customer turned on the fuel pump. The technician opened the MGB cowling and found the leak originating from the fuel supply hose. This damage was not caused by any external factor. The leak was due to a defect in the hose and after cutting the hose coating, analysis showed that the material was unequally distributed around the tube. This non conformity could led to a weakness in hose sealing material and then a leakage.

Consequently, the purpose of this Service Bulletin is to make sure that:

- The fuel supply hose is not damaged
- The fuel supply hose has no manufacturing defect.

### 2. DESCRIPTION

This Service Bulletin includes the work steps that follows:

- Make sure that the fuel supply hose(s) is (are) not damaged.
- Make sure that the fuel supply hose(s) has (have) no manufacturing defect.
- Interpret the results.
- If necessary, replace the fuel supply hose(s).

### 3. CONFIGURATION DEFINITION

Not applicable.

### 4. CONCURRENT REQUIREMENTS

Not applicable.

### 5. APPROVAL

The technical content of this document is approved under the authority of the Design Organization Approval ref. EASA. 21J.700.

The technical content of this document is approved under the prerogatives of the recognition of design capability ref. EMAR21J-015-DGA for French Government helicopters.

The technical content of this document is approved by Airbus Helicopters Airworthiness Department for export military versions.

## 6. MANPOWER

### NOTE

The Purpose of Man Hours is to give Airbus Helicopters customers a guideline for maintenance scheduling. It is not a contractual information.

### 6.1. Manpower to check

Number of Persons	Qualification	Estimated Man Hours
1	Mechanical Technician	10 minutes (excluding the time to replace the fuel supply hose).

### 6.2. Manpower to replace the fuel supply hose

Number of Persons	Qualification	Estimated Man Hours
1	Mechanical Technician	4 h

## 7. WEIGHT AND BALANCE

There is no change in weight and moment.

## 8. ELECTRICAL LOAD DATA

This Service Bulletin has no effect on the electrical load analysis.

## 9. DOCUMENTATION AFFECTED

Not applicable.

## 10. MATERIAL INFORMATION

### 10.1. Price

For information about the price of the modification kits and/or components, or for aid, contact the Airbus Helicopters Network Sales and Customer Relations Department.

#### 10.2. Availability

Contact the Sales and Customer Relations Department to know the delivery lead times.

#### 10.3. Procurement

Send an order for the necessary quantities to the Airbus Helicopters Network Sales Department:

Airbus Helicopters  
Etablissement de Marignane  
Direction des Ventes et Relations Client  
13725 MARIIGNANE CEDEX FRANCE

In the purchase order, write the information that follows:

- The mode of transport
- The destination
- The serial numbers of the helicopters to change.

You can order the consumables from the AirbusWorld Marketplace through e-ordering (IN No. 3481-I-00). If you cannot get access to e-ordering, please contact your Logistic Focal Point.

#### 10.4. Mixability

This Service Bulletin has no effect on the mixability.

#### 10.5. LIST OF NEW MATERIALS

Individual Spares List				
Item	Designation	Reference	MFC	QTY
1	Fuel supply hose	5110D12X18,5	F0215	AR
3	Clamp cure date marking	702A40003120	F0210	AR
5	Cover	CA3200-18	F0215	AR
12	Tape spiral black	84904T125	F5442	AR
13	Identification band	DHS813-100.01	F0210	AR
14	Support clamp	E0688-03	F0210	2
15	Banding clamp	E0043-3C0P	F0210	4

Consumables, Materials and Expendables			
Designation	Reference	MFC	QTY
None			

Special Tools				
Item	Designation	Reference	MFC	QTY
2	Mirror	Commercial reference		1

#### 10.6. LIST OF EXISTING PARTS

Not applicable.

#### 11. ACCOMPLISHMENT INSTRUCTION

Comply with the accomplishment procedure [28-00-0001, 933](#)

#### 12. ADDITIONAL INFORMATION

Not applicable.

End of section

## ACCOMPLISHMENT PROCEDURE 28-00-0001, 933

### 1. APPLICABILITY

Model:	AS350
Version:	B , B1 , B2 , B3 , BA , BB , D , L1
Component affected:	350A55100120 and 350A5510012001 and 350A55101500 and 350A55101501 and 350A55101502 and 350A5510150251 and 350A5510150252 and 704A44500000 and 704A44500004 and 704A44500027 and 704A44500028 and 704A44500127

### 2. GENERAL INFORMATION

AMM - Aircraft Maintenance Manual

AR - As Required

CRFS - Crash Resistant Fuel System

FOD - Foreign Object Damage

IN - Information Notice

MET - Manuel d'Entretien (Maintenance Manual)

MP/N - Manufacturer Part Number

MTC - Manuel des Techniques Courantes (Standard Practices Manual)

P/N - Part Number

SPN - Safety Promotion Notice

### 3. PRELIMINARY REQUIREMENTS

#### 3.1. Applicable Documents

- GENERAL - The Marketplace: an AirbusWorld eOrdering service IN 3481-I-00
- Introduction of the digital Service Bulletin reporting service SB Insight IN 3785-I-00
- GENERAL - Foreign Object Damage prevention SPN 3703-P-00
- Handling - Handling of helicopters in a hangar and in a prepared area [MTC 20-07-01-201](#)
- Installation of pipes - General [MTC 20-02-01-103](#)



- Installation of narrow-band jubilee clip clamps - Joining [MTC 20-02-05-405](#)
- General instructions - Fuel System [MET 28-00-00-301](#)
- General Safety Instructions - Fuel System - Fuel System - Servicing [AMM 28-00-00,3-1](#)
- Assembly by screws and nuts - Joining [MTC 20-02-05-404](#)
- Storage and service life limits - Pipes - Hoses and flexible pipes [MTC 20-09-01-902](#)
- Identification procedure of fluid system pipes - General [MTC 20-02-01-101](#)

### 3.2. Set up

- Park the helicopter in a hangar. Refer to [MTC 20-07-01-201](#)
- Disconnect all the electrical power supplies.
- Install the applicable access equipment.
- Remove and/or open all applicable cowlings, panels, doors and other items of equipment to get access to the different work areas.

### 3.3. Special Tools

Designation	Reference	QTY
Mirror	Commercial	1

### 3.4. Consumables, Materials and Expendables

None

### 3.5. Spares

Designation	Reference	MFC	QTY
Fuel supply hose	5110D12X18,5	F0215	AR
Clamp cure date marking	702A40003120	F0210	AR
Cover	CA3200-18	F0215	AR
Tape spiral black	84904T125	F5442	AR
Identification band	DHS813-100.01	F0210	AR
Support clamp	E0688-03	F0210	2
Banding clamp	E0043-3C0P	F0210	4

### 3.6. Safety conditions

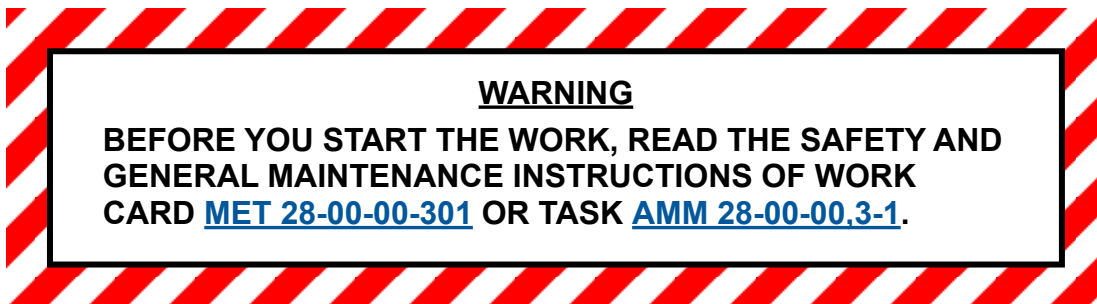

## 4. PROCEDURE

### 4.1. Inspection of the fuel supply hose:

- 4.1.1. Use the Mirror (2) to do a detailed visual inspection all along the fuel supply hoses (101) or (103) or (104) or (105) or (106) or (107) or (108) (from the engine to the fuel tank):
- Make sure that there is no damage and no manufacturing defect (where you can see the internal braid) on the fuel supply hoses (101) or (103) or (104) or (105) or (106) or (107) or (108). Refer to [\(Figure 1\)](#) and [\(Figure 2\)](#) or [\(Figure 3\)](#) or [\(Figure 4\)](#).



**Figure 1 - Example of fuel supply hose with a manufacturing defect where you can see the internal braid**

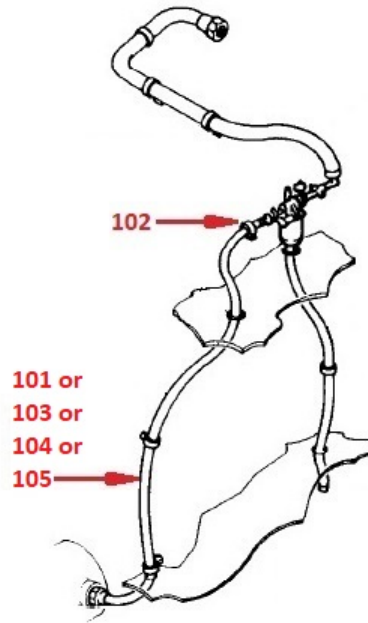

**Figure 2**

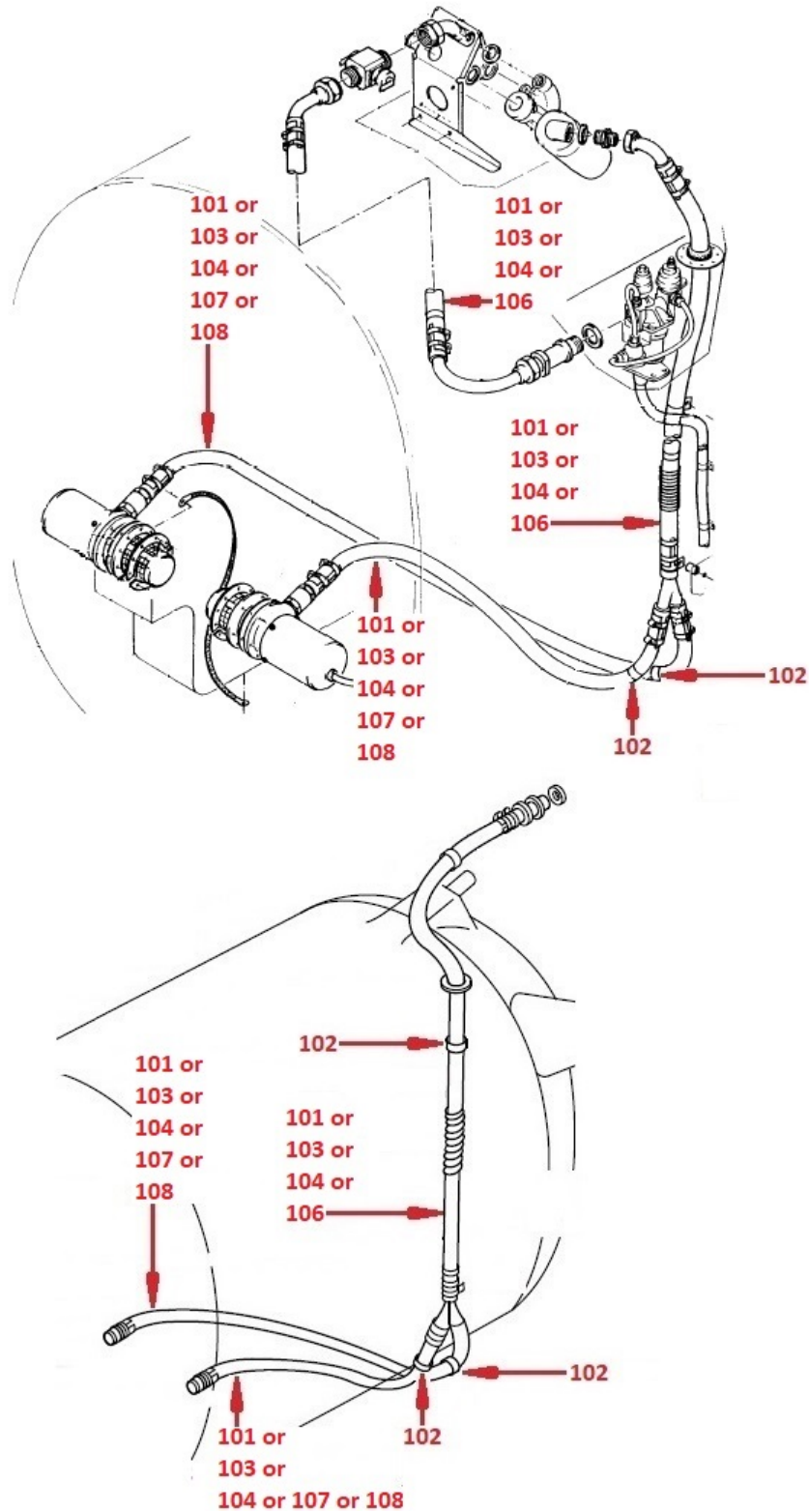

**Figure 3**

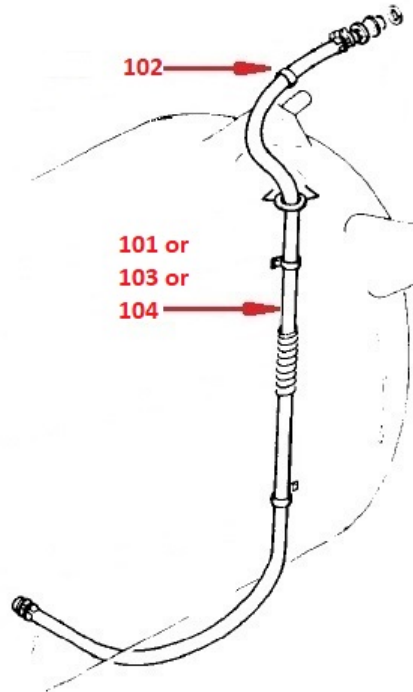

**Figure 4**

#### 4.2. **Interpretation of the results:**

4.2.1. If there is no damage and no manufacturing defect:

- Comply with paragraph 5. CLOSE UP.

4.2.2. If there is damage(s) and/or manufacturing defect(s):

- Comply with paragraph 4.3 Replacement of the fuel supply hose(s).

#### 4.3. **Replacement of the fuel supply hose(s):**

4.3.1. For helicopters that have only one fuel supply hose, refer to [\(Figure 5\)](#) or [\(Figure 6\)](#).

- Remove the binding clamps (4) from the fuel supply hose (101) or (103) or (104) or (105).
- Disconnect the fuel supply hose (101) or (103) or (104) or (105) from the end-fittings (6).
- Remove the covers (5) from the fuel supply hose (101) or (103) or (104) or (105).
- Keep the fuel supply hose removed (101) or (103) or (104) or (105) for cutting to length the new one for replacement.
- Remove and keep the components that follow:
  - The binding clamps (4)
  - The nuts (7)
  - The washers (8)
  - The screws (9)
  - The spacers (10)
  - The clamps (11).
- Discard the components that follow:
  - The identification band (13) (not shown)
  - The covers (5)
  - The spiral tape (12)
- Cut the new Fuel supply hose 5110D12X18,5 (1) to length.
- Put a Cover CA3200-18 (5) at both ends of the new Fuel supply hose 5110D12X18,5 (1), and adjust if necessary.
- Refer to Work Cards [MTC 20-02-01-103](#) and [MTC 20-02-05-404](#) and install the new Fuel supply hose 5110D12X18,5 (1) on the helicopter with the components that follow:
  - The nuts (7)
  - The washers (8)
  - The screws (9)
  - The spacers (10)
  - The clamps (11).

- Connect the new Fuel supply hose 5110D12X18,5 (1) to the end-fitting (6).
- Install the two binding clamps (4) on each Cover CA3200-18 (5). Refer to Work Card [MTC 20-02-05-405](#).
- Install a new Clamp cure date marking 702A40003120 (3) on the new Fuel supply hose 5110D12X18,5 (1).
- Write the expiry date on the Clamp cure date marking 702A40003120 (3). Refer to Work Card [MTC 20-09-01-902](#).
- Attach the Identification band DHS813-100.01 (13) (not shown) at each end and one in the middle of the Fuel supply hose 5110D12X18,5 (1). Refer to Work Card [MTC 20-02-01-101](#).
- Install a new Tape spiral black 84904T125 (12) on the new Fuel supply hose 5110D12X18,5 (1).

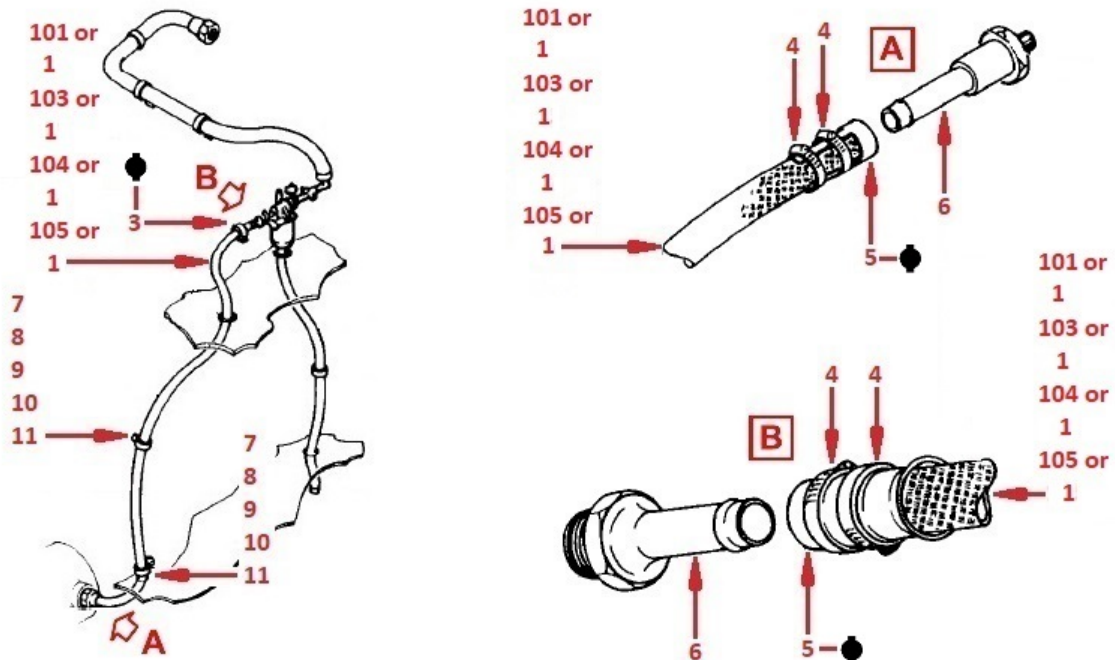

Figure 5



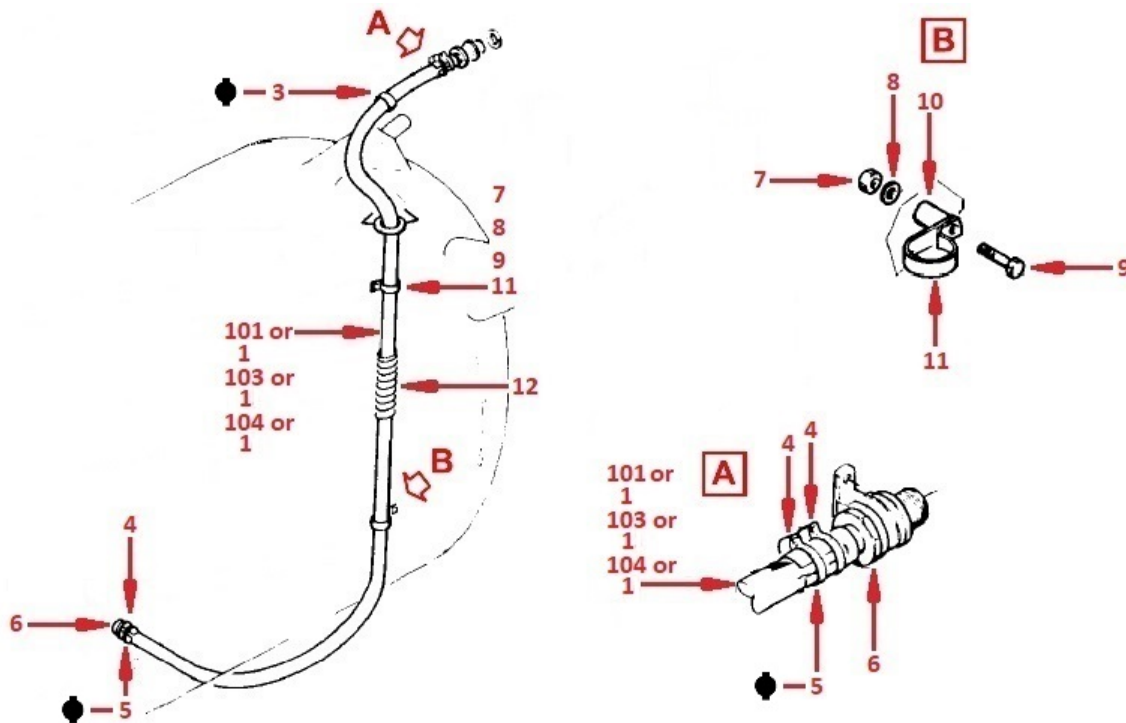

Figure 6

- 4.3.2. For helicopters that have three or four fuel supply hoses, refer to [\(Figure 7\)](#) or [\(Figure 8\)](#).

#### NOTE

The replacement procedure is given for only one fuel supply hose. Do the same procedure for the other fuel supply hoses, unless differently specified.

- Remove the binding clamps (4) from the fuel supply hose (101) or (103) or (104) or (106) or (107) or (108).
- Disconnect the fuel supply hose (101) or (103) or (104) or (106) or (107) or (108) from the end-fittings (6).
- Remove the covers (5) from the fuel supply hose (101) or (103) or (104) or (106) or (107) or (108).
- Keep the fuel supply hose removed (101) or (103) or (104) or (106) or (107) or (108) for cutting to length the new one for replacement.
- Identify the fuel supply hose (101) or (103) or (104) or (106) or (107) or (108).
- Remove and keep the components that follow:
  - The binding clamps (4)
  - The nuts (7)
  - The washers (8)
  - The screws (9)
  - The spacers (10)
  - The clamps (11).
- Discard the components that follow:
  - The identification band (13) (not shown)
  - The covers (5)
  - The spiral tape (12)
  - The fuel supply hose (101) or (103) or (104) or (106) or (107) or (108)
- Cut the new Fuel supply hose 5110D12X18,5 (1) to length.
- Put a Cover CA3200-18 (5) at both ends of the new Fuel supply hose 5110D12X18,5 (1), and adjust if necessary.
- Refer to Work Cards [MTC 20-02-01-103](#) and [MTC 20-02-05-404](#) and install the new Fuel supply hose 5110D12X18,5 (1) on the helicopter with the components that follow:
  - The nuts (7)
  - The washers (8)
  - The screws (9)
  - The spacers (10)
  - The clamps (11).
- Connect the new Fuel supply hose 5110D12X18,5 (1) to the end-fittings (6).

#### NOTE

The fuel supply hose engages by 50 mm (1.97 in.) in the "Y" tube so that the red paint area (not shown) cannot be seen. Do not make any low points on the system.

- Install the two binding clamps (4) on each new Cover CA3200-18 (5). Refer to Work Card [MTC 20-02-05-405](#).

- Install a new Clamp cure date marking 702A40003120 (3) on the new Fuel supply hose 5110D12X18,5 (1).
- Write the expiry date on the Clamp cure date marking 702A40003120 (3). Refer to Work Card [MTC 20-09-01-902](#).
- Attach the Identification band DHS813-100.01 (13) (not shown) at each end and one in the middle of the Fuel supply hose 5110D12X18,5 (3). Refer to Work Card [MTC 20-02-01-101](#).
- Install a new Tape spiral black 84904T125 (12) on the new Fuel supply hose 5110D12X18,5 (1).
- If necessary, install Support clamp E0688-03 (14) with the Banding clamp E0043-3C0P (15). Refer to (Figure 9):
  - The distance between the Support clamp E0688-03 (14) is 140 mm (5.511 in).
  - The distance between the Support clamp E0688-03 (14) and the end-fittings (6) is 220 mm (8.661 in).

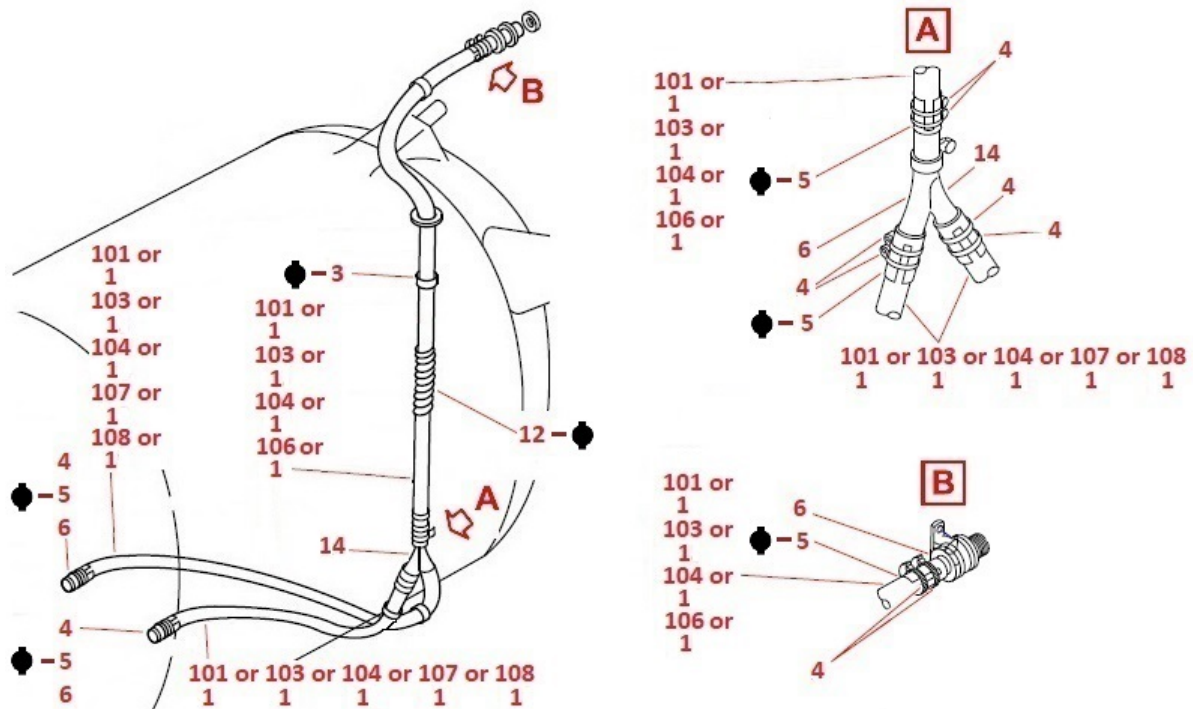

Figure 7

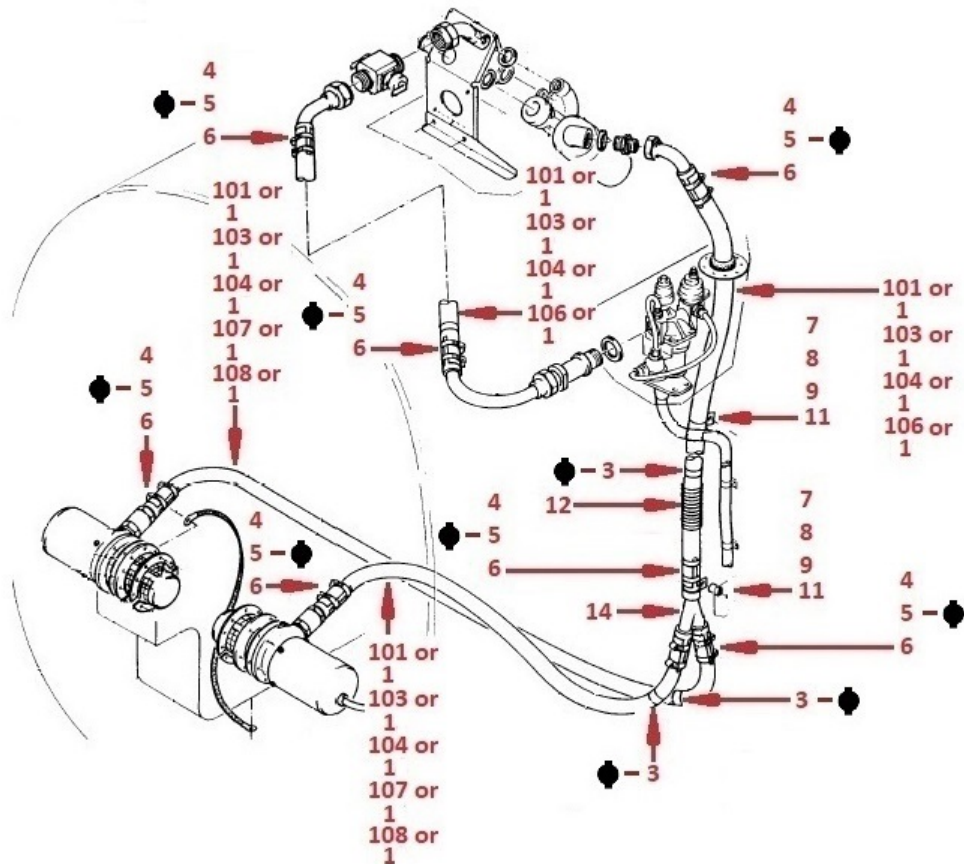
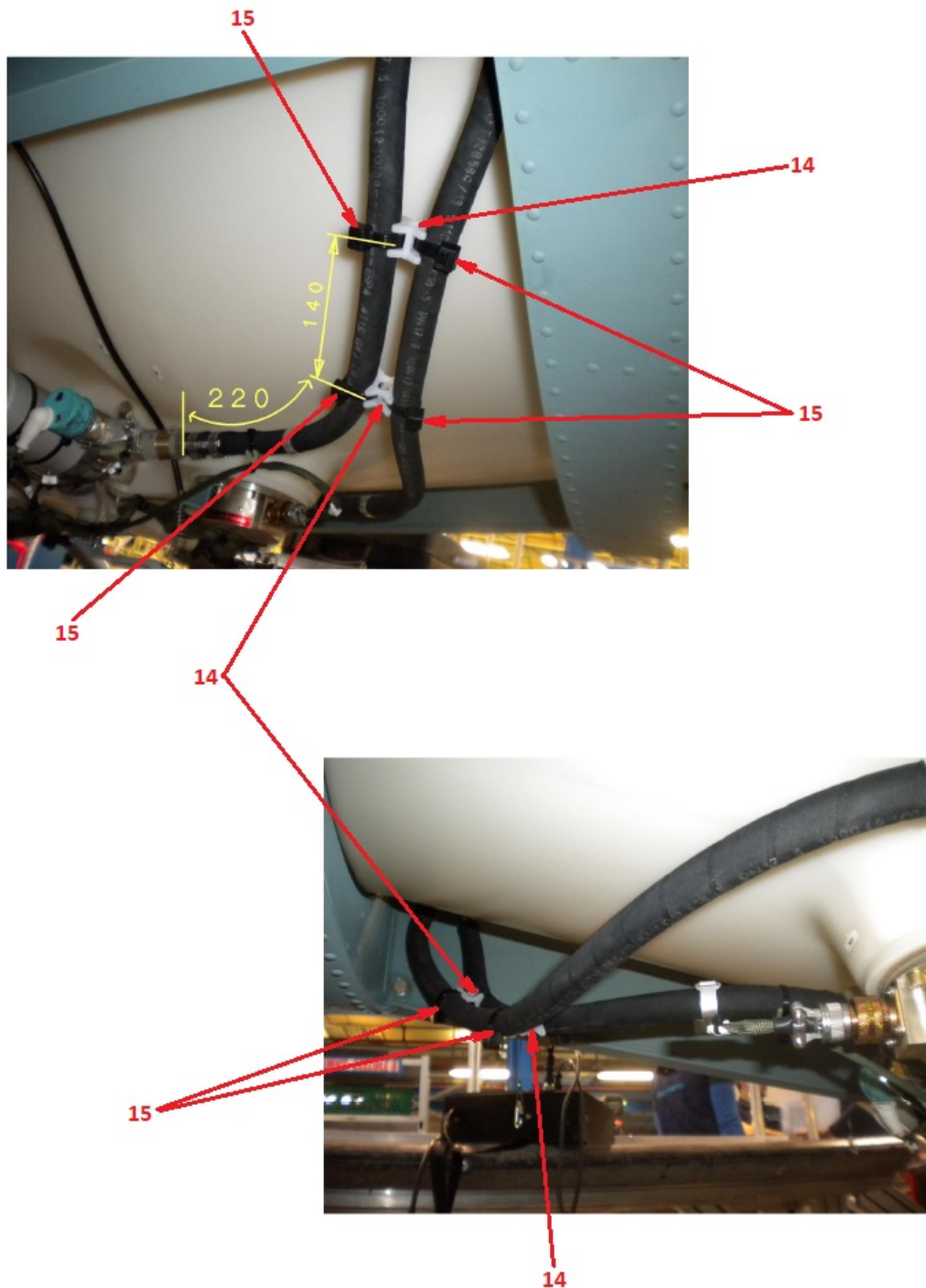

Figure 8



**Figure 9 - Routing aid**

## 5. CLOSE UP

- 5.1. Remove all tools, the materials and the equipment from your work area.
- 5.2. Install or close all cowlings, panels, doors and items of equipment that you removed and/or opened during the preliminary steps (paragraph set-up of this Service Bulletin).
- 5.3. Remove the access equipment.
- 5.4. Connect all the electrical power supplies.
- 5.5. Flash the QR Code of this Service Bulletin.
- 5.6. Record the full compliance with this Service Bulletin in the helicopter documents.
- 5.7. Record compliance with this Service Bulletin (see IN 3785-I-00 for instructions):  
QR code or hypertext link.



[SB AS350-28-00-0001](#)

End of Service Bulletin