SERVICE BULLETIN**N° 189-275****DATE:** March 25, 2021**REV. :** A - November 16, 2021

TITLE**ATA 11 – DUAL HOIST KIT DECALS REPLACEMENT****REVISION LOG**

Revision A is issued to:

- Add dedicated instructions for helicopters equipped with soft liner kit in Part I “Compliance Instructions” section.
- Added Figure 2 dedicated to helicopters equipped with dual hoist fairing assy P/N 8G2591A16931 or P/N 8G2591A16932.
- Added “Concurrent requirements” for helicopter already compliant with SB189-275 Rev./.

The left margin identify changes.

1. PLANNING INFORMATION

A. EFFECTIVITY

AW189 helicopters S/N 49031, S/N 49032, S/N 49037, S/N 49038, S/N 49042, S/N 49043, S/N 49044, S/N 49046, S/N 49047, S/N 49052, S/N 49055, S/N 49061 S/N 49062 and S/N 49063.

B. COMPLIANCE

Before the next foreseen hoist operation at 0°C OAT or below.

C. CONCURRENT REQUIREMENTS

AW 189 helicopters equipped with dual hoist fairing assy P/N 8G2591A16931 or P/N 8G2591A16932 and already compliant with SB189-275 rev./, must perform Step 5 of this SB in case no decal was installed on hoist fairings.

D. REASON

This Service Bulletin is issued in order to provide the necessary instructions on how to replace the dual hoist decals in Russian language with the equivalent decal in English language.

E. DESCRIPTION

Three rescue hoist decals, in Russian and English languages, report an incorrect indication of the maximum hoist load allowed at 0°C OAT. The decals P/N 8G1120A10651 and P/N 8G1130A17851, currently installed, report a maximum hoist load of 550lb at 0°C OAT while the correct value is 500lb.

The incorrect decals will be replaced with the equivalent one only in English language reporting the correct hoist maximum load for 0°C OAT condition.

F. APPROVAL

The technical content of this Service Bulletin is approved under the authority of DOA nr. EASA.21.J.005. For helicopters registered under other Aviation Authorities, before applying the Service Bulletin, applicable Aviation Authority approval must be checked within Leonardo Helicopters customer portal.

EASA states mandatory compliance with inspections, modifications or technical directives and related time of compliance by means of relevant Airworthiness Directives. If an aircraft listed in the effectivity embodies a modification or repair not LHD certified and affecting the content of this Service Bulletin, it is responsibility of the Owner/Operator to obtain a formal approval by Aviation Authority having jurisdiction on

S.B. N°189-275

DATE: March 25, 2021

REVISION: A - November 16, 2021

the aircraft, for any adaptation necessary before incorporation of the present Service Bulletin.

G. MANPOWER

To comply with this Service Bulletin two (2) MMH are deemed necessary.

MMH are based on hands-on time and can change with personnel and facilities available.

H. WEIGHT AND BALANCE

N.A.

I. REFERENCES

1) PUBLICATIONS

| <u>DATA MODULE</u> | <u>DESCRIPTION</u> | <u>PART</u> |
|-------------------------------|--|-------------|
| DM01 89-A-00-20-00-00A-120A-A | Helicopter on ground for a safe maintenance. | - |
| DM02 89-A-06-41-00-00A-010A-A | Access doors and panels - Remove procedure. | - |
| DM03 89-A-11-00-01-00A-520B-A | Decal (vinyl film) - Remove procedure | - |
| DM04 89-A-11-00-01-00A-720A-A | Decal - Install procedure | - |

2) ACRONYMS

| | |
|------|---|
| AMP | Aircraft Maintenance Publication |
| AMDI | Aircraft Material Data Information |
| DM | Data Module |
| DOA | Design Organization Approval |
| EASA | European Aviation Safety Agency |
| LHD | Leonardo Spa Helicopters |
| IPD | Illustrated Parts Data |
| ITEP | Illustrated Tools and Equipment Publication |
| MMH | Maintenance Man Hours |
| OAT | Outer Air Temperature |

3) ANNEX

N.A.

J. PUBLICATIONS AFFECTED

AW189 Illustrated Parts Data (IPD).

K. SOFTWARE ACCOMPLISHMENT SUMMARY

N.A.

2. MATERIAL INFORMATION

A. REQUIRED MATERIALS

1) PARTS

| # | P/N | ALTERNATIVE P/N | DESCRIPTION | Q.TY | LVL | NOTE | LOG P/N |
|----------|------------------|------------------------|--------------------|-------------|------------|-------------|----------------|
| 1 | AW002DBHO001E02C | | Decal | 3 | . | | - |

2) CONSUMABLES

Refer to AMDI for the consumable materials required to comply with the AMP DM referenced in the accomplishment instructions.

3) LOGISTIC MATRIX

N.A.

B. SPECIAL TOOLS

Refer to ITEP for the special tools required to comply with the AMP DM referenced in the accomplishment instructions.

C. INDUSTRY SUPPORT INFORMATION

Warranty: Owners/Operators who comply with the instructions of this Service Bulletin no later than the applicable date in the "Compliance" section will be eligible to receive necessary replacements on free of charge basis, except for Consumable Materials and Special Tools.

NOTE: Customers who fail to comply with the instructions in this Service Bulletin before the compliance date are not eligible for the aforementioned special policy.

Please Issue relevant MMIR form to your Warranty Administration Dpt.

3. ACCOMPLISHMENT INSTRUCTIONS

GENERAL NOTE

Place an identification tag on all components that are re-usable, including the attaching hardware that has been removed to gain access to the modification area and adequately protect them until their later re-use.

1. In accordance with AMP DM 89-A-00-20-00-00A-120A-A, prepare the helicopter on ground for a safe maintenance. Disconnect the battery, all electrical power sources and/or the external power supply.
2. In accordance with AMP DM 89-A-06-41-00-00A-010A-A and with reference to Figures 1 thru 3, gain access to the area affected by the installation.
3. In accordance with AMP DM 89-A-11-00-01-00A-520B-A and with reference to Figures 1 or 2, remove n°2 decals P/N 8G1120A10651 from the external fairings of kit dual hoist.
4. With reference to Figure 3, perform the following procedure to remove the decal P/N 8G1130A17851 from inside the helicopter cabin:
 - 4.1 With reference to Figure 3, if the helicopter is equipped with soft liners, remove decal P/N 8G1130A17851 from the shown position.
 - 4.2 In accordance with AMP DM 89-A-11-00-01-00A-520B-A and with reference to Figure 3, if the helicopter is equipped with hard liners, remove the decal P/N 8G1130A17851 from the shown position.
5. In accordance with AMP DM 89-A-11-00-01-00A-720A-A and with reference to Figures 1 or 2, install n°2 decals P/N AW002DBHO001E02C on the external fairings of the kit dual hoist.
6. With reference to Figure 2, perform the following procedure to install the decal P/N AW002DBHO001E02C inside the cabin:
 - 6.1 With reference to Figure 2, if the helicopter is equipped with soft liners, install the decal P/N AW002DBHO001E02C on the shown position.
 - 6.2 In accordance with AMP DM 89-A-11-00-01-00A-720A-A and with reference to Figure 2, if the helicopter is equipped with hard liners, install the decal P/N AW002DBHO001E02C on the shown position.
7. Return the helicopter to flight configuration and record for compliance with this Service Bulletin on the helicopter logbook.

8. Send the attached compliance form to the following mail box:

engineering.support.lhd@leonardocompany.com

As an alternative, gain access to My Communications section on Leonardo WebPortal and compile the "Service Bulletin Application Communication".

NOTE:

⚠ APPLICABLE ONLY TO HELICOPTERS EQUIPPED WITH DUAL HOIST FAIRING ASSY P/N 8G2591A16931 OR P/N 8G2591A16932

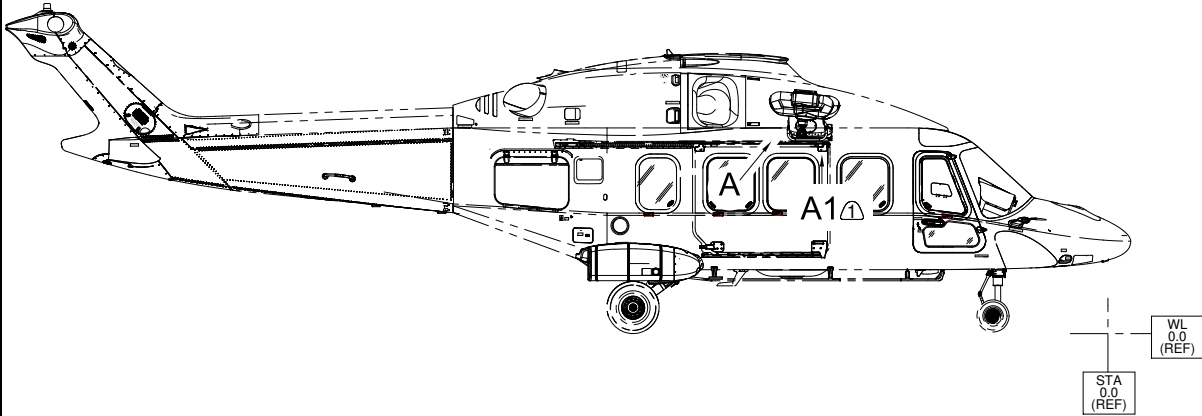

VIEW LOOKING INBOARD RIGHT SIDE

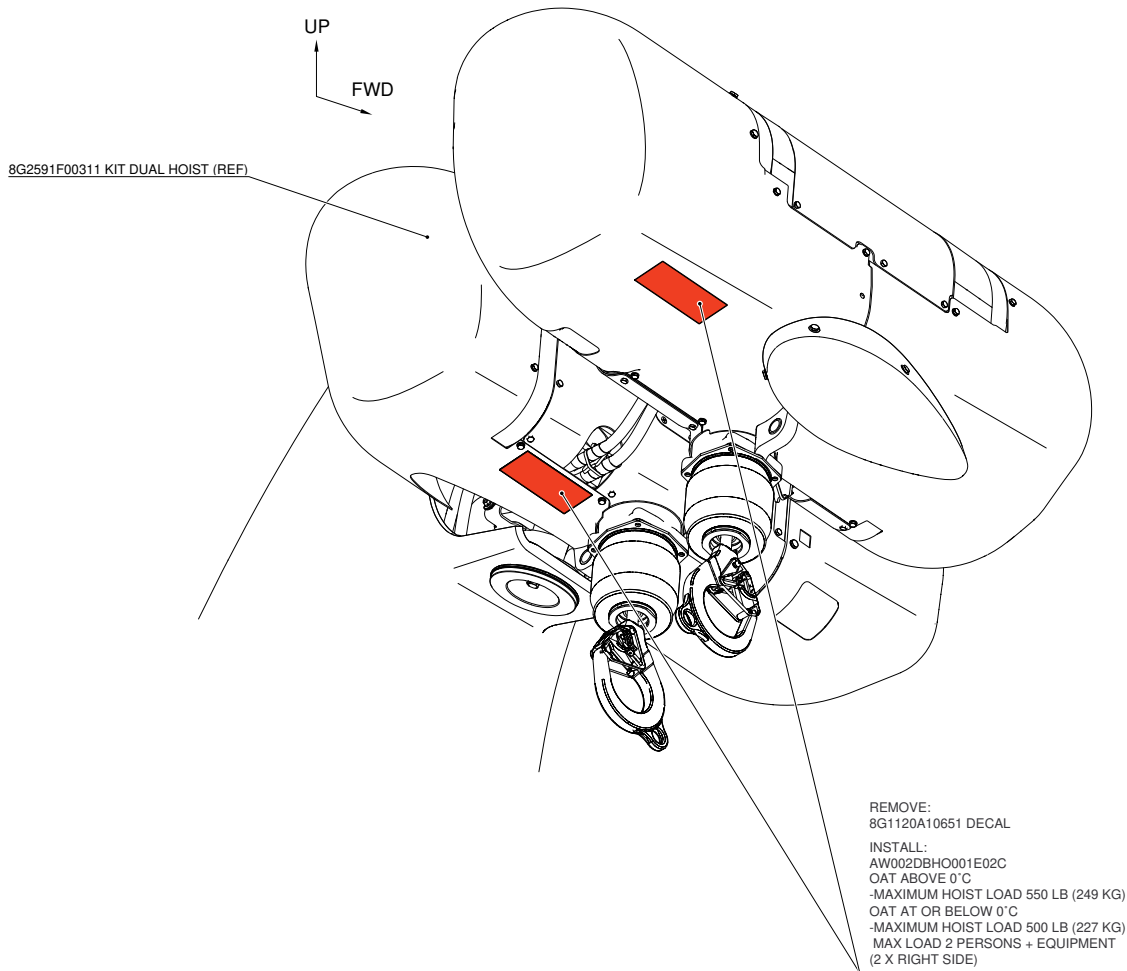

VIEW A

STRUCTURES AND SYSTEMS ARE PARTIALLY OMITTED FOR BETTER CLARITY PURPOSE

Figure 1

S.B. N°189-275

DATE: March 25, 2021

REVISION: A - November 16, 2021

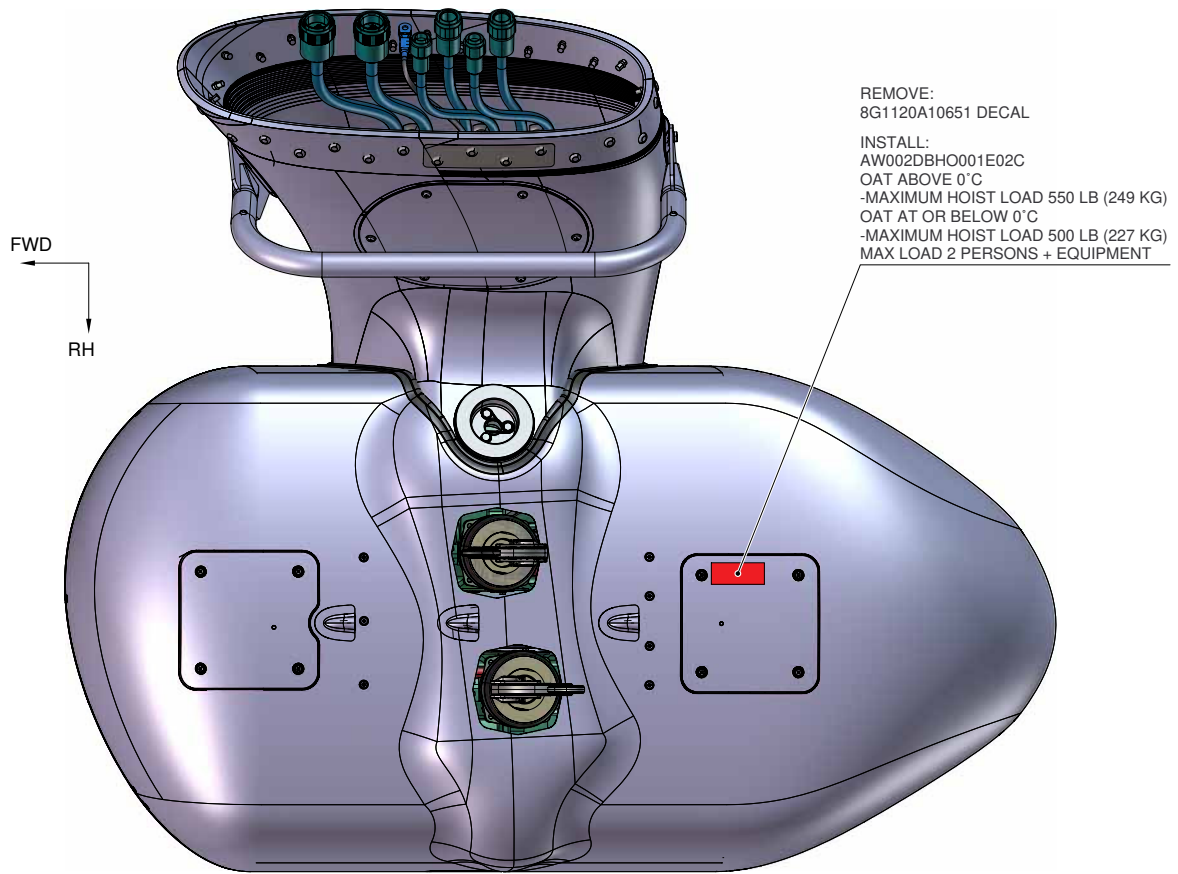

REMOVE:
8G1120A10651 DECAL

INSTALL:
AW002DBHO001E02C
OAT ABOVE 0°C
-MAXIMUM HOIST LOAD 550 LB (249 KG)
OAT AT OR BELOW 0°C
-MAXIMUM HOIST LOAD 500 LB (227 KG)
MAX LOAD 2 PERSONS + EQUIPMENT

C
↑

VIEW A1

(APPLICABLE ONLY TO HELICOPTERS EQUIPPED WITH DUAL HOIST FAIRING ASSY P/N 8G2591A16931 OR P/N 8G2591A16932)
STRUCTURES AND SYSTEMS ARE PARTIALLY OMITTED FOR BETTER CLARITY PURPOSE

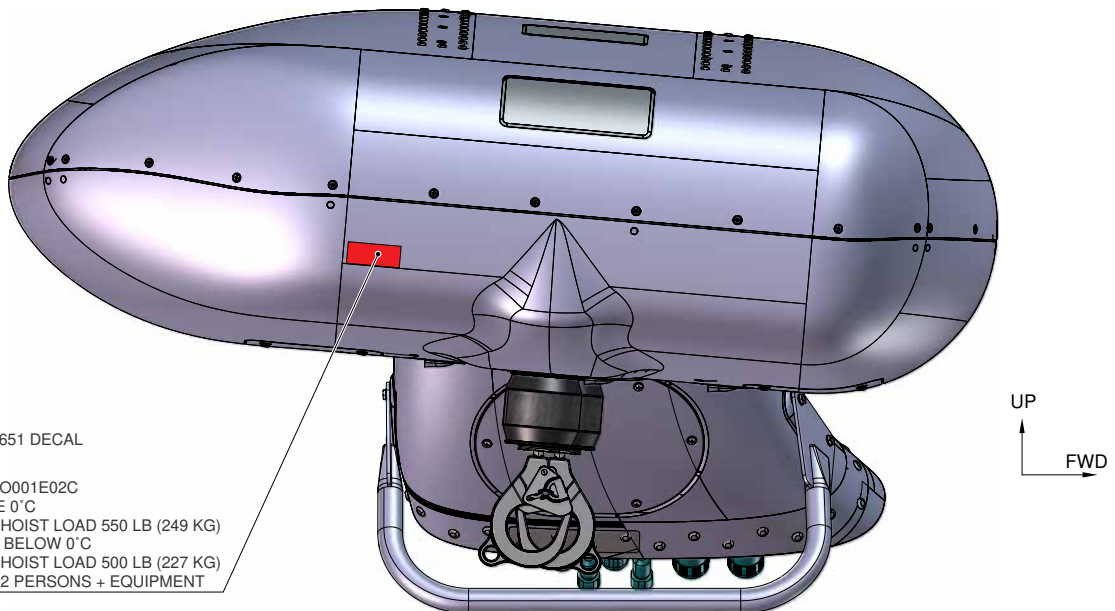

REMOVE:
8G1120A10651 DECAL

INSTALL:
AW002DBHO001E02C
OAT ABOVE 0°C
-MAXIMUM HOIST LOAD 550 LB (249 KG)
OAT AT OR BELOW 0°C
-MAXIMUM HOIST LOAD 500 LB (227 KG)
MAX LOAD 2 PERSONS + EQUIPMENT

UP
↑
FWD
→

VIEW C

(APPLICABLE ONLY TO HELICOPTERS EQUIPPED WITH DUAL HOIST FAIRING ASSY P/N 8G2591A16931 OR P/N 8G2591A16932)
STRUCTURES AND SYSTEMS ARE PARTIALLY OMITTED FOR BETTER CLARITY PURPOSE

Figure 2

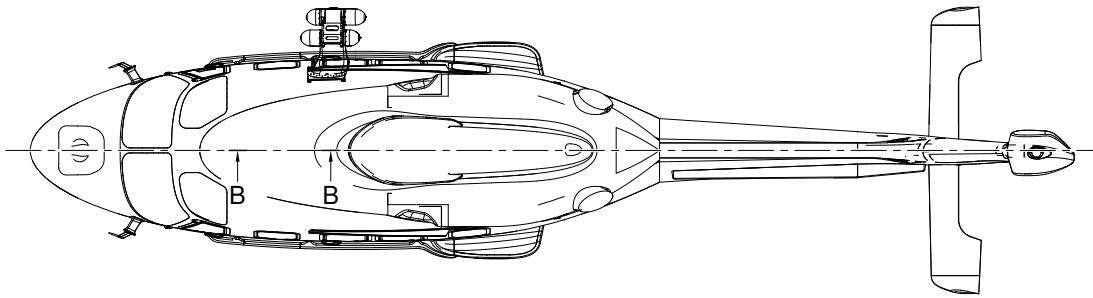

ORIENTATIVE VIEW

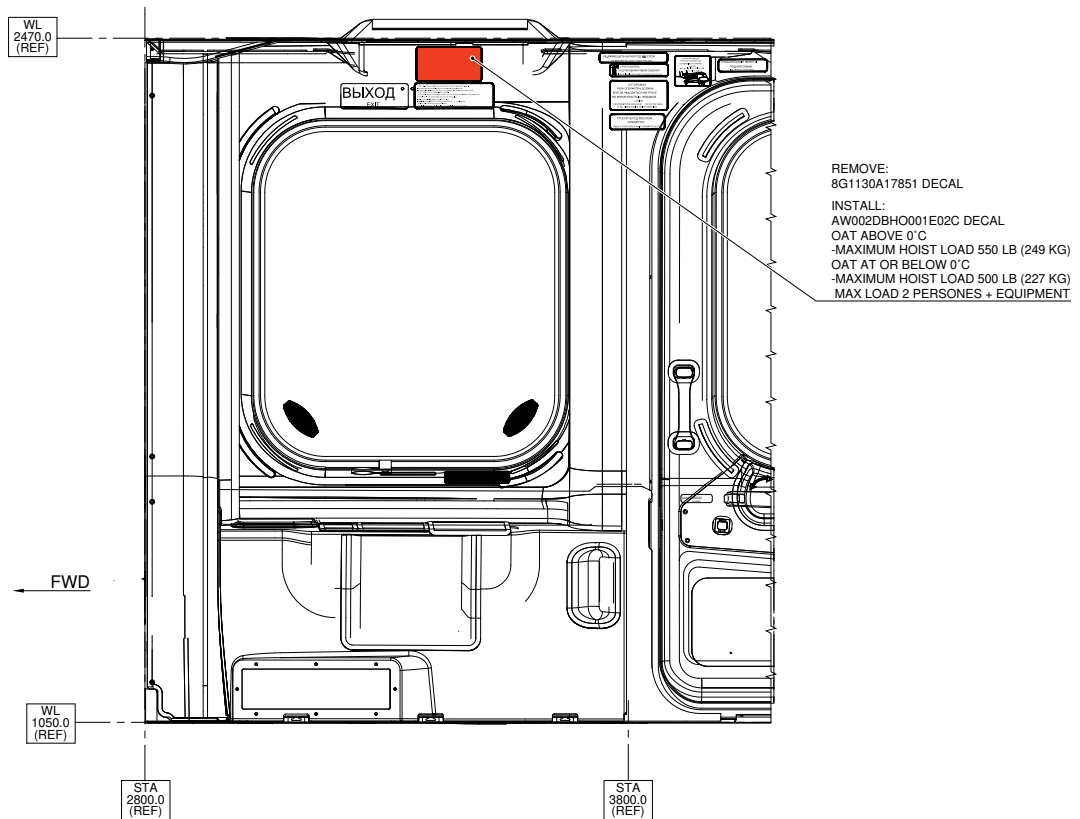

SECTION B-B

STRUCTURES AND SYSTEMS ARE PARTIALLY OMITTED FOR BETTER CLARITY PURPOSE

Figure 3

