

GSE & TOOL MANUAL

TITLE	BLANK KIT, MGB P/N 3G6305G08731
--------------	--

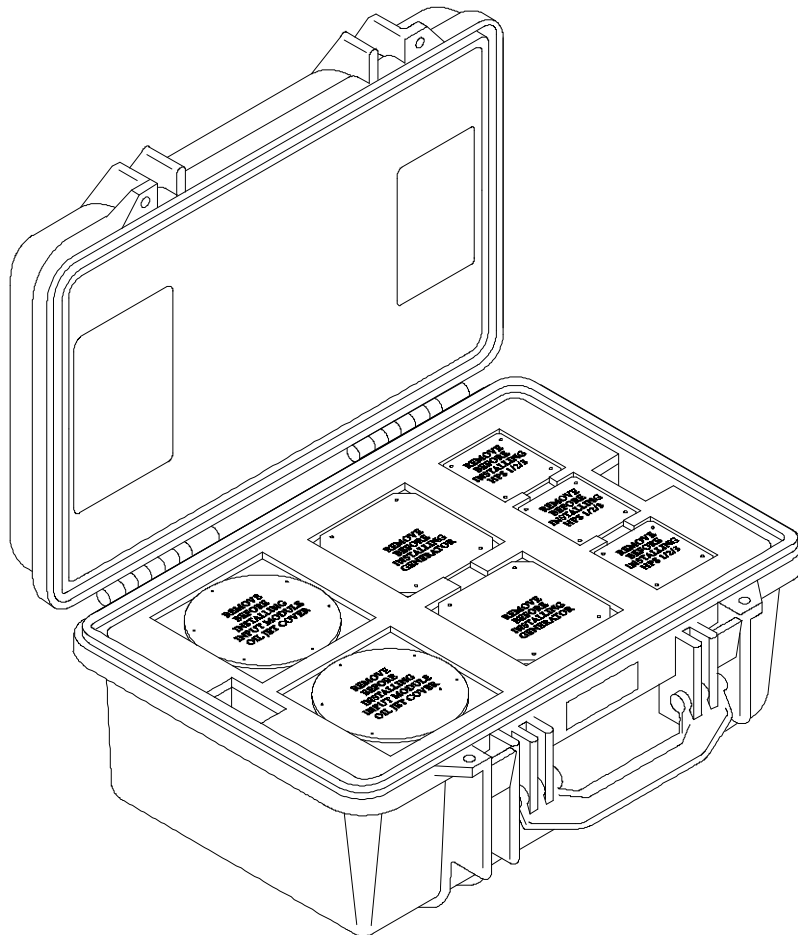

	GSE & TOOL USE AND MAINTENANCE MANUAL	Manual number: MAN-3G6305G08731 REV. A Pag. 2 of 18
---	--	--

REVISION HISTORY

REV	CHANGE DESCRIPTION	DATE
A	First issue	15/11/2021

SUMMARY

SUMMARY	3
LIST OF TABLE	4
LIST OF FIGURE	4
1. SCOPE	5
1.1. APPLICABILITY	5
1.2. OBJECT	5
1.3. WARNING AND SAFETY INSTRUCTIONS	5
2. DOCUMENTS	6
2.1. APPLICABLE DOCUMENTS	6
2.2. ACRONYMS USED	6
3. DESCRIPTION	7
4. TOP ASSEMBLY DRAWINGS	8
5. IDENTIFICATION	8
6. OVERALL DIMENSIONS	8
7. WEIGHT	8
8. MAIN PARTS	9
9. MAIN FEATURES DESCRIPTION	10
10. WARNING AND SAFETY NOTES	11
10.1. WARNING NOTE	11
10.2. SAFETY NOTES	12
11. STORAGE	13
11.1. LUBRICATION BEFORE STORAGE	13
11.2. STORAGE CONFIGURATION	13
12. MAINTENANCE	13
12.1. CLEANING	13
12.1.1. SPECIAL TOOLS, FIXTURE AND EQUIPMENT	13
12.1.2. PART REQUIREMENTS	13
12.1.3. MANUAL CLEANING	13
12.2. CHECKS	14
12.2.1. SPECIAL TOOLS, FIXTURE AND EQUIPMENT	14
12.2.2. VISUAL EXAMINATION	14
12.2.3. PERIODICAL CHECKS	15
12.2.4. DIMENSIONAL CHECKS	15
12.2.5. SPECIAL CHECKS SUMMARY	15
12.3. REPLACEMENT	15
12.3.1. REPLACEMENT PROCEDURES	15



GSE & TOOL USE AND MAINTENANCE MANUAL

Manual number:
MAN-3G6305G08731
REV. A

Pag. 4 of 18

13.	CALIBRATION	15
14.	SHELF LIFE	15
15.	SPARE PARTS	16
16.	CE MARKING.....	17
	ANNEX A.....	18

LIST OF TABLE

Table 1 – Warning Instruction	5
Table 2 – Applicable Documents.....	6
Table 3 – Warning Note.....	11
Table 4 – Visual Check.....	14
Table 5 – Spare Parts.....	17

LIST OF FIGURE

<i>Figure 1 – Blank kit, MGB.....</i>	<i>7</i>
<i>Figure 2 – LHD Identification tag with P/N</i>	<i>8</i>
<i>Figure 3 – Main Parts</i>	<i>9</i>
<i>Figure 4 – Safety Notes.....</i>	<i>12</i>
<i>Figure 5 – Spare Parts</i>	<i>16</i>

1. SCOPE

1.1. APPLICABILITY

The contents of this document are meant to provide information on the P/N 3G6305G08731 BLANK KIT, MGB.

1.2. OBJECT

The object of this document is to describe the AGE and its components, its main features and it will also provide all needed maintenance requirements to keep in service the P/N 3G6305G08731 BLANK KIT, MGB.

1.3. WARNING AND SAFETY INSTRUCTIONS

A number of symbols are used throughout this document to indicate information to which the user should pay attention to. These are indicated below along with the specific meaning.



 Warning	...Indicates a danger that might arise from a product and might result in severe injuries or even death, if no precautions are taken.
 Caution	... Indicates a potentially dangerous situation, which might result injury or damage to the equipment.
 Notice	...Indicates a note providing information to help the reader during the procedure.

Table 1 – Warning Instruction

	GSE & TOOL USE AND MAINTENANCE MANUAL	Manual number: MAN-3G6305G08731 REV. A
		Pag. 6 of 18

2. DOCUMENTS

2.1. APPLICABLE DOCUMENTS

The following table lists the applicable documents

REF	REFERENCE OF DOCUMENT	TITLE
N.A.	N.A.	N.A.

Table 2 – Applicable Documents

2.2. ACRONYMS USED

The main acronyms used in this document are listed below:

LHD	Leonardo Helicopter Division
HC	Helicopter
P/N	Part Number
S/N	Serial Number
N.A.	Not Applicable
ECS	Environmental Control System
HPS	Hydraulic Power Supply
MGB	Main Gearbox
T/R	Tail Rotor

3. DESCRIPTION

The tool is used to protect the main gear box in order to prevent contamination when, during maintenance activity the components are not immediately installed.

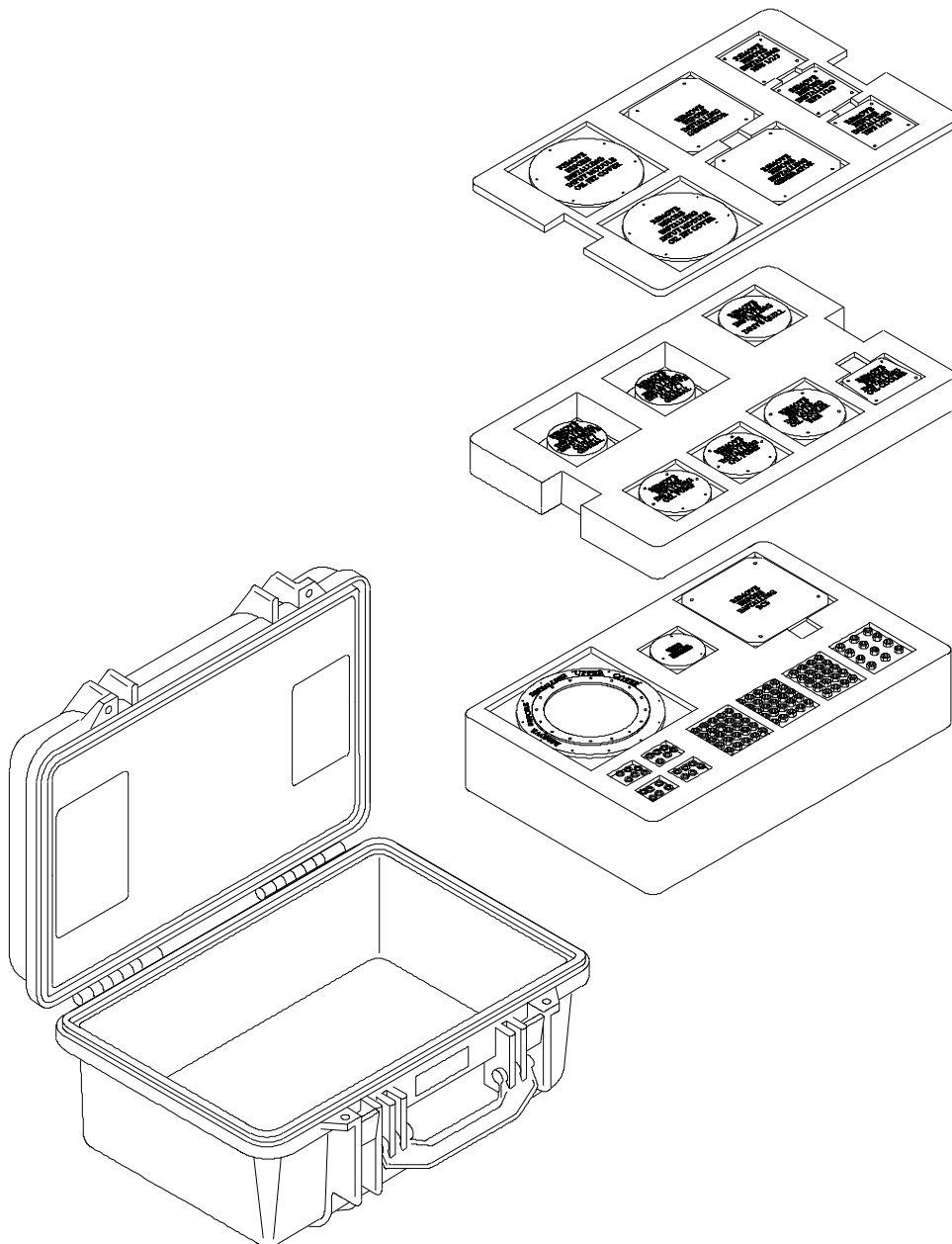

3G6305G08731_1

Figure 1 – Blank kit, MGB

	GSE & TOOL USE AND MAINTENANCE MANUAL	Manual number: MAN-3G6305G08731 REV. A
		Pag. 8 of 18

4. TOP ASSEMBLY DRAWINGS

Refer to P/N 3G6305G08731 BLANK KIT, MGB.

5. IDENTIFICATION

The tool identification P/N is marked on the LHD identification tag.

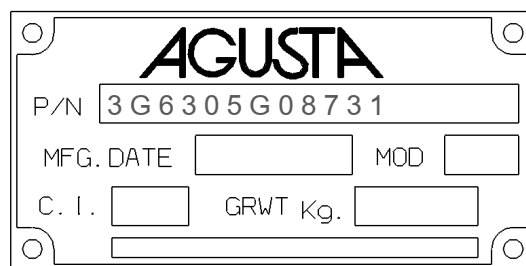

Figure 2 – LHD Identification tag with P/N

6. OVERALL DIMENSIONS

- Length: 860 mm
- Width: 560 mm
- Height: 355 mm

7. WEIGHT

- Total Weight: Not Available.

8. MAIN PARTS

LEVEL 1

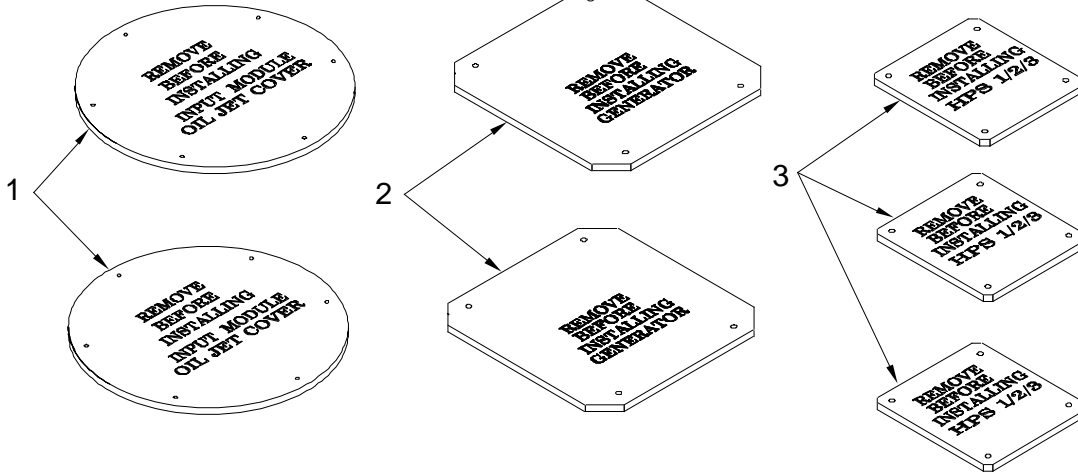

LEVEL 2

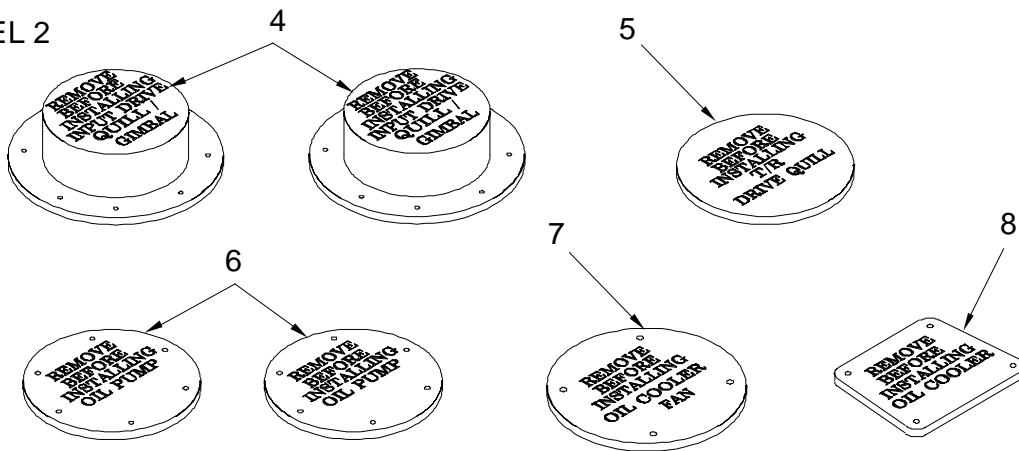

LEVEL 3

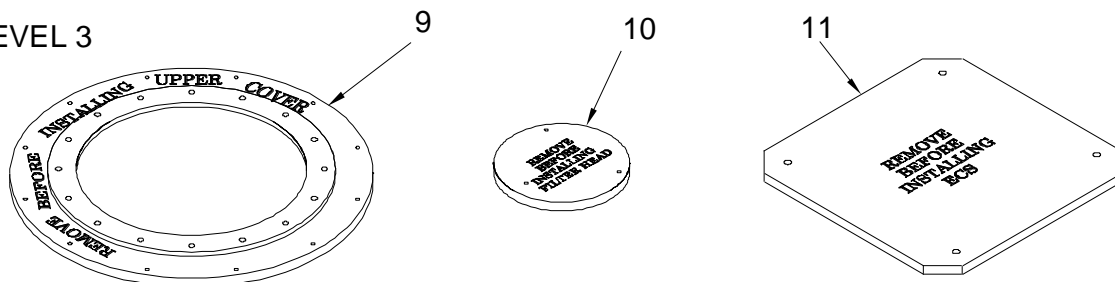

3G6305G08731_2

Figure 3 – Main Parts

	GSE & TOOL USE AND MAINTENANCE MANUAL	Manual number: MAN-3G6305G08731 REV. A <hr/> Pag. 10 of 18
---	--	---

The main parts of the BLANK KIT, MGB are allocated on three levels ([Figure 3](#))

In the first level there are:

1. Two covers for the MGB input module oil jet
2. Two covers for the MGB generator drive quill
3. Three covers for the MGB HPS 1/2/3.

In the second level there are:

4. Two covers for the MGB input drive quill/gimbal
5. A cover for the MGB T/R drive quill
6. Two covers for the MGB oil pump drive quill
7. A cover for the MGB oil cooler fan drive quill
8. A cover for the MGB oil cooler flange.

In the third level there are:

9. A cover for the MGB upper
10. A cover for the MGB filter head
11. A cover for the MGB ECS drive quill.

In the third level there are also the nuts and washers necessary to install the covers.

9. MAIN FEATURES DESCRIPTION

The kit, supplied in a suitable transportation box, is composed of blanking covers set allocated on three levels.

10. WARNING AND SAFETY NOTES

10.1. WARNING NOTE







 Warning	Use this equipment only for the purpose that it is designed for. Any other use can result in injury or serious material damage to the components.
 Caution	
 Notice	The Manual can never integrally replace the adequate competence of the user.
 Warning  Caution	Before and after each use of the equipment is necessary to perform the checks required. Do not operate with a tool damaged or partially completed, or partially assembled.
 Notice	This Manual provides guidelines and instructions of the equipment that are in addition to - but are not intended to replace or modify but only to integrate - any general or specific rule, regulation, decree or law that is in force in the place where the equipment is in use.

Table 3 – Warning Note

10.2. SAFETY NOTES

Remember to wear protective overalls, safety shoes, protective gloves and glasses during all operational and maintenance phases.



Figure 4 – Safety Notes

	GSE & TOOL USE AND MAINTENANCE MANUAL	Manual number: MAN-3G6305G08731 REV. A
		Pag. 13 of 18

11. STORAGE

The Tool shall be properly stored to provide protection from external weather conditions, damage and dirty particles.

The Kit shall be stored in the dedicated transportation box (part of the Kit).

Ensure that the tool parts are clean before storage.

11.1. LUBRICATION BEFORE STORAGE

N.A.

11.2. STORAGE CONFIGURATION

The tool has no particular storage configuration.

12. MAINTENANCE

NOTE: Correct regular maintenance allows preventing most faults and safeguards of tool performance in time, thereby making it last longer.

Every year carry out regular maintenance on a regular basis as detailed in this manual.

NOTE: Inspection intervals for tool parts placed inside in ready storage is 12 months.

12.1. CLEANING

Before inspection and after each use, carry out the cleaning of the tool components.

12.1.1. SPECIAL TOOLS, FIXTURE AND EQUIPMENT

No special tools, fixture and equipment are required for cleaning.

12.1.2. PART REQUIREMENTS

The parts to clean should be free from the moisture, emulsified water, soaps and metal shavings that can develop of corrosive acids.

They must also be free from wide grease and / or slosh deposits.

12.1.3. MANUAL CLEANING

- A. Clean thoroughly all metal surfaces with a clean lint-free cloth (Local supply) moistened with Cleaning Solvent (MIL-PRF-680C, Type II) to do general spot cleaning of large groups areas. For nylon or Teflon surfaces, the use of a biodegradable, water dilutable cleaning compound (MIL-PRF-87937 D, Type II) is required.
- B. Repeat the cleaning process again by means another clean lint-free cloth (Local supply).
- C. Drying.
 - Verify that the solvent should not be trapped in the cavity. Normally, the solvent evaporates at room temperature in a satisfactory manner.

12.2. CHECKS

Before and after each use or at least every year, carry out the check of kit component.

Before each use ensure that the manual is available to the operator, in the event of loss, request a copy to Leonardo Helicopters Division.

The Tool kit shall be submitted to following checks to guarantee the functionality.

All required checks shall be registered on CHECK RECORDS Table. Ref. *TLC_Table 1*

After each use of tool ensure to have registered the number of uses on HISTORICAL USES RECORD Table. Ref. *TLC_Table 2*

The Tool Log Card template contained in the Annex A of this manual can be replaced with any other log card template in use in the plant where the equipment is in use.

12.2.1. SPECIAL TOOLS, FIXTURE AND EQUIPMENT

No special tools, fixture and equipment are required for the checks.

12.2.2. VISUAL EXAMINATION

NOTE: Replace the parts that do not obey the inspection requirements.

Restore the marking of the parts that results damaged or not readable.

All required visual checks are listed on Table 4

PERIODICITY	CHECK TYPE	COMPONENTS
BEFORE AND AFTER EVERY USE	Evidence of impact;	All
	Crushing or stripping	All
	Cracks	All
	Dents	All
	Wear	All
	Distortions	All
	Corrosion	All
	Loose or defective attaching parts (warning flag)	All
	Unsticking of parts	Item 2, Plate, Figure 5 , page 16 Item 5, Nameplate, Figure 5 , page 16 Item 6, Nameplate, Figure 5 , page 16
	Damage to the threads	All threaded STD parts.
	Marking	All
	Damage to the pins and to the shell	N.A.
	Damage to the insulation sleeves and wires	N.A.

Table 4 – Visual Check



GSE & TOOL USE AND MAINTENANCE MANUAL

Manual number:
MAN-3G6305G08731
REV. A

Pag. 15 of 18

12.2.3. PERIODICAL CHECKS

Not Applicable.

12.2.4. DIMENSIONAL CHECKS

Not Applicable.

12.2.5. SPECIAL CHECKS SUMMARY

Not Applicable.

12.3. REPLACEMENT

All the parts for which it is allowed the components replacement are listed in Paragraph 15.

12.3.1. REPLACEMENT PROCEDURES

The replacement of parts of the kit does not require specific procedures.

13. CALIBRATION

No Calibration is required.

14. SHELF LIFE

Not Applicable.

15. SPARE PARTS

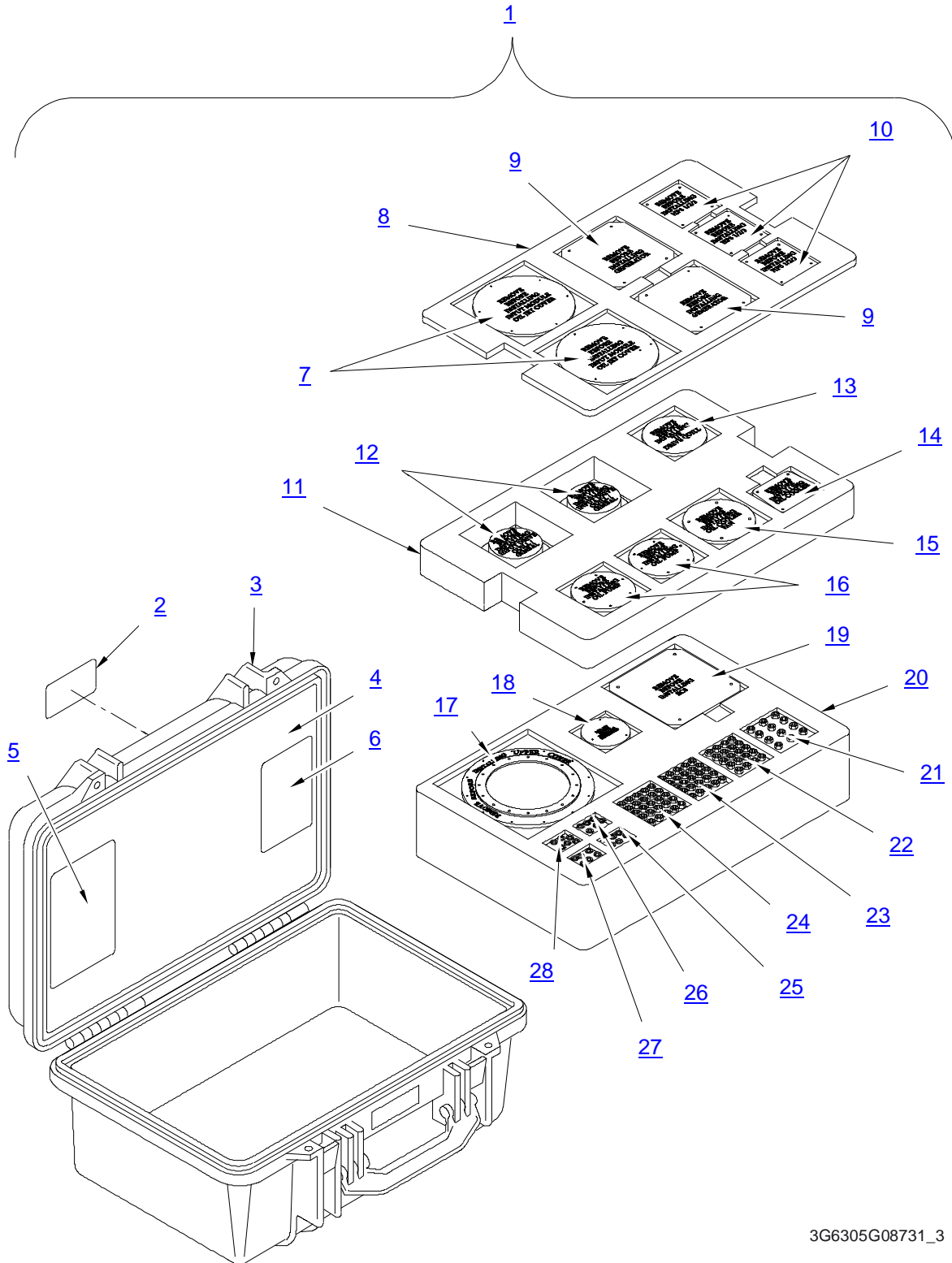

3G6305G08731_3

Figure 5 – Spare Parts

ITEM	P/N	DESCRIPTION	Q.TY
1	3G6305G08731	BLANK KIT, MGB	REF
2	A304A001A1	PLATE, IDENTIFICATION	1
3	7630.BE	SUITCASE	1
4	3G6305G08751	FOAM	1
5	3G0205G00163	NAMEPLATE	1
6	3G0205G00263	NAMEPLATE	1
7	3G6305G08851	BLANK, MGB INPUT MODULE OIL JET COVER	2
8	3G6305G09931	PANEL ASSY	1
9	3G6305G09851	BLANK, MGB GENERATOR DRIVE QUILL	2
10	3G6305G09751	BLANK, MGB HPS 1/2/3 DRIVE QUILL	3
11	3G6305G10031	PANEL ASSY	1
12	3G6305G09451	BLANK, MGB INPUT DRIVE QUILL/ GIMBAL	2
13	3G6305G08931	BLANK, MGB T/R DRIVE QUILL	1
14	3G6305G09151	BLANK, MGB OIL COOLER FLANGE	1
15	3G6305G09551	BLANK, MGB OIL COOLER FAN DRIVE QUILL	1
16	3G6305G09251	BLANK, MGB OIL PUMP DRIVE QUILL	2
17	3G6305G09331	BLANK, MGB UPPER COVER	1
18	3G6305G09051	BLANK, MGB FILTER HEAD	1
19	3G6305G09651	BLANK, MGB ECS DRIVE QUILL	1
20	3G6305G10131	PANEL ASSY	1
21	AN315C6R	NUT, PLAIN, HEXAGON	12
22	AN315C5R	NUT, PLAIN, HEXAGON	20
23	AN315C4R	NUT, PLAIN, HEXAGON	22
24	AN315C3R	NUT, PLAIN, HEXAGON	27
25	NAS1149C0563R	WASHER, FLAT	20
26	NAS1149C0463R	WASHER, FLAT	22
27	NAS1149C0663R	WASHER, FLAT	12
28	NAS1149C0363R	WASHER, FLAT	27

Table 5 – Spare Parts

16. CE MARKING

No CE marking is required for the P/N 3G6305G08731 BLANK KIT, MGB.



GSE & TOOL
USE AND MAINTENANCE MANUAL

Manual number:
MAN-3G6305G08731
REV. A

Pag. 18 of 18

ANNEX A

TOOL LOG CARD



TOOL LOG CARD

ISSUE -/
Pag. 1 of 3

TOOL KIT P/N: [1]	TOOL KIT DESCRIPTION: [2]	TOOL KIT S/N: [3]
TOOL P/N: [4]	TOOL S/N: [5]	REMARKS: [6]

Section 1: CHECKS RECORD

[7] N° check	[8] DATE	[9] P/N TO CHECK	[10] CHECK	[11] FREQUENCY	[12] RESULT	[13] NOTE	CERTIFICATION [14]
							STAMP & SIGNATURE [15]
1							
2							
3							
4							
5							
6							
7							
8							
9							
10							
FINAL ACCEPTANCE [16]							
STAMP & SIGNATURE [17]						DATE [18]	

TLC_Table 1



TOOL LOG CARD

ISSUE -/-
Pag. 2 of 3

TOOL KIT P/N: [1]	TOOL KIT DESCRIPTION: [2]	TOOL KIT S/N: [3]
TOOL P/N: [4]	TOOL S/N: [5]	REMARKS: [6]

Section 2: HISTORICAL USES RECORD

[19] N°USE	[8] DATE	[6] NOTE	[13] CERTIFICATION	[19] N°USE	[8] DATE	[6] NOTE	[13] CERTIFICATION
			[14] STAMP & SIGNATURE				[14] STAMP & SIGNATURE
1				11			
2				12			
3				13			
4				14			
5				15			
6				16			
7				17			
8				18			
9				19			
10				20			

TLC_Table 2

LOG CARD FILLING INSTRUCTIONS

FIELD #	HEADER	NOTE
1	Part number of the tool Kit	
2	Tool Kit denomination	
3	Serial Number of the tool Kit	
4	Part Number of the tool (part of kit)	
5	Serial Number of the tool (if applicable)	
6	Indicate any details of the use	
7	Sequential number of check performed	
8	Date of the activity	
9	PN of tool or component (part of tool) checked/affected by issue	
10	Typology or description of checks /issue	
11	Check frequency	
12	Check result	
13	Check remarks	
14	Performance certification	
15	Stamp and signature of the personnel which performs the check	
16	Section related to the final approval	
17	Stamp and signature of the personnel which performs the final approval	
18	Date on which the final check was made	
19	Sequential number of performed used of the tool	