

PRATT & WHITNEY CANADA
SERVICE BULLETIN

P&WC S.B. No. 28406R1

BULLETIN INDEX LOCATOR
72-51-01

TURBOSHAFT ENGINE
COMPRESSOR-TURBINE-DISC RETAINING NUT - REPLACEMENT OF
MODEL APPLICATION

PW206B2, PW206B3, PW206C, PW207C, PW207D1, PW207D2, PW207K

Compliance: CATEGORY 5

Summary: There is a possibility that the Compressor Turbine (CT) disk retaining nut was not torqued correctly at initial build of the engine. Replace CT disk retaining nut on affected engines.

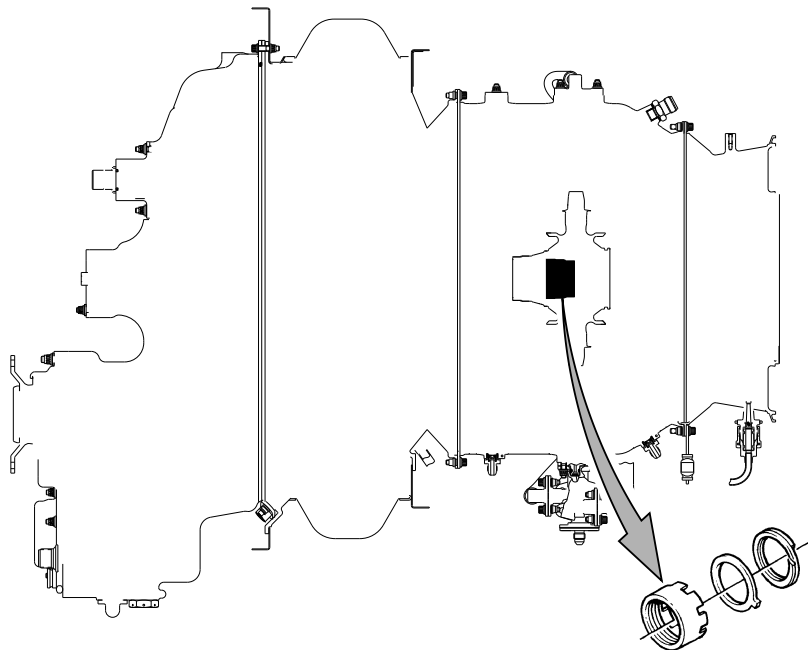

Dec 09/2022
Revision No. 1: Dec 15/2022

PW200-72-28406
Cover Sheet

24-Hour Global Service CFIRST CENTRE Toll free where available (SIL GEN-027)	USA & CANADA..... 1-800-268-8000 International (IAC*)+8000-268-8000 * International Access Code	Other 1-450-647-8000 Fax 1-450-647-2888 Web Site www.pwc.ca
---	---	---

WARNING - PROPRIETARY RIGHTS & EXPORT CONTROLS NOTICE

This bulletin contains proprietary information of Pratt & Whitney Canada Corp. ("P&WC"), which P&WC provides in confidence and solely for the purposes of supporting engine certification and providing applicable information regarding the proper use, maintenance, inspection, repair, servicing and parts application of P&WC products and services, as directed therein. Neither this bulletin nor any information in it may be disclosed to others, or used for any other purpose, including, without limitation, to design, create, develop, reproduce, manufacture or derive any design, part, product, material, process, modification, configuration change or repair, or obtain FAA or other government approval to do so. Possession and use of this bulletin is also subject to the restrictions set out in P&WC's Technical Data Agreement (a copy of which may be obtained by contacting P&WC Technical Publications). The contents of this bulletin may be subject to export control laws. Unauthorized export or re-export of the bulletin, or parts thereof, is prohibited. By accepting and possessing this bulletin, you agree to be bound by the foregoing terms.

If a Government agency or department intends to disclose any information, written notice should be given to:

VP - Legal Services, Pratt & Whitney Canada Corp., 1000 Marie-Victorin (01BE5), Longueuil, Quebec J4G 1A1.



Dec 15/2022

P&WC S.B. No. 28406R1

REVISION TRANSMITTAL SHEET
TURBOSHAFT ENGINE MODEL PW200

SUBJECT: Pratt & Whitney Canada Service Bulletin No. PW200-72-28406, Rev. No. 1 dated Dec 15/2022 (P&WC S.B. No. 28406R1) COMPRESSOR-TURBINE-DISC RETAINING NUT - REPLACEMENT OF

Replace your existing copy of this service bulletin with the attached revised bulletin. Destroy the superseded copy.

Please retain this Revision Transmittal Sheet with the revised bulletin.

SUMMARY:

This revision is issued to:

- remove the PW207D and add the PW207C on the Title page.

EFFECT OF REVISION ON PRIOR ACCOMPLISHMENT:

None.

REVISION HISTORY:

Original Issue: Jan 00/0000

Revision No. 1: Dec 15/2022

PRATT & WHITNEY CANADA
SERVICE BULLETIN

P&WC S.B. No. 28406R1

TURBOSHAFT ENGINE
COMPRESSOR-TURBINE-DISC RETAINING NUT - REPLACEMENT OF

1. Planning Information

A. Effectivity

PW206B2 Post SBA28280 Engines Serial No. PCE-BJ1464, PCE-BJ1469 and PCE-BJ1471.

PW206B3 Post SBA28280 Engines Serial No. PCE-BR0161, PCE-BR0180, PCE-BR0191 and PCE-BR0195.

PW206C Post SBA28280 Engines Serial No. PCE-BC1014 and PCE-BC1015.

PW207C Post SBA28280 Engines Serial No. PCE-BH1064, PCE-BH1065, PCE-BH1068 and PCE-BH1070.

PW207D1 Post SBA28280 Engines Serial No. PCE-BL0879, PCE-BL0880, PCE-BL0884, PCE-BL0896, PCE-BL0919, PCE-BL0920, PCE-BL0941, PCE-BL0948 and PCE-BL0956.

PW207D2 Post SBA28280 Engines Serial No. PCE-BN0029.

PW207K Post SBA28280 Engines Serial No. PCE-BK0341, PCE-BK0375 and PCE-BK0383.

NOTE: The above effectivity list does not identify engines that have been converted from one engine model to another via an engine conversion service bulletin. To clarify the effectivity of converted engines, refer to the original engine effectivity above. For the parts embodied during the engine conversion, refer to conversion service bulletin.

B. Concurrent Requirements

None.

C. Reason

(1) Problem

There is a possibility that the CT disk is not correctly seated.

(2) Cause

The CT disk retaining nut may be installed with a torque lower than required.

(3) Solution

Replace the CT disk retaining nut with a new one.

D. Description

Remove and replace the CT disk retaining nut with a new one.

P&WC No. EC-0078733

Dec 09/2022

Revision No. 1: Dec 15/2022

P&WC Proprietary Information. Subject to the restrictions on the back of the locator

© 2022 Pratt & Whitney Canada Corp.

PRINTED IN CANADA

PW200-72-28406

Page 1 of 4

PRATT & WHITNEY CANADA
SERVICE BULLETIN

P&WC S.B. No. 28406R1

TURBOSHAFT ENGINE
COMPRESSOR-TURBINE-DISC RETAINING NUT - REPLACEMENT OF

1. Planning Information (Cont'd)

E. Compliance

CATEGORY 5 - P&WC recommends to do this service bulletin when the engine is disassembled and access is available to the necessary subassembly (i.e. module, accessories, components, or build groups). Do all spare subassemblies.

F. Approval

The technical content of this document is approved under the authority of the Transport Canada Civil Aviation (TCCA) Design Approval Organization No: DAO #93-Q-01.

G. Manpower

Once you have access to the part, an estimate of XXX man-hours is required to include this service bulletin at repair.

No more man-hours are necessary to include this service bulletin at overhaul.

H. Weight and Balance

None.

I. Electrical Load Data

Not applicable.

J. Software Accomplishment Summary

Not applicable.

K. References

Illustrated Parts Catalog P/N [3054928](#) (PW206B2/206B3)

Illustrated Parts Catalog P/N [3043324](#) (PW206C)

Illustrated Parts Catalog P/N [3054927](#) (PW207C)

Illustrated Parts Catalog P/N [3071604](#) (PW207D1/207D2)

Illustrated Parts Catalog P/N [3053374](#) (PW207K)

Maintenance Manual P/N [3039732](#) (PW206B/206B2/206B3)

PRATT & WHITNEY CANADA
SERVICE BULLETIN

P&WC S.B. No. 28406R1

TURBOSHAFT ENGINE
COMPRESSOR-TURBINE-DISC RETAINING NUT - REPLACEMENT OF

1. Planning Information (Cont'd)

Maintenance Manual P/N [3043322](#) (PW206C/207C)

Maintenance Manual P/N [3071602](#) (PW207D1/207D2)

Maintenance Manual P/N [3053372](#) (PW207K)

Overhaul Manual P/N [3039733](#) (PW206B/206B2/206B3)

Overhaul Manual P/N [3043323](#) (PW206C/207C)

Overhaul Manual P/N [3071603](#) (PW207D1/207D2)

Overhaul Manual P/N [3053373](#) (PW207K)

L. Publications Affected

Not applicable.

M. Interchangeability and Intermixability of Parts

Not applicable.

2. Material Information

A. Industry Support Information

Not applicable.

B. Material - Price and Availability

Not applicable.

C. Material Necessary for Each Engine

Not applicable.

D. Reidentified Parts

None.

E. Tooling - Price and Availability

Not Applicable

PRATT & WHITNEY CANADA
SERVICE BULLETIN

P&WC S.B. No. 28406R1

TURBOSHAFT ENGINE
COMPRESSOR-TURBINE-DISC RETAINING NUT - REPLACEMENT OF

3. Accomplishment Instructions

- A. Remove Post SB SBA28280 retaining nut P/N 3072307-01, Key Washer P/N 3072308-01 and discard, in accordance with the maintenance or overhaul manual instructions as follows:

Ref. MM 72-00-31 Heavy Maintenance.

Ref. OHM 72-03-00 Disassembly.

- B. Install new Post SB SBA28280 retaining nut P/N 3072307-01 and new Key Washer P/N 3072308-01, in accordance with the maintenance or overhaul manual instructions as follows:

Ref. MM 72-00-31 Heavy Maintenance.

Ref. OHM 72-03-00 Assembly.

- C. Write the accomplishment of P&WC S.B. No. 28406 in the applicable engine module log book.

4. Appendix

Not applicable.