



Airworthiness Directive

AD No.: 2020-0191

Issued: 04 September 2020

Note: This Airworthiness Directive (AD) is issued by EASA, acting in accordance with Regulation (EU) 2018/1139 on behalf of the European Union, its Member States and of the European third countries that participate in the activities of EASA under Article 129 of that Regulation.

This AD is issued in accordance with Regulation (EU) 748/2012, Part 21.A.3B. In accordance with Regulation (EU) 1321/2014 Annex I, Part M.A.301, the continuing airworthiness of an aircraft shall be ensured by accomplishing any applicable ADs. Consequently, no person may operate an aircraft to which an AD applies, except in accordance with the requirements of that AD, unless otherwise specified by the Agency [Regulation (EU) 1321/2014 Annex I, Part M.A.303] or agreed with the Authority of the State of Registry [Regulation (EU) 2018/1139, Article 71 exemption].

Design Approval Holder's Name:

LEONARDO S.p.A.

Type/Model designation(s):

AB139 and AW139 helicopters

Effective Date: 11 September 2020

TCDS Number(s): EASA.R.006

Foreign AD: Not applicable

Supersedure: None

ATA 25 – Equipment / Furnishings – Forward Facing Central Seat(s) – Removal

Manufacturer(s):

Leonardo S.p.A. Helicopters, formerly Finmeccanica S.p.A, AgustaWestland S.p.A., Agusta S.p.A.; and AgustaWestland Philadelphia Corporation, formerly Agusta Aerospace Corporation

Applicability:

AB139 and AW139 helicopters, serial number (s/n) 31400 to 31882 inclusive, and s/n 41300 to 41570 inclusive, if a passenger cabin floor is installed, composed of three panels, and having the first row central seat(s) facing forward.

Definitions:

For the purpose of this AD, the following definitions apply:

Affected seats: First row central seats, as identified by configuration in Figures 1 to 6 (inclusive) of the ASB.

The ASB: Leonardo Alert Service Bulletin (ASB) 139-633 Revision A.

Reason:

A design deficiency has been identified, affecting some specific main cabin floor panel installations on AB139 and AW139 helicopters.

This condition, if not corrected, could, in case of an emergency landing, lead to failure of the affected seats, as defined in this AD, possibly resulting in injury to helicopter occupants.

To address this potential unsafe condition, as a temporary measure, until an improved cabin floor panel design solution is made available, Leonardo identified the affected configurations and helicopters, and published the ASB, providing seat removal instructions.

For the reasons described above, this AD requires removal of the affected seat(s).

This AD is considered to be an interim action and further AD action may follow.

Required Action(s) and Compliance Time(s):

Required as indicated, unless accomplished previously:

Removal:

- (1) Within 50 flight hours after the effective date of this AD, remove the affected seat(s), as defined in the AD, from the helicopter in accordance with the instructions of the ASB.

Alternative Seating Arrangement:

- (2) As an alternative to the seat(s) removal as required by paragraph (1) of this AD, for configurations which require the removal of two seats, it is acceptable to modify the helicopter to a different approved seating configuration in order to remove only one seat in accordance with the instructions of the ASB.

Credit:

- (3) Removal of affected seat(s) on a helicopter, accomplished before the effective date of this AD in accordance with the instructions of Leonardo ASB 139-633 at original issue, is an acceptable method to comply with the requirements of paragraph (1) of this AD for that helicopter, provided the resulting seating configuration is confirmed to be in accordance with Figure 9 to 13, as applicable, of the ASB.
- (4) Modification of a helicopter to a different approved seating configuration in order to remove only one seat, accomplished before the effective date of this AD in accordance with the instructions of Leonardo ASB 139-633 at original issue, is an acceptable method to comply with the alternative seating arrangement as specified in paragraph (2) of this AD for that helicopter, provided the resulting seating configuration is confirmed to be in accordance with Figure 9 to 13, as applicable, of the ASB.

Ref. Publications:

Leonardo S.p.A. Helicopters ASB 139-633 original issue dated 05 August 2020 and Revision A dated 02 September 2020.

The use of later approved revisions of the above-mentioned document is acceptable for compliance with the requirements of this AD.



Remarks:

1. If requested and appropriately substantiated, EASA can approve Alternative Methods of Compliance for this AD.
2. Based on the required actions and the compliance time, EASA have decided to issue a Final AD with Request for Comments, postponing the public consultation process until after publication.
3. Enquiries regarding this AD should be referred to the EASA Programming and Continued Airworthiness Information Section, Certification Directorate. E-mail: ADs@easa.europa.eu.
4. Information about any failures, malfunctions, defects or other occurrences, which may be similar to the unsafe condition addressed by this AD, and which may occur, or have occurred on a product, part or appliance not affected by this AD, can be reported to the [EU aviation safety reporting system](#). This may include reporting on the same or similar components, other than those covered by the design to which this AD applies, if the same unsafe condition can exist or may develop on an aircraft with those components installed. Such components may be installed under an FAA Parts Manufacturer Approval (PMA), Supplemental Type Certificate (STC) or other modification.
5. For any question concerning the technical content of the requirements in this AD, please contact: Leonardo S.p.A. Helicopters. E-mail: cse.aw139.AW@leonardocompany.com.



SERVICE BULLETIN**N° 139-633****ALERT****DATE:** August 5, 2020**REV. :** A - September 2, 2020

TITLE**ATA 25 – RESTRICTION IN FORWARD FACING PASSENGER SEATS INSTALLATION****REVISION LOG**

Helicopters that have complied with the first issue of this Service Bulletin have to check Figure 9 of Rev.A, to verify the correct seats configuration.

Revision A of this Service Bulletin has been developed to introduce kit P/N 3G2520F00611 (shown in newly added figures 1 and 8) among the affected configurations. Moreover, the illustration of “kit P/N 3G2520F00711 – REMOVAL” in Figure 9 has been changed, to amend a graphical error.

Revision bars on the outer margin identify changes.

1. PLANNING INFORMATION

A. EFFECTIVITY

AW139 helicopters from S/N 31400 to S/N 31882 and from S/N 41300 to S/N 41570, equipped with passenger cabin floor composed by three panels and installing the 1st row central seat/seats FWD facing.

NOTE

Affected seats configurations are shown in Figures 1 thru 6. The number of passenger cabin floor panels can be identified through the number of rivets rows at STA 4803 as shown in Figure 7:

- n°1 rivets row identifies a TWO panels floor;
- n°2 rivets rows identify a THREE panels floor.

B. COMPLIANCE

Within and not later than fifty (50) FH after the issue of this Service Bulletin.

C. CONCURRENT REQUIREMENTS

N.A.

D. REASON

This Service Bulletin is issued to interdict the utilization of the central seats of the passenger cabin FWD facing 1st row.

E. DESCRIPTION

In order to prevent possible structural damages on the floor middle panel in case of an emergency landing, Leonardo Helicopter Division has developed this Service Bulletin to prescribe the removal of the forward facing central seat/seats of all the affected cabin configurations. This is a temporary restriction until an improved solution will be introduced as terminating action.

F. APPROVAL

The technical content of this Service Bulletin is approved under the authority of DOA nr. EASA.21.J.005. For helicopters registered under other Aviation Authorities, before applying the Service Bulletin, applicable Aviation Authority approval must be checked within Leonardo Helicopters customer portal.

EASA states mandatory compliance with inspections, modifications or technical directives and related time of compliance by means of relevant Airworthiness Directives. If an aircraft listed in the effectivity embodies a modification or repair not LHD certified and affecting the content of this Service Bulletin, it is responsibility of the Owner/Operator to obtain a formal approval by Aviation Authority having jurisdiction on the aircraft, for any adaptation necessary before incorporation of the present Service Bulletin.

G. MANPOWER

To comply with this Service Bulletin one (1) MMH is deemed necessary. MMH are based on hands-on time and can change with personnel and facilities available.

H. WEIGHT AND BALANCE

Refer to RFM Supplements 38 and 39 Section 6 in order to have information to update the Chart A in accordance with the relevant cabin seat configuration.

I. REFERENCES

1) PUBLICATIONS

<u>DATA MODULE</u>	<u>DESCRIPTION</u>	<u>PART</u>
DM01 39-A-00-20-00-00A-120A-A	Helicopter on ground for a safe maintenance	-

2) ACRONYMS

AMP	Aircraft Maintenance Publication
DM	Data Module
DOA	Design Organization Approval
EASA	European Aviation Safety Agency
LHD	Leonardo Helicopters Division
MMH	Maintenance-Man-Hours

3) ANNEX

N.A.

J. PUBLICATIONS AFFECTED

N.A.

K. SOFTWARE ACCOMPLISHMENT SUMMARY

N.A.

2. MATERIAL INFORMATION

A. REQUIRED MATERIALS

1) PARTS

N.A.

2) CONSUMABLES

N.A.

3) LOGISTIC MATRIX

N.A.

B. SPECIAL TOOLS

N.A.

C. INDUSTRY SUPPORT INFORMATION

N.A.

3. ACCOMPLISHMENT INSTRUCTIONS

GENERAL NOTES

Place an identification tag on all components that are re-usable, including the attaching hardware that has been removed to gain access to the modification area and adequately protect them until their later re-use.

1. In accordance with AMP DM 39-A-00-20-00-00A-120A-A prepare the helicopter on ground for a safe maintenance. Disconnect the battery, all electrical power sources and/or the external power supply.

NOTE

For configurations which require the removal of two seats, it is possible to switch to a different allowed configuration in order to remove only one seat.

2. With reference to Figures 8 thru 13 and in accordance with AMP Section 25 applicable DM, remove the indicated 1st row central seat/seats (marked with a red X in the Figures).
3. In accordance with weight and balance changes, update the Chart A (see Rotorcraft Flight Manual, Part II, section 6).
4. Return the helicopter to flight configuration and record for compliance with this Service Bulletin on the helicopter logbook.
5. Send the attached compliance form to the following mail box:

engineering.support.lhd@leonardocompany.com

As an alternative, gain access to My Communications section on Leonardo WebPortal and compile the "Service Bulletin Application Communication".

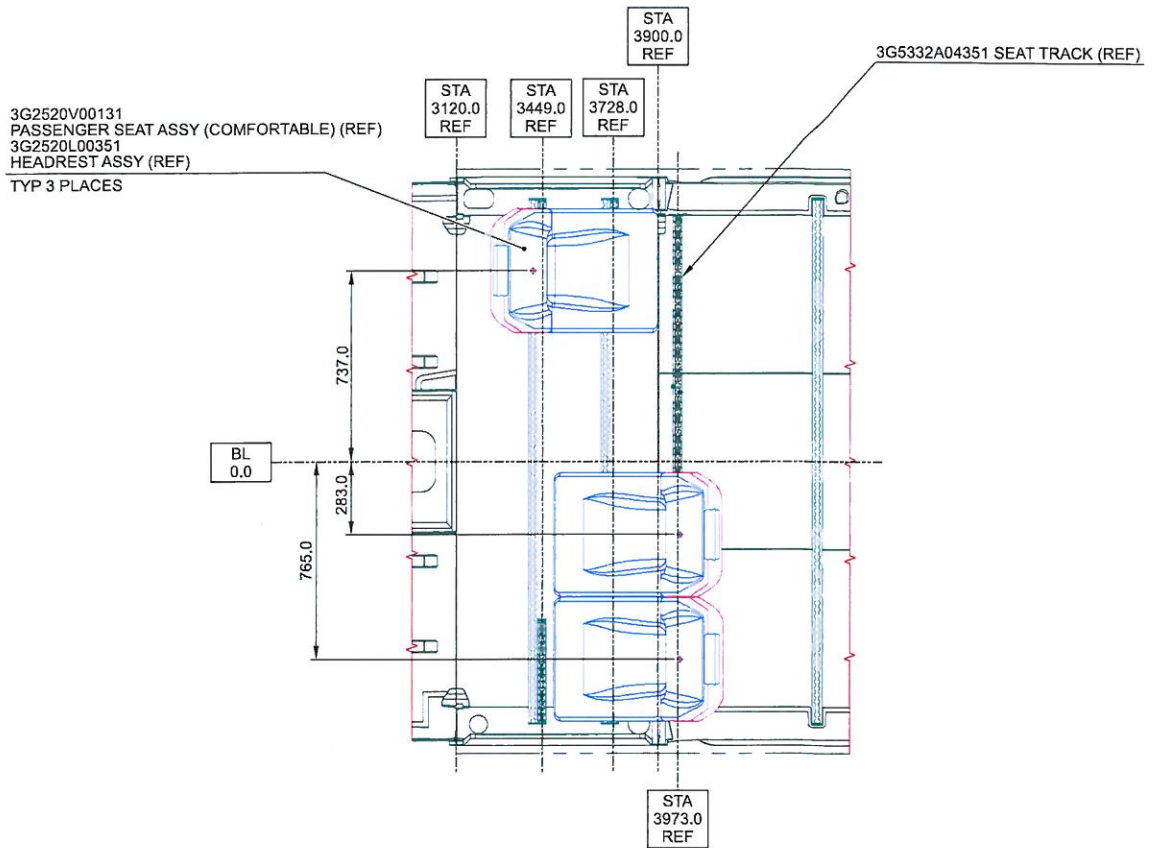

FWD FACING ROW SEATS KIT P/N 3G2520F00611
CONFIGURATION A

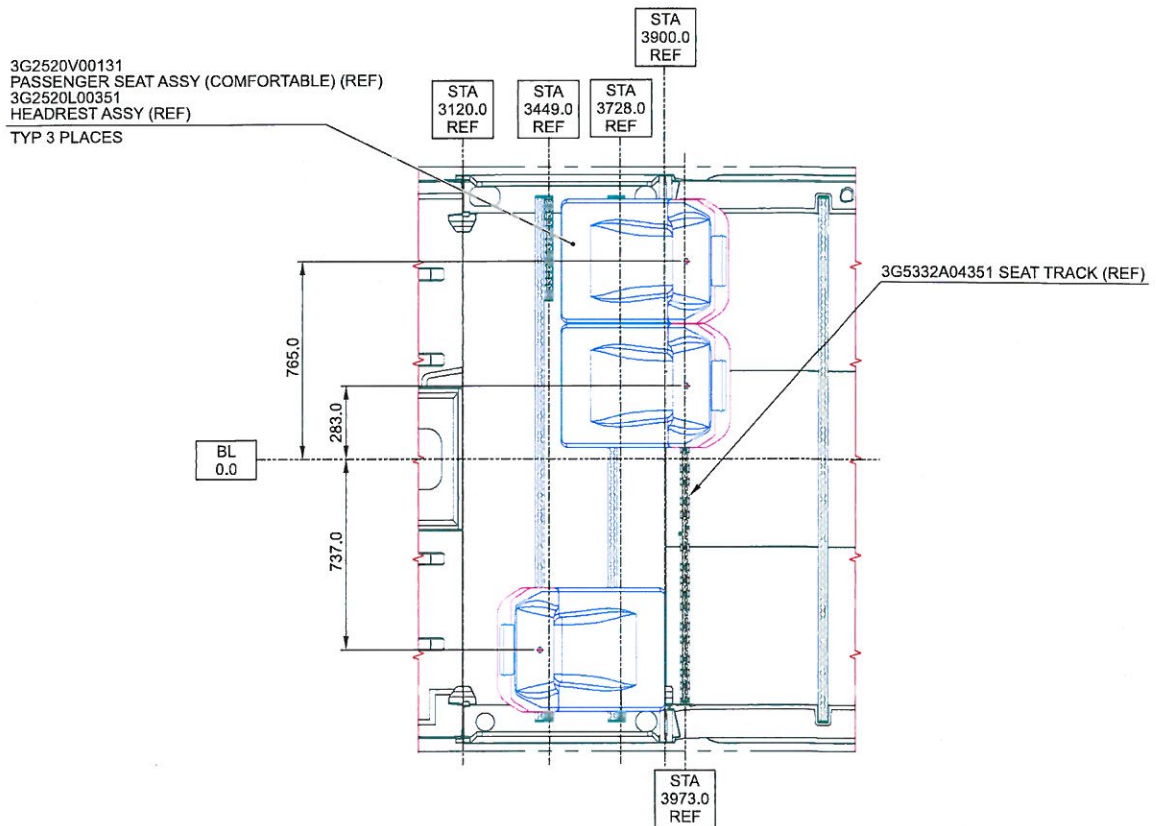

FWD FACING ROW SEATS KIT P/N 3G2520F00611
CONFIGURATION B

Figure 1

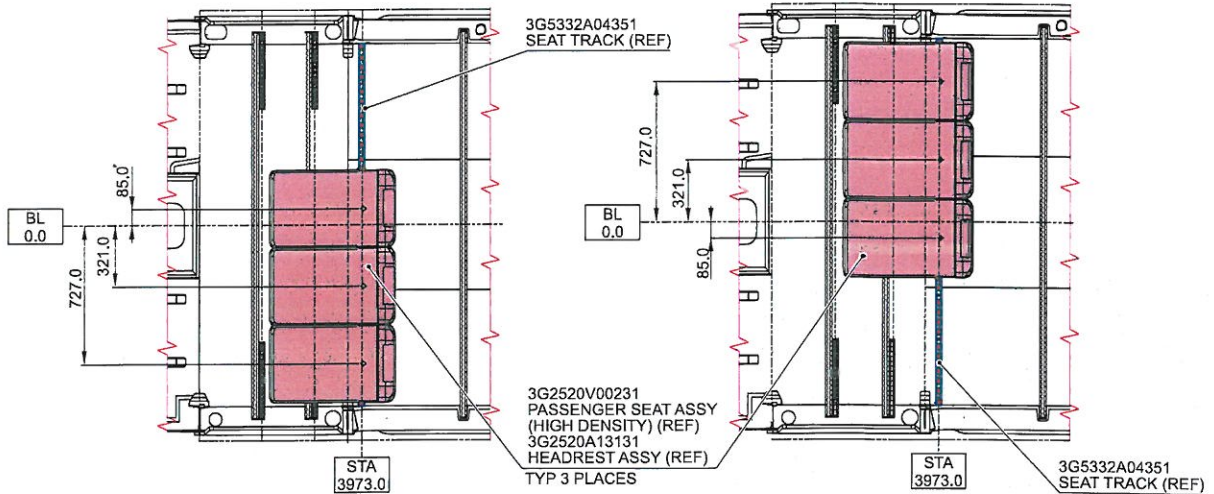

KIT FWD SEATS P/N 3G2520F00711
NORMAL INSTL

KIT FWD SEATS P/N 3G2520F00711
SYMMETRICAL INSTL

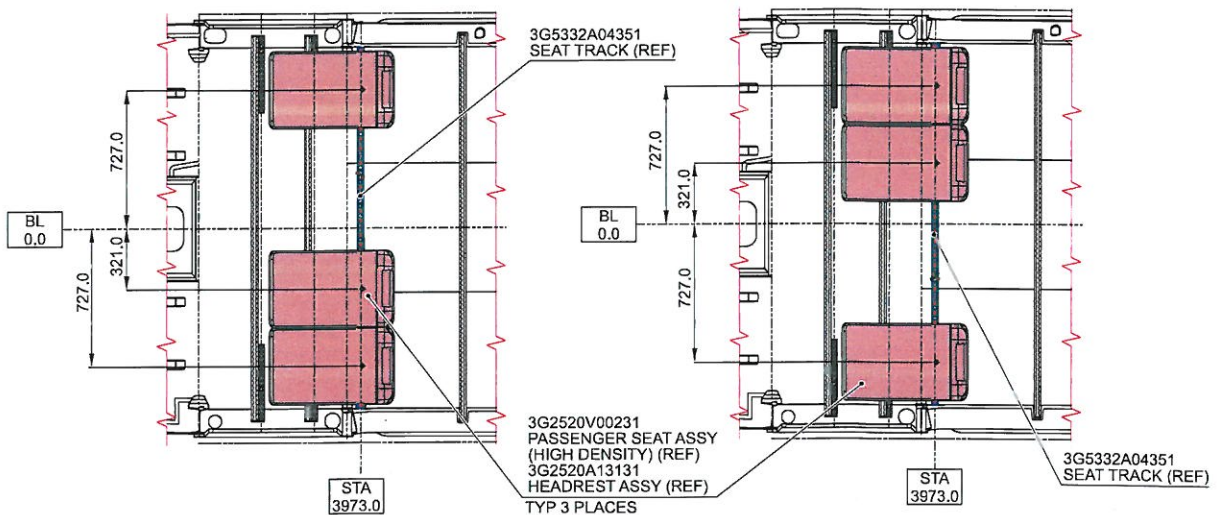

KIT FWD SEATS P/N 3G2520F00712
NORMAL INSTL

KIT FWD SEATS P/N 3G2520F00712
SYMMETRICAL INSTL

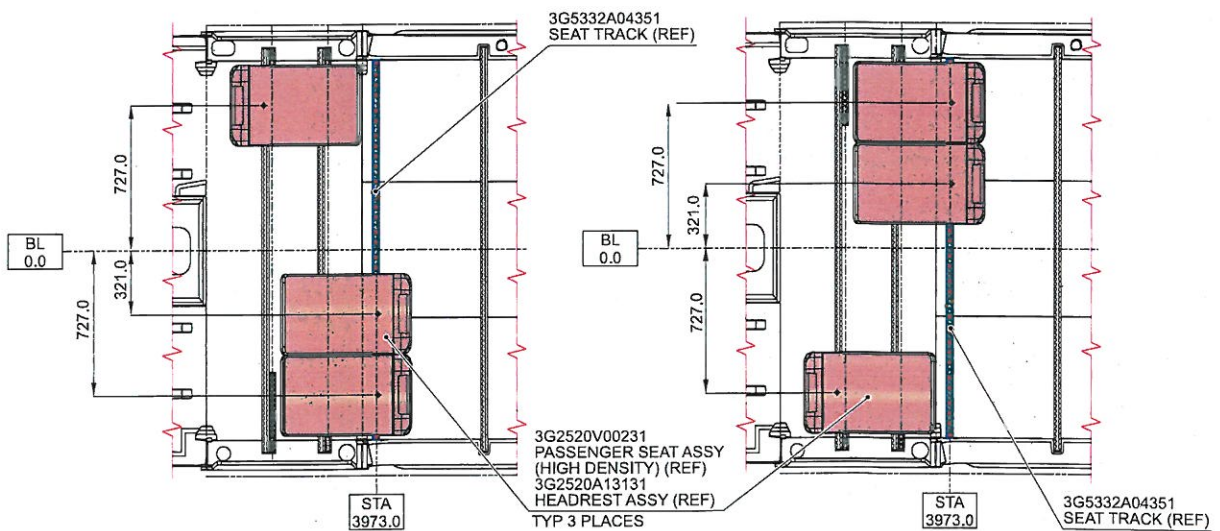

KIT FWD SEATS P/N 3G2520F00713
NORMAL INSTL

KIT FWD SEATS P/N 3G2520F00713
SYMMETRICAL INSTL

Figure 2

S.B. N°139-633

DATE: August 5, 2020

REVISION: A - September 2, 2020

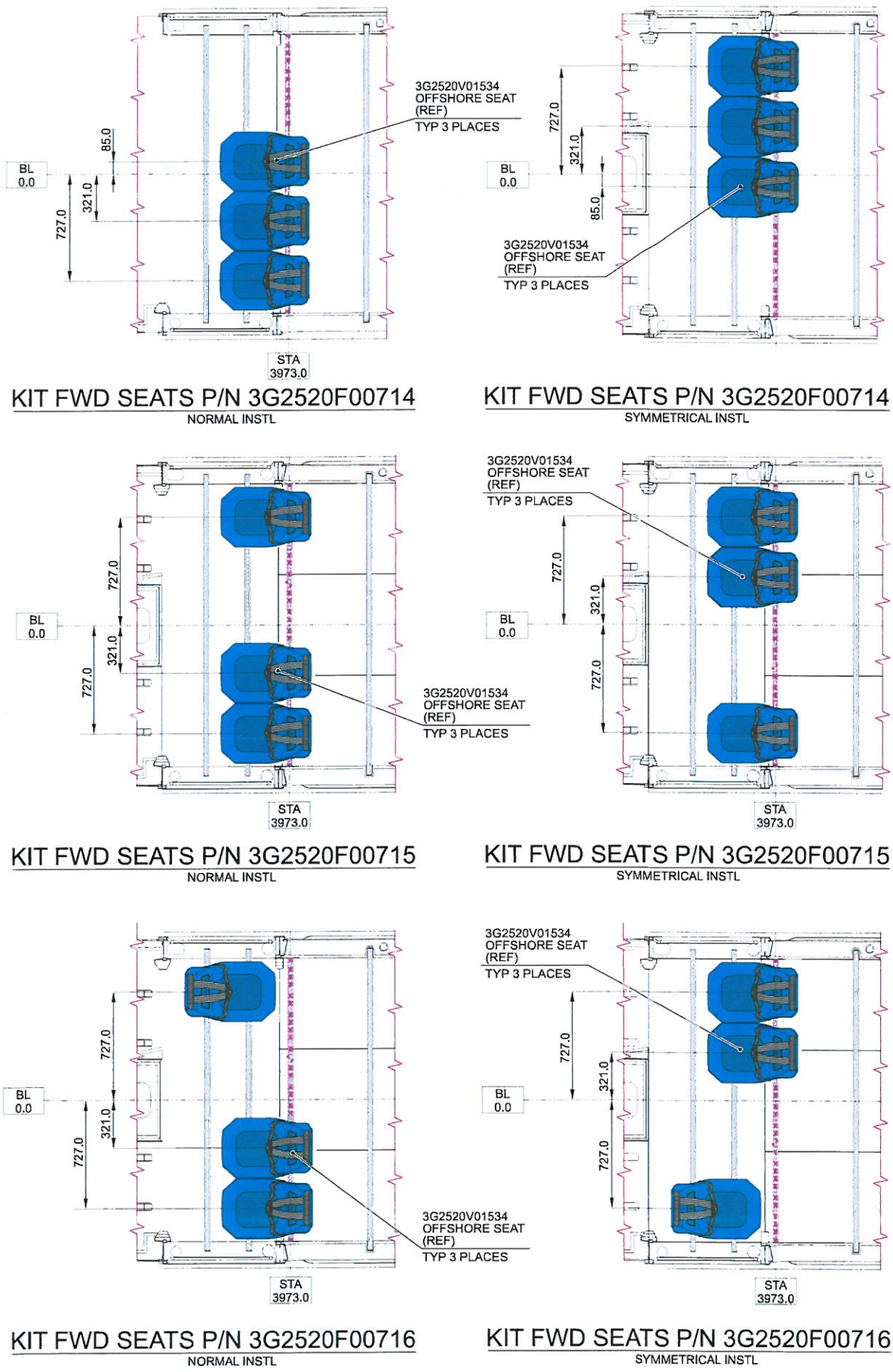
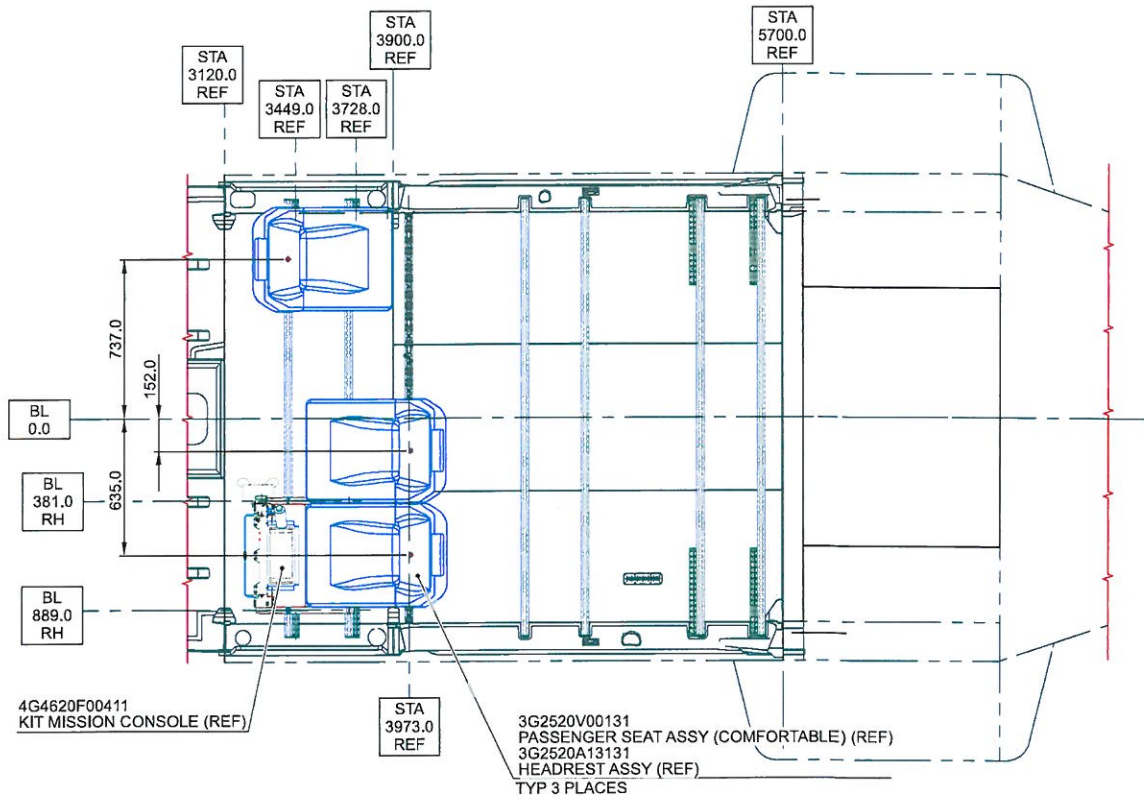
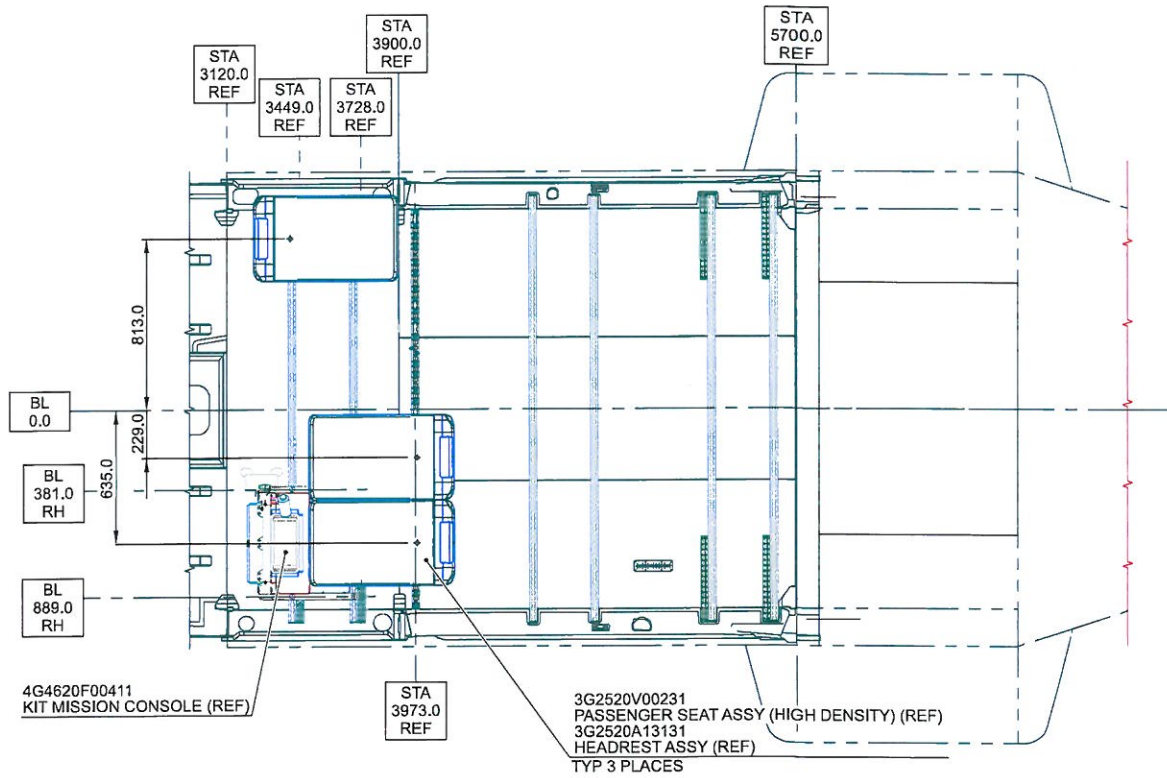

Figure 3



CABIN SEAT KIT P/N 3G2520F00811

Figure 4



CABIN SEAT KIT P/N 3G2520F00912

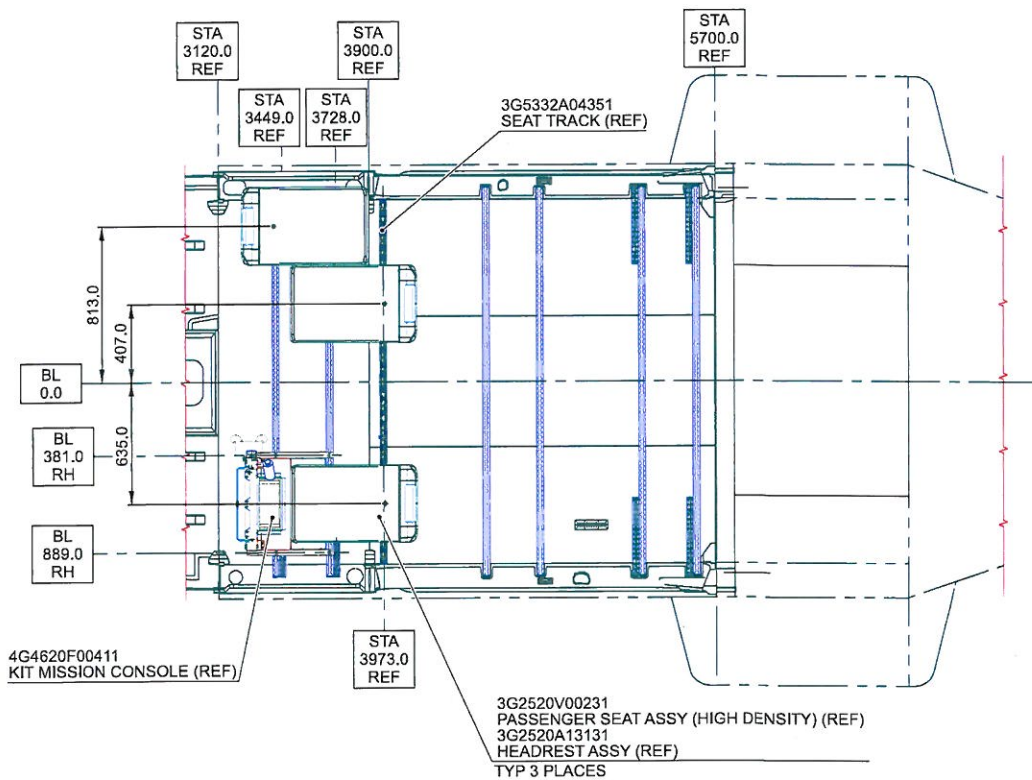

CABIN SEAT KIT P/N 3G2520F00913

Figure 5

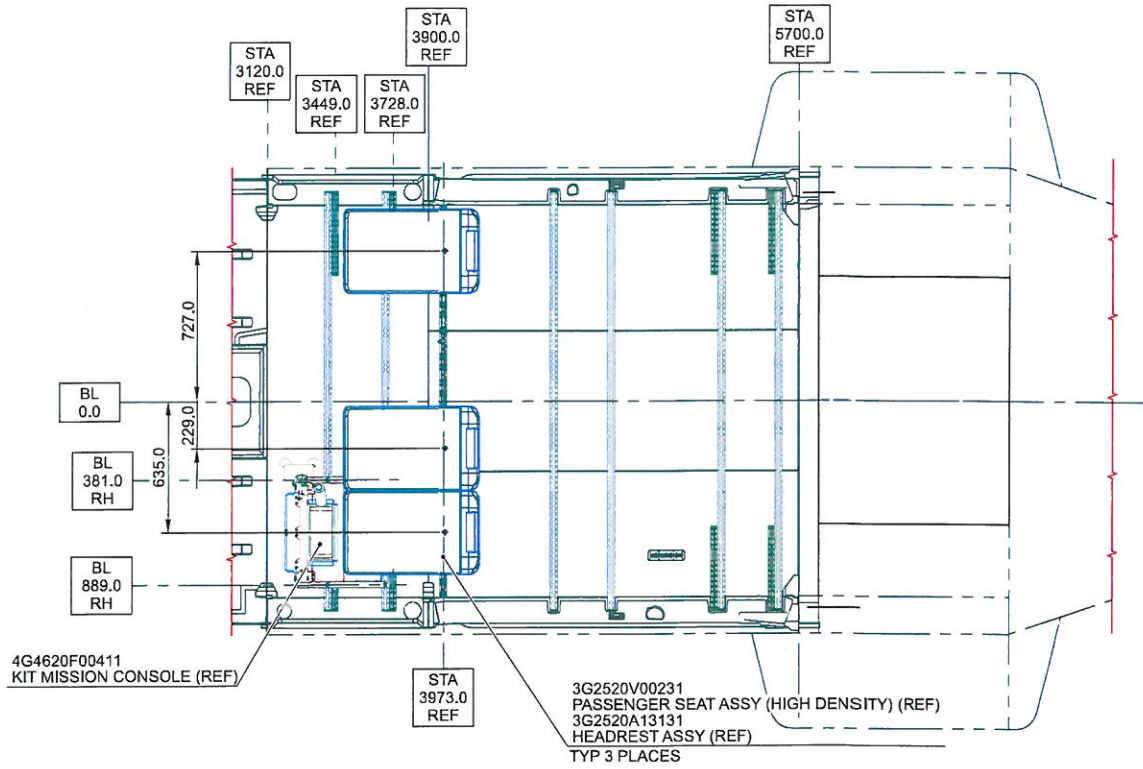

CABIN SEAT KIT P/N 3G2520F00914

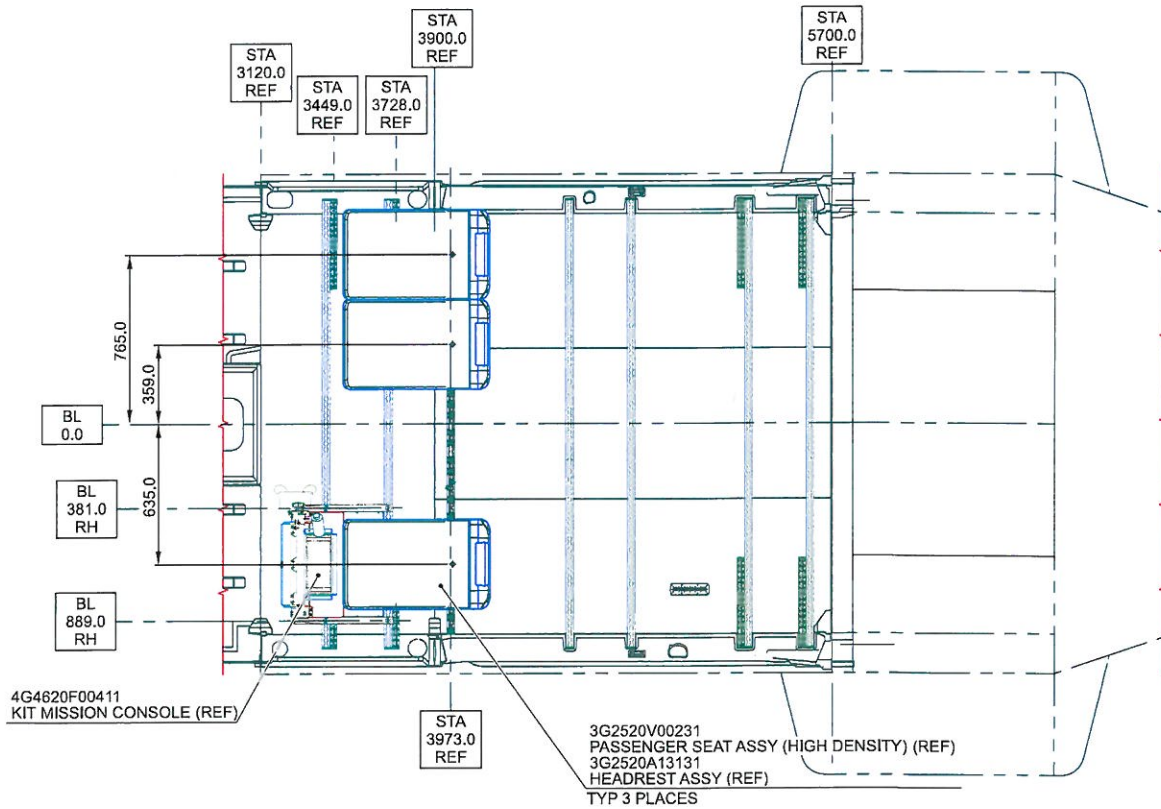

CABIN SEAT KIT P/N 3G2520F00915

Figure 6

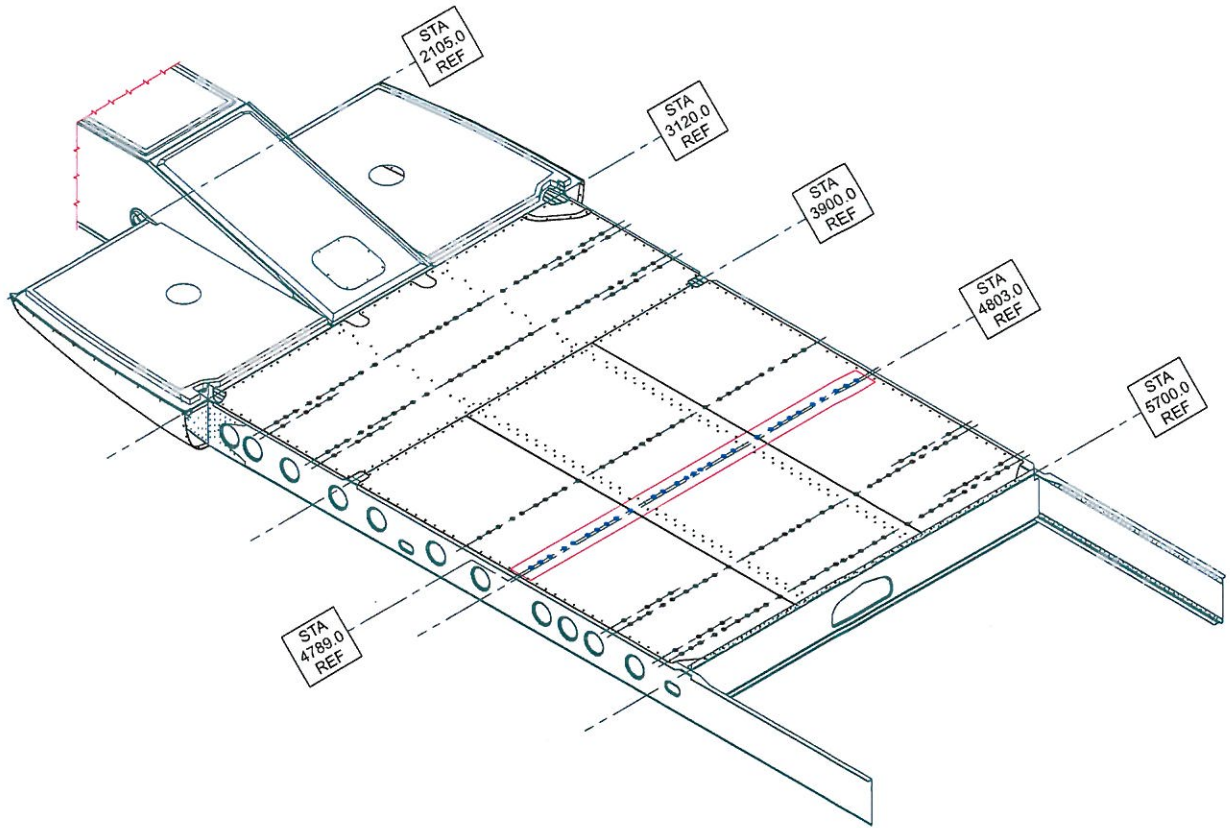

FLOORS WITH TWO PANELS
ISOMETRIC VIEW

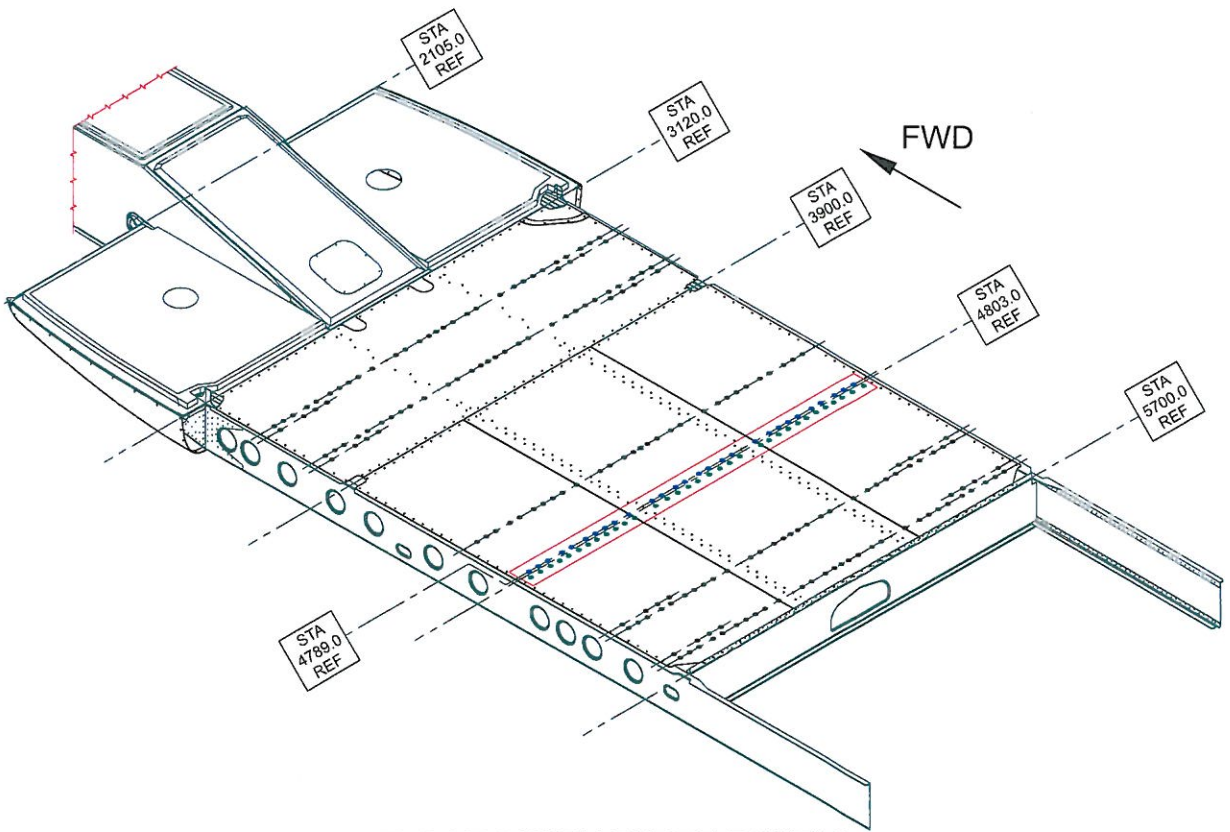

FLOORS WITH THREE PANELS
ISOMETRIC VIEW

Figure 7

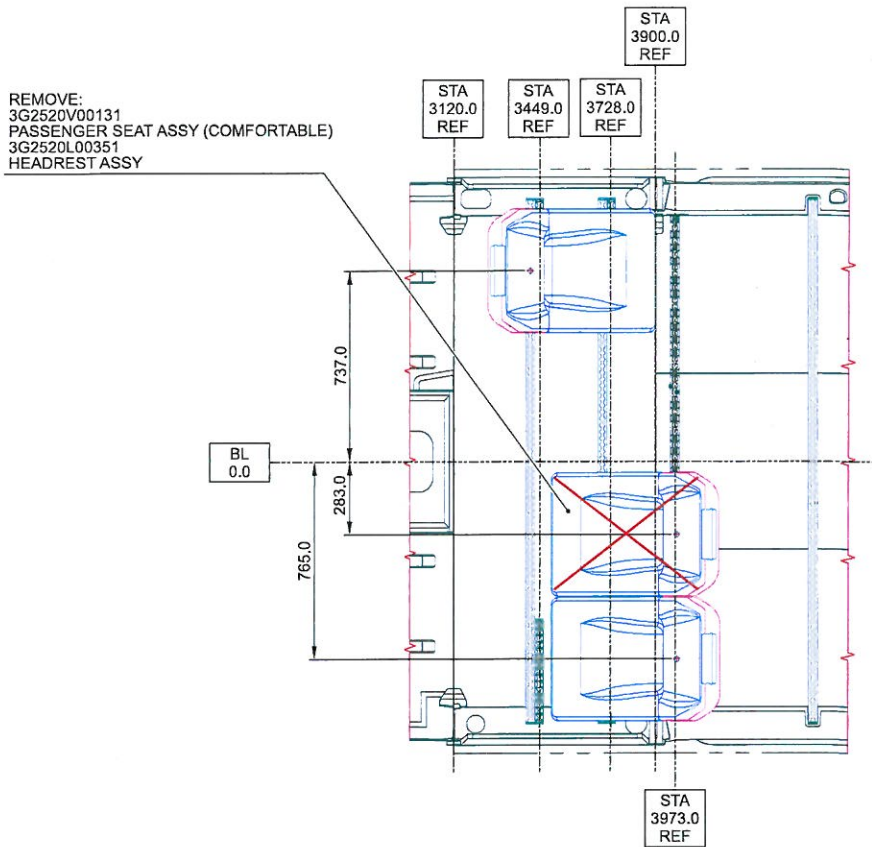

FWD FACING ROW SEATS KIT P/N 3G2520F00611 - REMOVAL

CONFIGURATION A

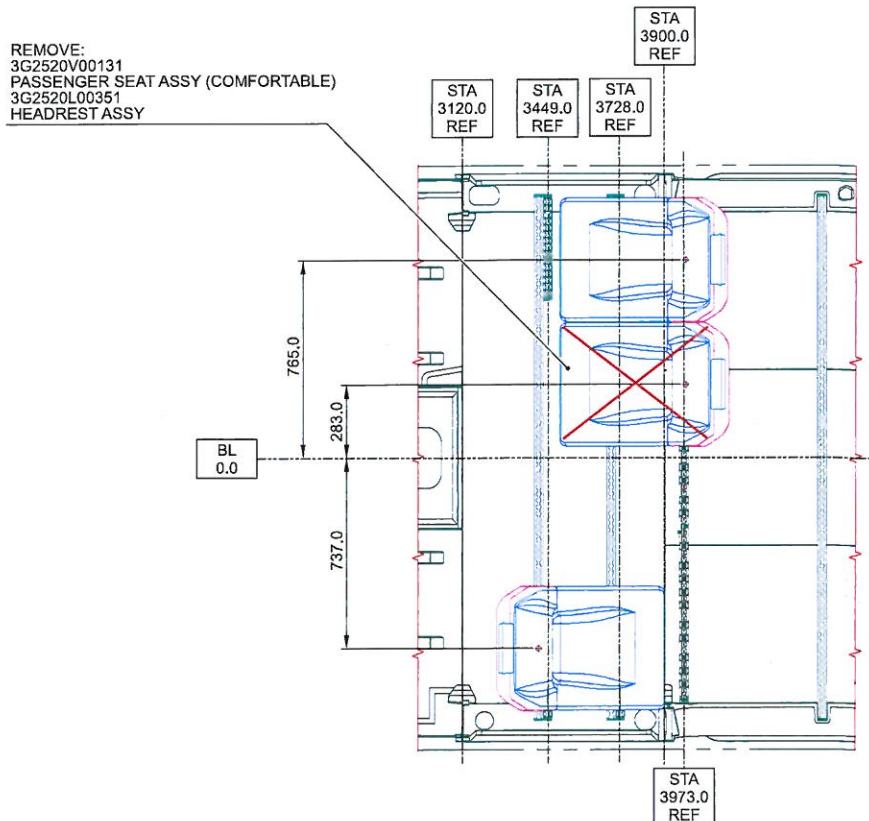

FWD FACING ROW SEATS KIT P/N 3G2520F00611 REMOVAL

CONFIGURATION B

Figure 8

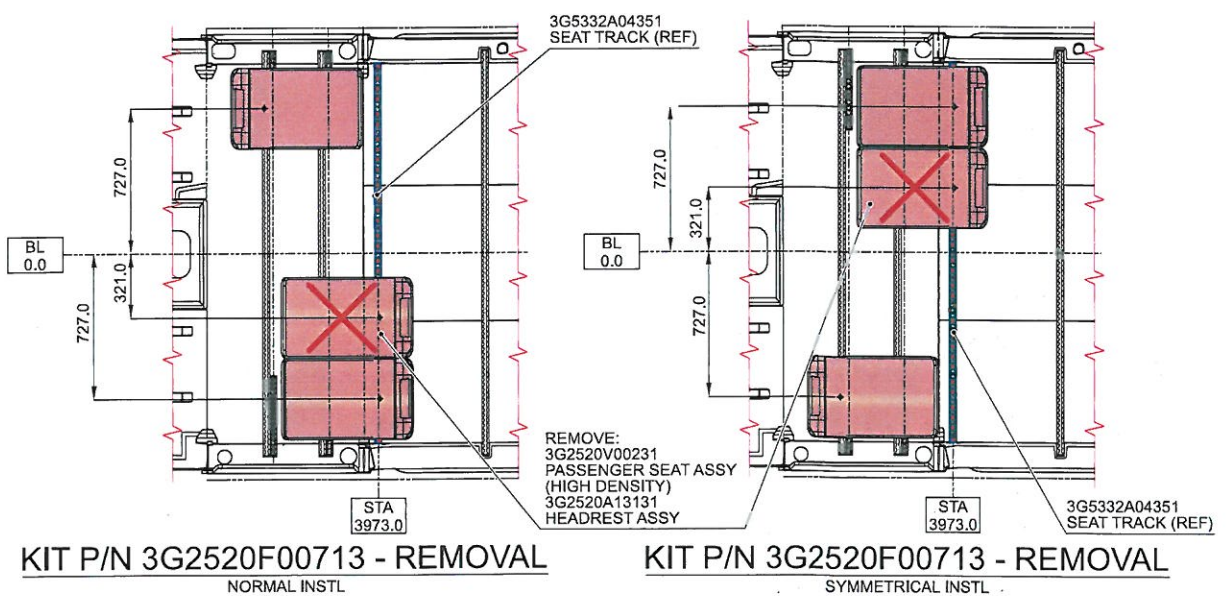
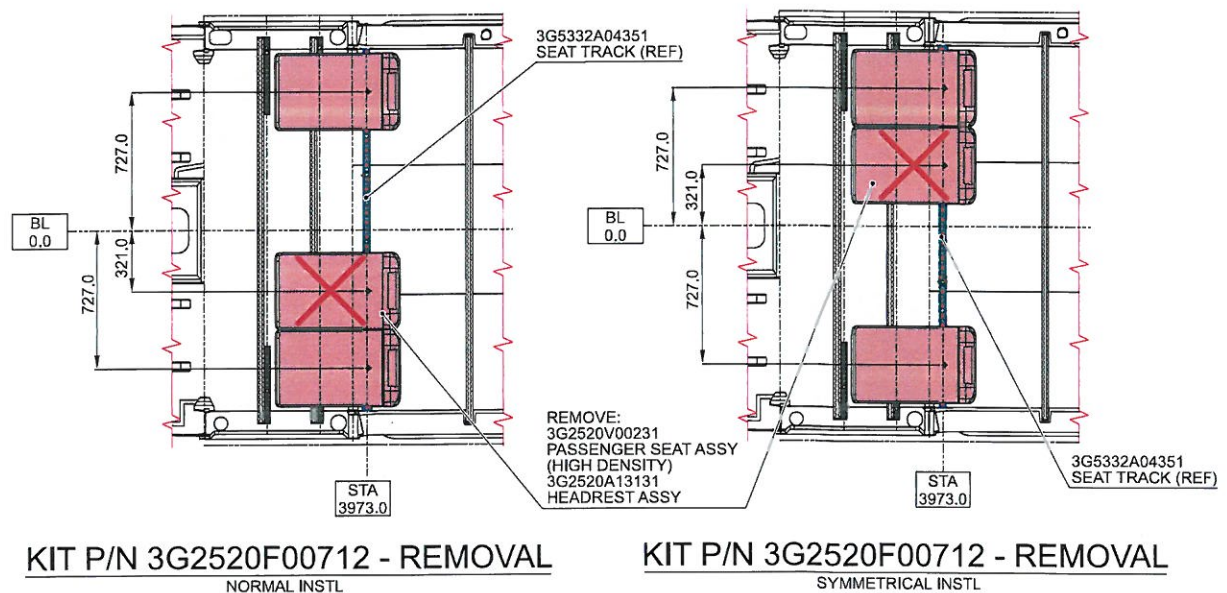
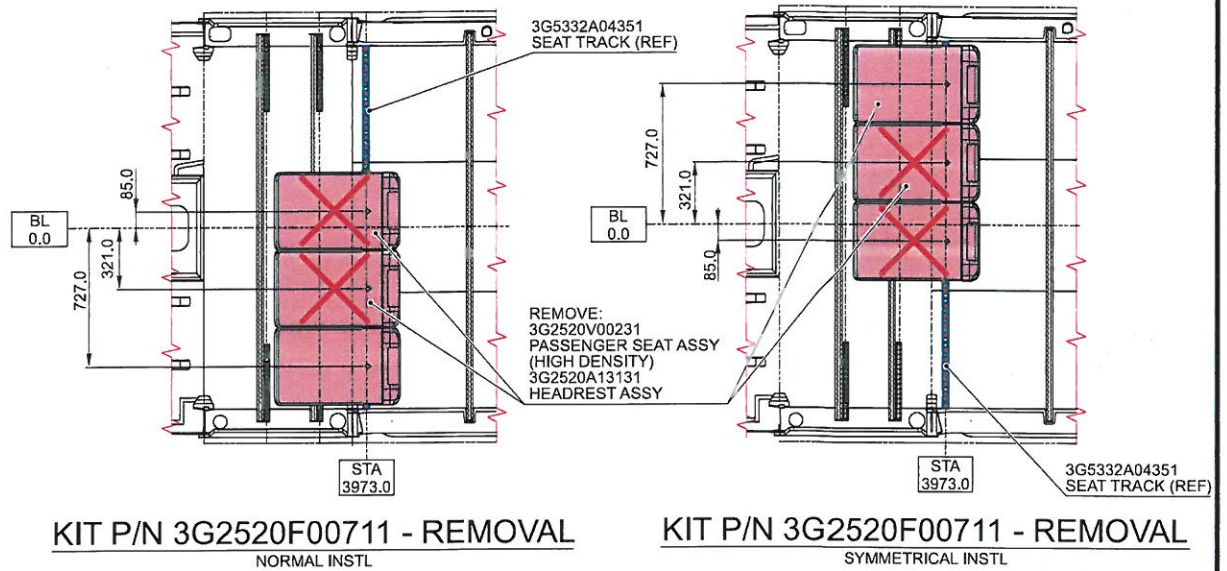
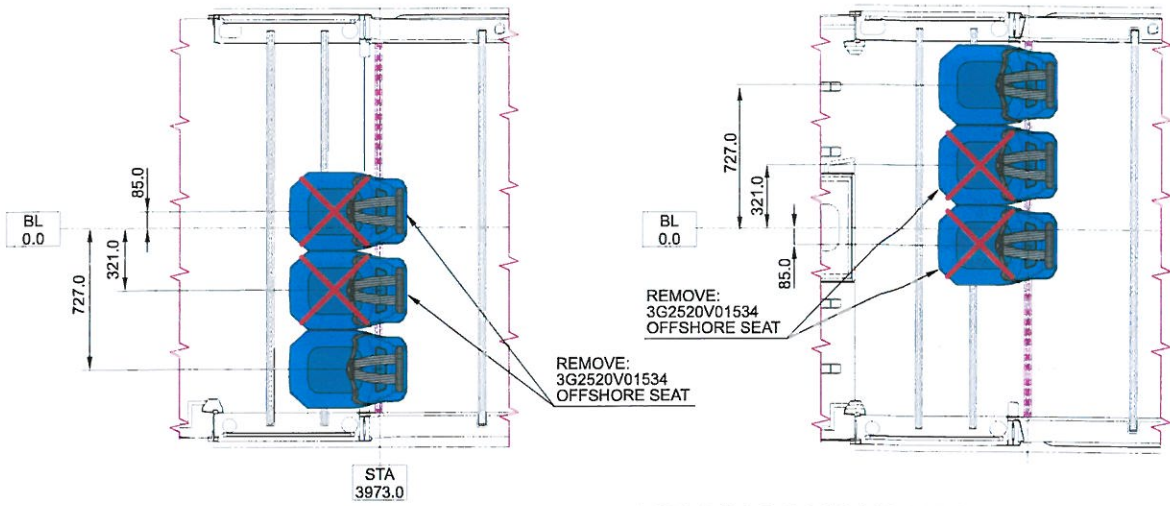
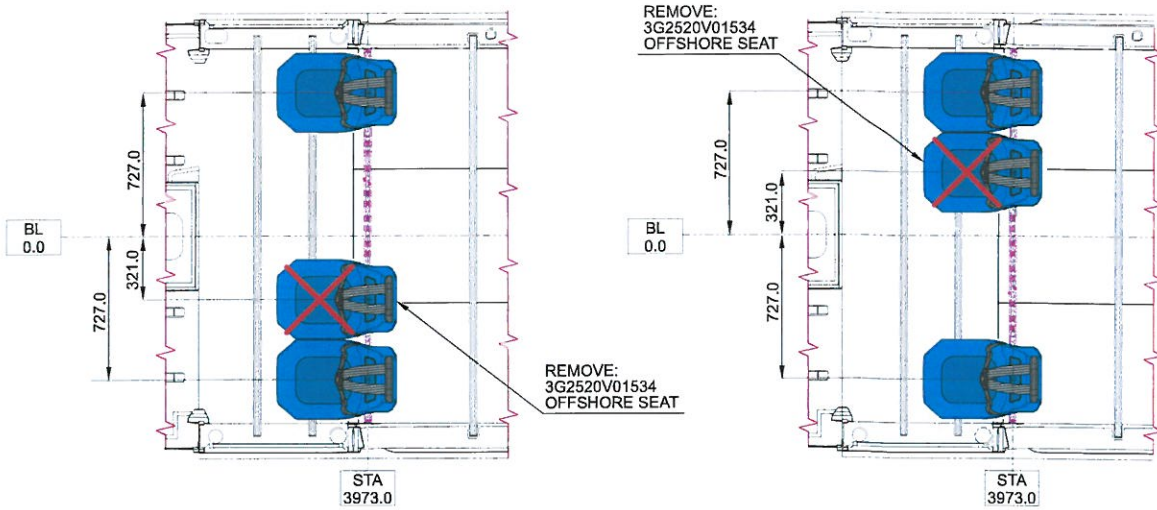

Figure 9



KIT P/N 3G2520F00714 - REMOVAL
NORMAL INSTL

KIT P/N 3G2520F00714 - REMOVAL
SYMMETRICAL INSTL



KIT P/N 3G2520F00715 - REMOVAL
NORMAL INSTL

KIT P/N 3G2520F00715 - REMOVAL
SYMMETRICAL INSTL

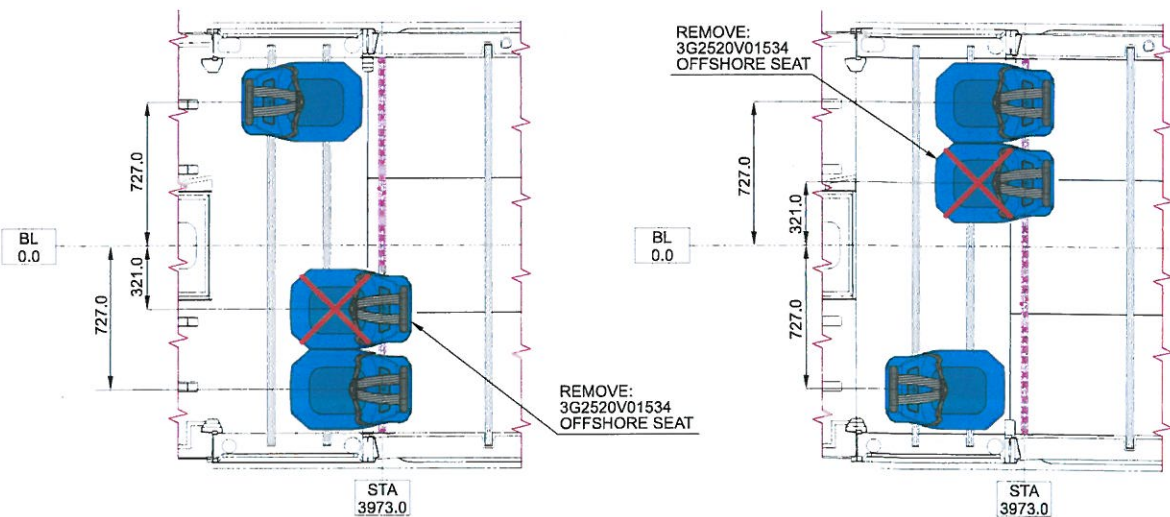

KIT P/N 3G2520F00716 - REMOVAL
NORMAL INSTL

KIT P/N 3G2520F00716 - REMOVAL
SYMMETRICAL INSTL

Figure 10

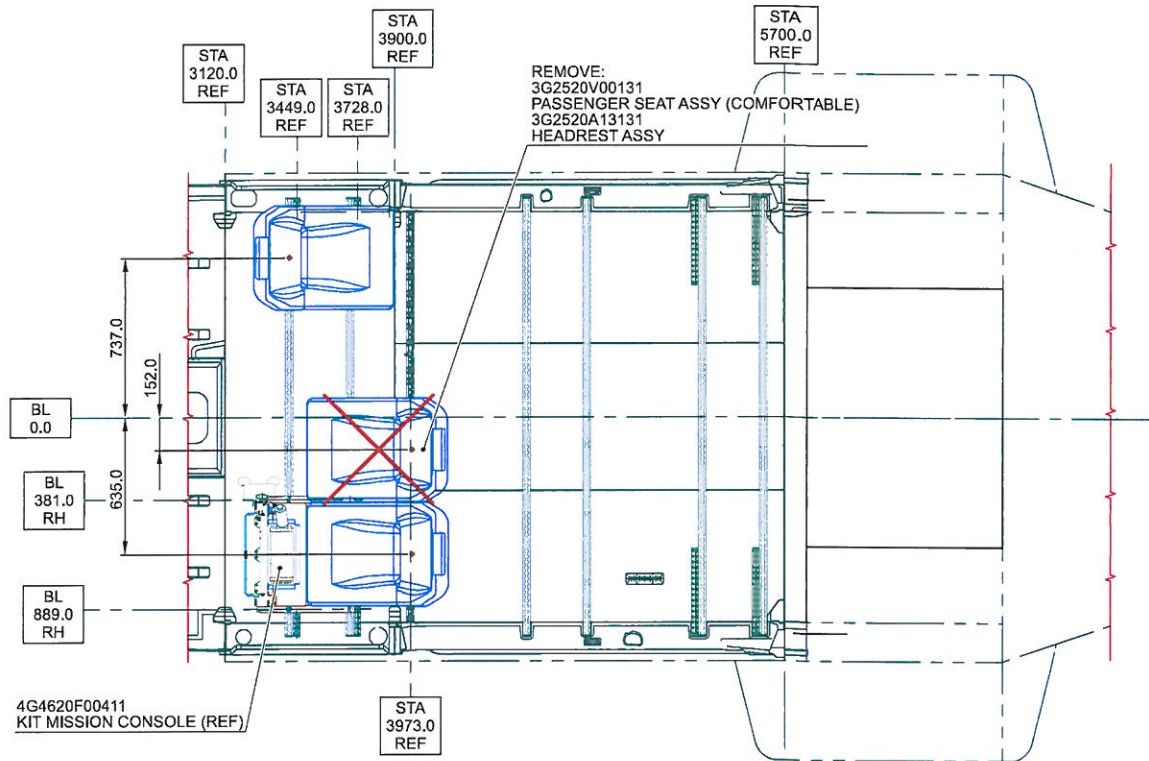

CABIN SEAT KIT P/N 3G2520F00811 - REMOVAL

Figure 11

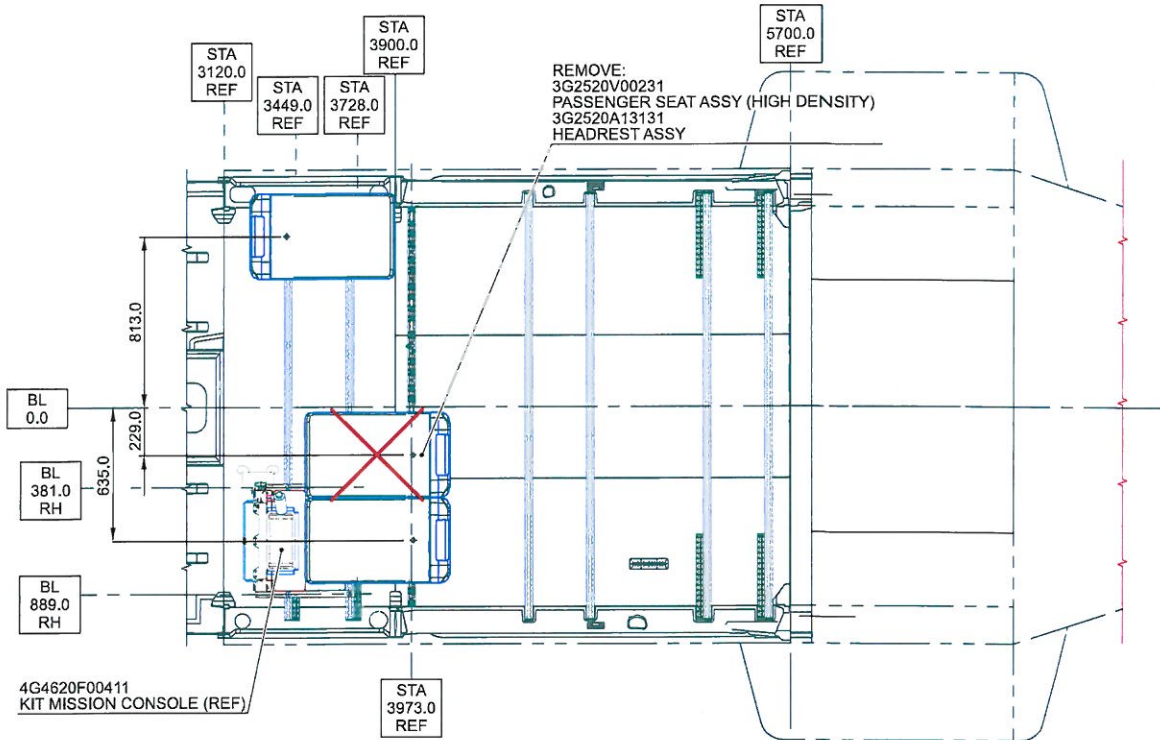

CABIN SEAT KIT P/N 3G2520F00912 - REMOVAL

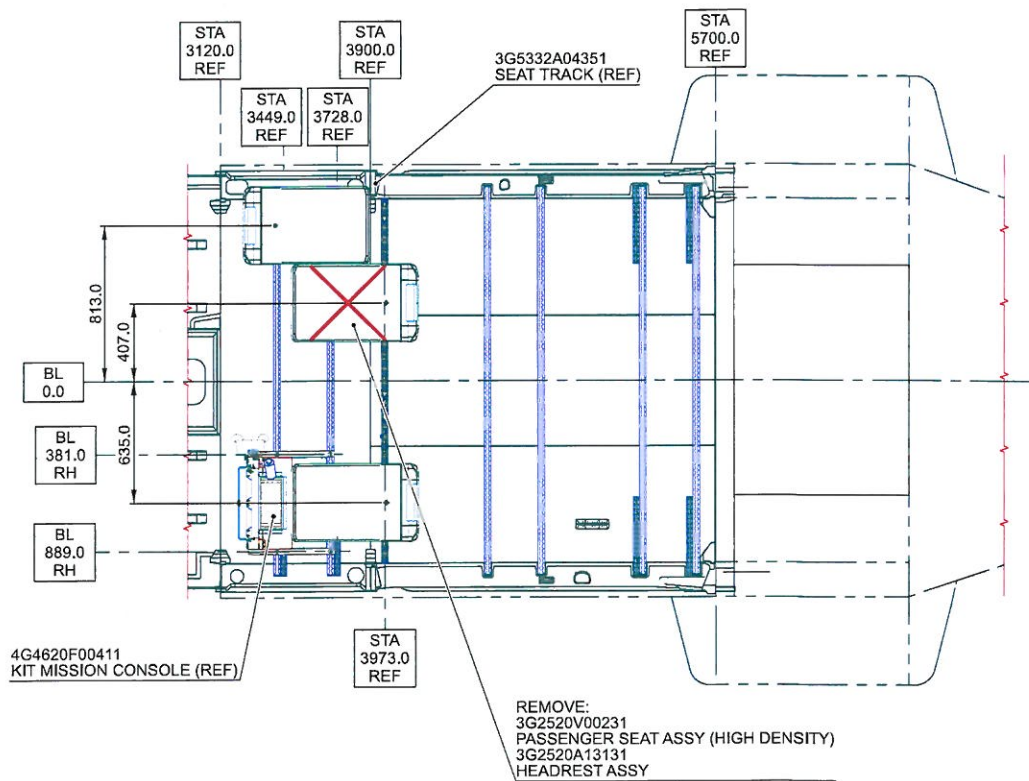

CABIN SEAT KIT P/N 3G2520F00913 - REMOVAL

Figure 12

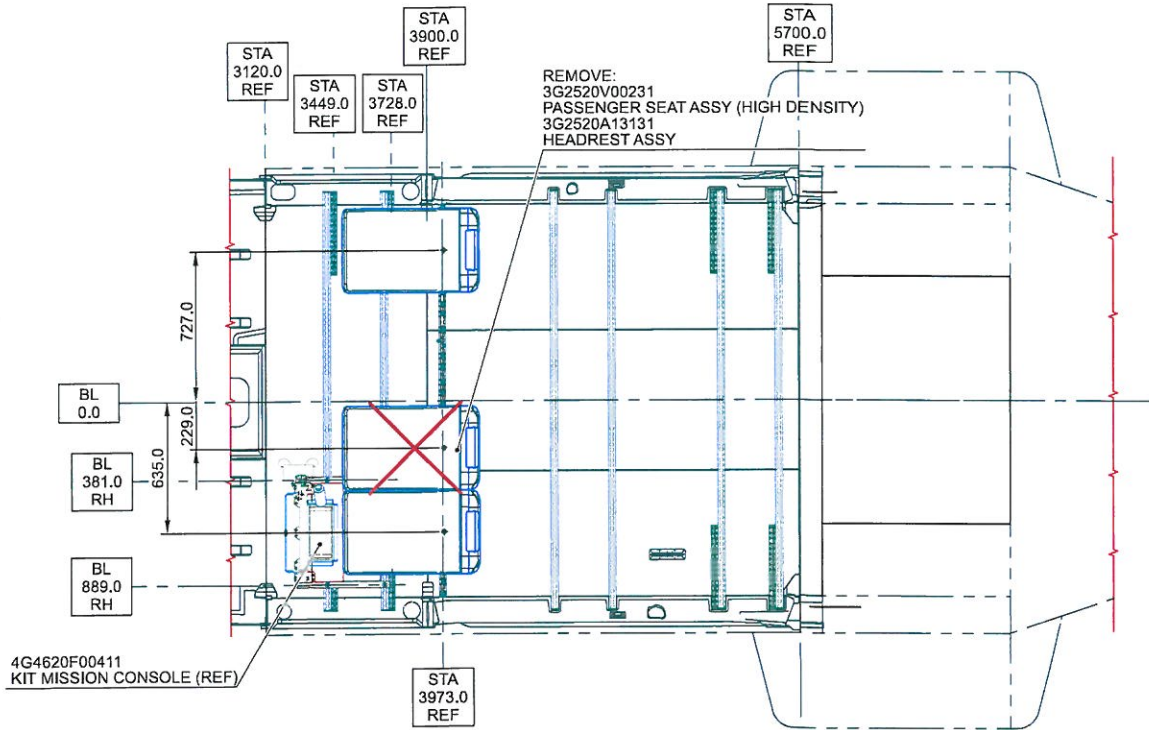

CABIN SEAT KIT P/N 3G2520F00914 - REMOVAL

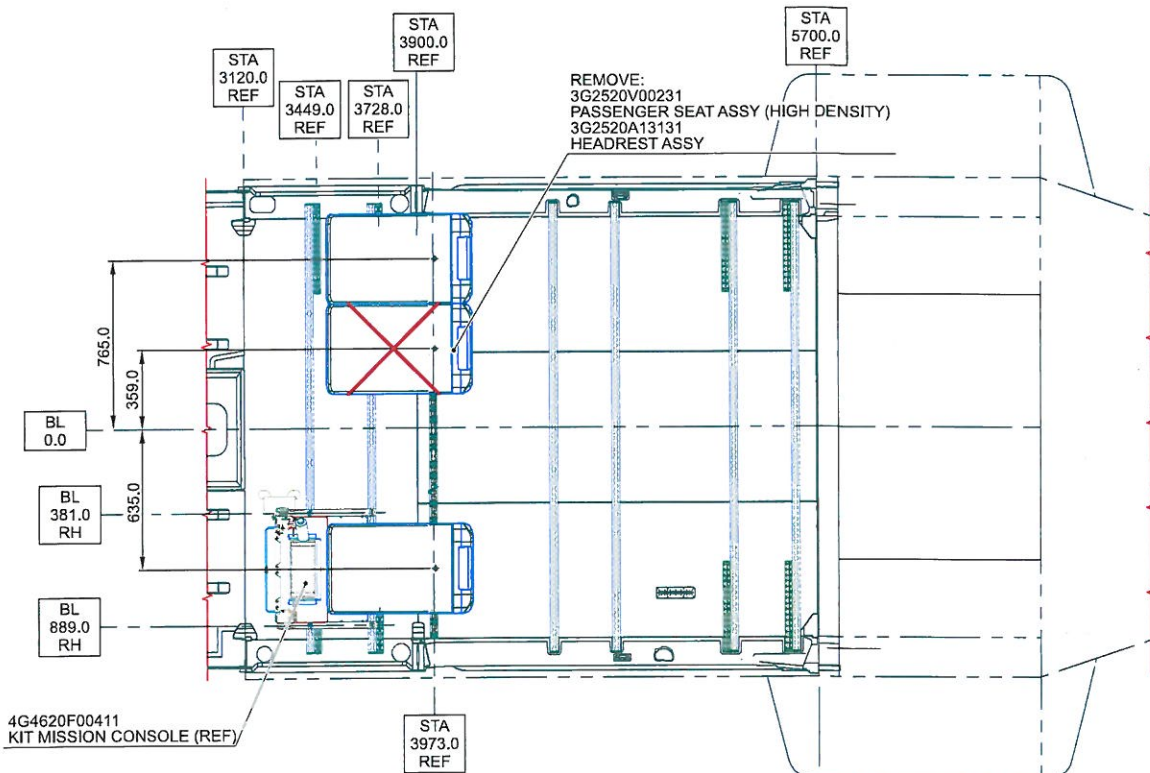

CABIN SEAT KIT P/N 3G2520F00915 - REMOVAL

Figure 13

Please send to the following address: LEONARDO S.p.A. CUSTOMER SUPPORT & SERVICES - ITALY PRODUCT SUPPORT ENGINEERING & LICENSES DEPT. Via Giovanni Agusta, 520 21017 Cascina Costa di Samarate (VA) - ITALY Tel.: +39 0331 225036 Fax: +39 0331 225988	SERVICE BULLETIN COMPLIANCE FORM	Date:
	Number:	
	Revision:	

Customer Name and Address:	Telephone:
	Fax:
	B.T. Compliance Date:

Helicopter Model	S/N	Total Number	Total Hours	T.S.O.

Remarks:

Information:

We request your cooperation in filling this form, in order to keep out statistical data relevant to aircraft configuration up-to-date. The form should be filled in all its parts and sent to the above address or you can communicate the application also via Technical Bulletin Application Communication Section placed in Leonardo AW Customer Portal - MyCommunications Area. We thank you beforehand for the information given.