

| REV | DESCRIPTION | DATE |
|-----|------------------|------------|
| 0 | INITIAL REVISION | 01/12/2021 |

- NOTES:
1. ALL STRUCTURES ARE CLOSED-ENDS AND EACH JOINT TO BE FUSION ARC BUTT/FILLET WELDED PER EN ISO 4063:2009 OR EQUIVALENT.
 2. REMOVE ALL SHARP EDGES AND BURRS.
 3. PERFORM NDT ON ALL WELDED PARTS. NO CRACKS ARE ALLOWED.
 4. EACH CASTOR WHEEL MUST BE ABLE TO WITHSTAND MINIMUM LOAD OF 10 KG.
 5. ASSY/SUB-ASSY TO BE PAINTED YELLOW EXCEPT FOR THREADED PARTS.
 6. USE SUITABLE ADHESIVE TO STICK ITEM (6) ONTO (2).



ISO VIEW OF TRESTLE

| ITEM NO | PART NUMBER | QTY | DESCRIPTION | MATERIAL | SPECIFICATIONS | REMARK |
|---------|--------------|-----|--------------------------------------|----------------------|--------------------------------|--------|
| 1 | ED057001-001 | AR | SQUARE TUBE | LOW-CARBON STEEL | 2" x 2" x 0.083" THICKNESS | 5 |
| 2 | ED057001-002 | AR | RECTANGULAR TUBE | LOW-CARBON STEEL | 2" x 5" x 0.083" THICKNESS | 5 |
| 3 | COMMERCIAL | 2 | CASTOR WHEEL | RUBBER | | |
| 4 | COMMERCIAL | 2 | WASHER | 316 STAINLESS STEEL | 6" O.D. x 1 1/2" W x 1/2" AXLE | |
| 5 | COMMERCIAL | 2 | COUPLER PIN | 316 STAINLESS STEEL | 1.125" O.D. x 0.5" I.D. | |
| 6 | COMMERCIAL | AR | HEAVY SCREWS | RUBBER | 3/8" THICKNESS | 5 |
| 7 | COMMERCIAL | 2 | COUPLER PIN-LOCKABLE HEX HEAD SCREWS | CADMIUM-PLATED STEEL | 3 1/4" LENGTH x 0.5" DIA | 5 |

UNLESS OTHERWISE SPECIFIED:-
 1. DIMENSIONS IN CH
 2. TOLERANCES ON:
 XXX ±.100
 XXX ±.050
 XXX ±.030
 3. REMOVE BURRS AND SHARP EDGES

THIS DOCUMENT IS THE PROPERTY OF GALAXY AEROSPACE. NO COPY HEREIN IS TO BE MADE OR REPRODUCED IN ANY MANNER WITHOUT THE WRITTEN CONSENT OF GALAXY AEROSPACE. OTHER THAN GALAXY AEROSPACE THE DESIGN AND CONTENT THEREOF ARE THE PROPERTY OF GALAXY AEROSPACE. THE TECHNICAL CONTENT OF THIS DOCUMENT IS APPROVED
 1. CLAIM NO. REF. NO. ED057001-001 2. DATA AND REF. NO. LAD2-212301

PREPARED BY: AHMAD DAVYDM OTHMAN
 APPROVED BY: H. MAZAN NAZAR
 DATE: 01/12/2021
 DRAWING NO: ED057001

TITLE: TRESTLE
 A/C TYPE: N/A
 SHEET 1 OF 4

GalaxyAerospace
 GALAXY AEROSPACE (M)
 SDN. BHD.
 ALL RIGHTS RESERVED
 GAME.006 MARCH 2021

1 2 3 4 5 6

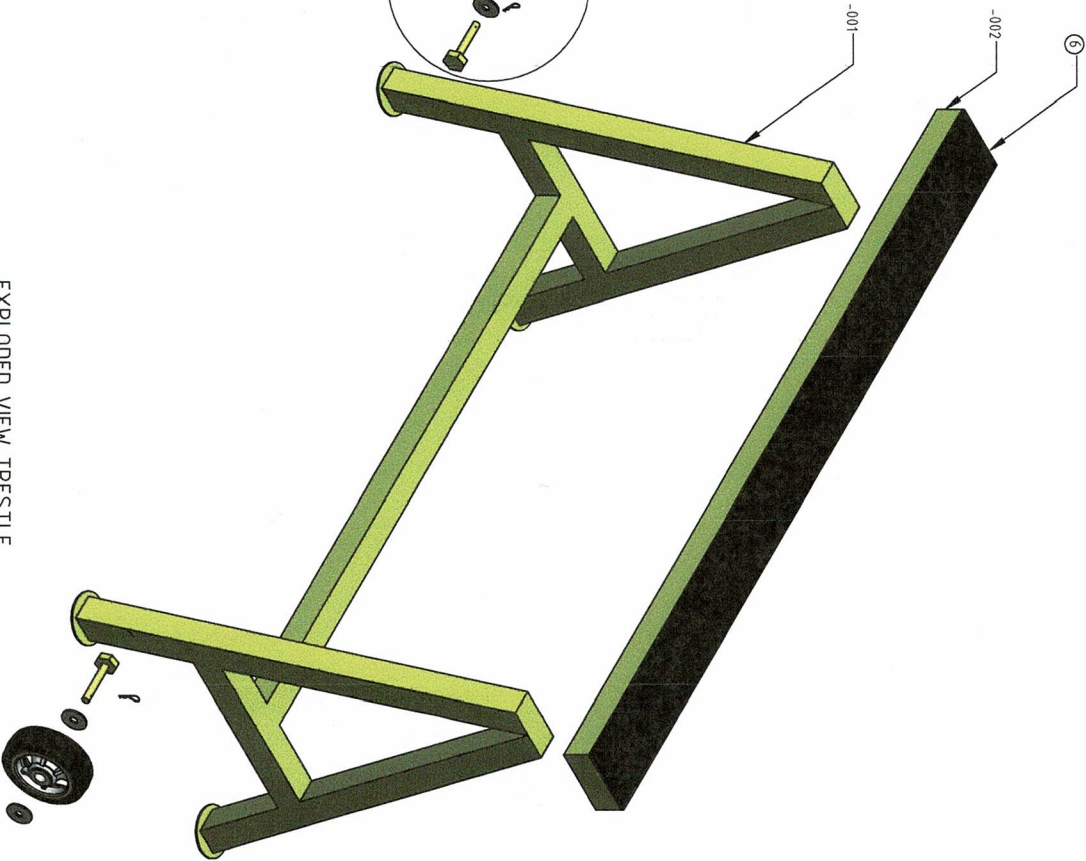
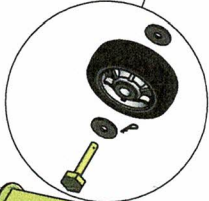
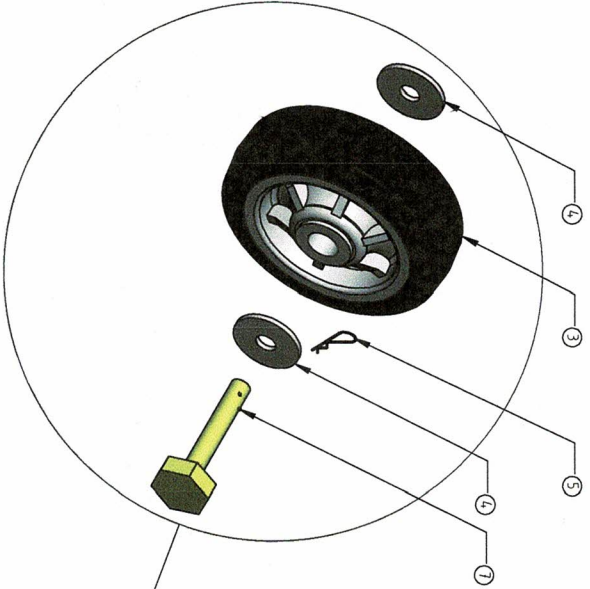

EXPLODED VIEW TRESTLE



GALAXY AEROSPACE (M)
SDN. BHD
ALL RIGHTS RESERVED
GAHF-006 MARCH 2021

THIS DOCUMENT IS THE PROPERTY OF GALAXY AEROSPACE (M) SDN. BHD. AND IS NOT TO BE REPRODUCED OR TRANSMITTED IN ANY FORM OR BY ANY MEANS, ELECTRONIC OR MECHANICAL, INCLUDING PHOTOCOPYING, RECORDING, OR BY ANY INFORMATION STORAGE AND RETRIEVAL SYSTEM, WITHOUT THE WRITTEN CONSENT OF GALAXY AEROSPACE (M) SDN. BHD.
1. CANNOT BE REPRODUCED OR TRANSMITTED IN ANY FORM OR BY ANY MEANS, ELECTRONIC OR MECHANICAL, INCLUDING PHOTOCOPYING, RECORDING, OR BY ANY INFORMATION STORAGE AND RETRIEVAL SYSTEM, WITHOUT THE WRITTEN CONSENT OF GALAXY AEROSPACE (M) SDN. BHD.
2. DATA AND REF. NO. LK03 21/2018
RELATED DOC. (AMENDS)

UNLESS OTHERWISE SPECIFIED:-
1. DIMENSIONS IN CM
2. TOLERANCES ON:
XXX ± 0.50
XXX ± 0.05
XXX ± 0.02
3. REMOVE BURRS AND SHARP EDGES

CONTINUATION SHEET

TITLE
DRAWING NO. E0057001

TRESTLE
A/C TYPE N/A
REV. 0 SCALE: N/A SHEET 2 OF 4 SIZE: A3



THICKNESS 3MM
Ø 9

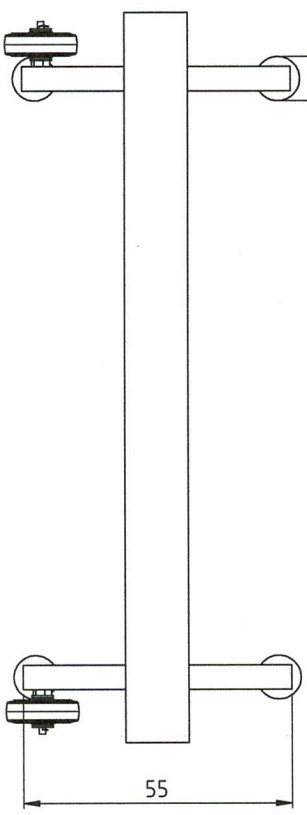

TOP VIEW

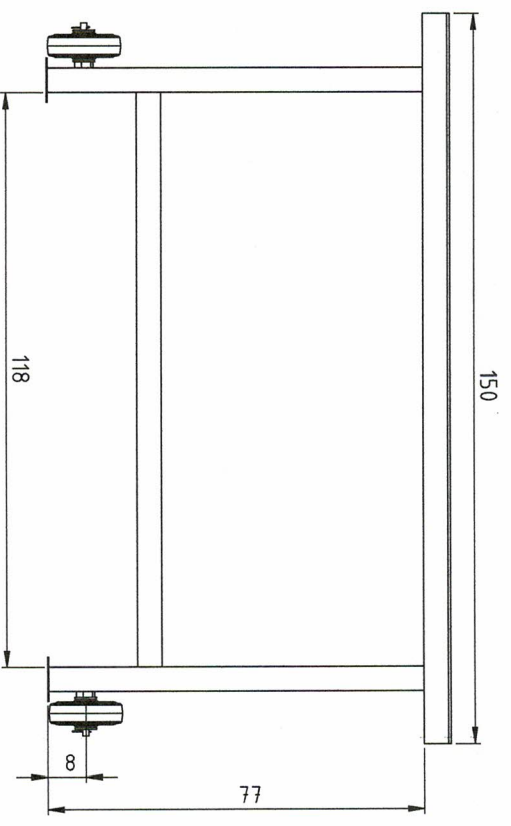

FRONT VIEW

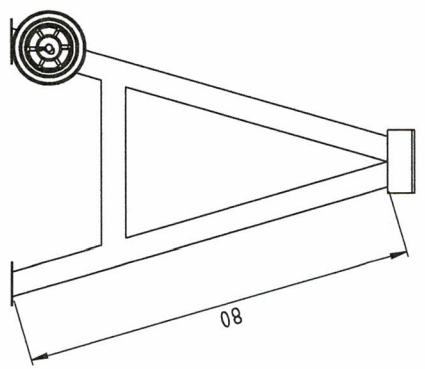

SIDE VIEW



GALAXY AEROSPACE (M)

SN: BMD

ALL RIGHTS RESERVED

GAHF-006 MARCH 2021

THIS DOCUMENT IS THE PROPERTY OF GALAXY AEROSPACE (M) SDN BHD AND IS NOT TO BE REPRODUCED OR TRANSMITTED IN ANY FORM OR BY ANY MEANS, ELECTRONIC OR MECHANICAL, INCLUDING PHOTOCOPYING, RECORDING, OR BY ANY INFORMATION STORAGE AND RETRIEVAL SYSTEM, WITHOUT THE WRITTEN CONSENT OF GALAXY AEROSPACE (M) SDN BHD.

1. CANT. NO. REF. NO. 0001/2021/0001 2. DATA. REF. NO. 1462 21/2021

RELATED PK: 04051010

UNLESS OTHERWISE SPECIFIED:-

1. DIMENSIONS IN CM

2. TOLERANCES ON: ± 0.10

XXX ± 0.50

XXX ± 0.05

3. REMOVE BURRS AND SHARP EDGES

CONTINUATION SHEET

TITLE

TRESTLE

DRAWING NO.

ED057001

A/C TYPE

N/A

REV. 0

SCALE: NTS

SHEET 3 OF 4

SIZE: A3

1

2

3

4

5

6

1

2

3

4

5

6

D

C

B

A

D

C

B

A



1

2

3

4

5

6

A

B

C

D

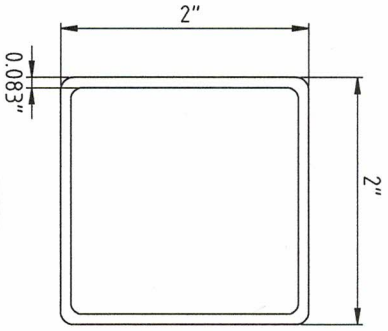

CROSS-SECTIONAL VIEW

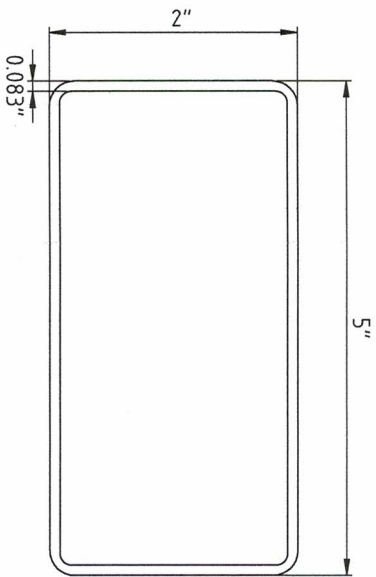

CROSS-SECTIONAL VIEW



GALAXY AEROSPACE (M)

SON, BHD

ALL RIGHTS RESERVED

GAHT-006 MARCH 2021

THIS DOCUMENT IS THE PROPERTY OF GALAXY AEROSPACE IN SON BHD AND IS NOT TO BE REPRODUCED OR TRANSMITTED IN ANY FORM OR BY ANY MEANS, ELECTRONIC OR MECHANICAL, INCLUDING PHOTOCOPYING, RECORDING, OR BY ANY INFORMATION STORAGE AND RETRIEVAL SYSTEM, WITHOUT THE WRITTEN CONSENT OF GALAXY AEROSPACE IN SON BHD.

THE TECHNICAL CONTENT OF THIS DOCUMENT IS APPROVED

1. CAD FILE REF: NO. 0001/20210301 2. DATA FILE REF: NO. 1462 21/23M

RELATED DOC: 00000000

UNLESS OTHERWISE SPECIFIED:-

1 DIMENSIONS IN CM

2 TOLERANCES IN CM

XXX ±.10
XX ±.05
X ±.02
3 REMOVE BURRS AND SHARP EDGES

CONTINUATION SHEET

TITLE

TRESTLE

DRAWING NO.

ED057001

REV. TYPE

REV. 0

SCALE: NIS

N/A

SHEET 4 OF 4

SHEET 4 OF 4

SIZE: A3

SIZE: A3

1

2

3

4

5

6

A

B

C

D